

COBHAM GREEN, WHITNASH

complete ●●●
SALES & LETTINGS





A modern 2 double bedroom end terraced home, with garage, parking, conservatory and good a size rear garden. This AC Lloyd home is in great condition. Located in the popular development just off Tachbrook Road in Whitnash, great for the M40, Jaguar Landrover and the train station.





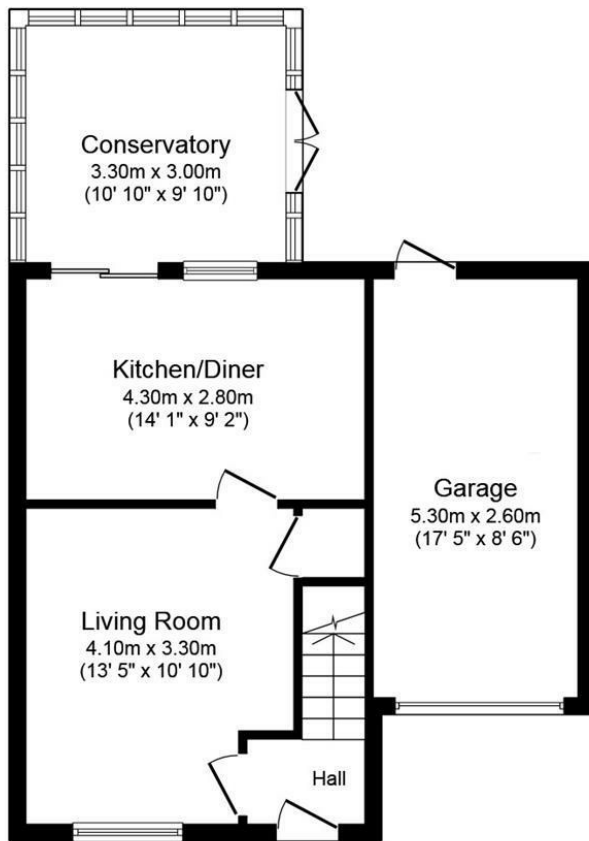

Ground Floor

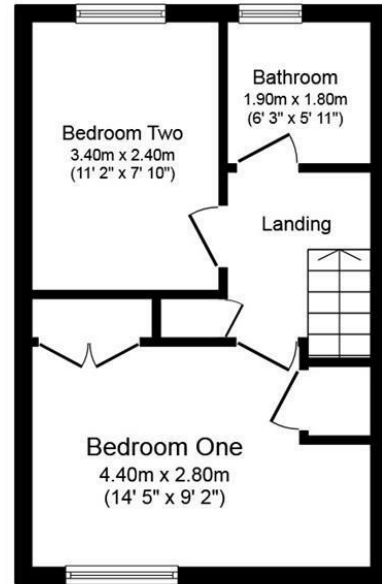

First Floor

Total floor area 84.2 sq.m. (906 sq.ft.) approx

This plan is for illustration purposes only and may not be representative of the property. Plan not to scale. Powered by PropertyBox



- End Terraced House
- Living Room
- Conservatory
- Bathroom
- Garage

- Built by AC Lloyd
- Kitchen/Diner
- 2 Double Bedrooms
- Front & Rear Gardens
- Off Street Parking

COBHAM GREEN, LEAMINGTON SPA

Viewing - Arrangements can be made by Complete Estate Agents on: 01926 887723

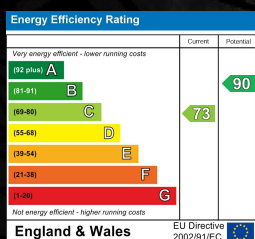

1 Binswood Street, Leamington Spa, Warwickshire, CV32 5RW
 Tel: 01926 887723
sales@complete247.co.uk
www.complete247.co.uk

complete ● ● ●
 SALES & LETTINGS