



Uffington Road, West Norwood, SE27

Kinleigh Folkard & Hayward







**Uffington Road,
West Norwood, SE27**
£800,000
Freehold

Uffington Road is located within close proximity of highly regarded primary and secondary schools as well as the wide selection of cafes, restaurants and shopping amenities in both West Norwood and Streatham Hill.

- Three bedrooms
- Two receptions
- Chain free
- Extension potential STPP
- Corner plot
- 66 ft sunny garden
- Close to schools
- EPC rating D

Offered chain free and set in this exceptionally wide corner plot on a popular residential road in West Norwood is found this attractive period home with enormous extension potential STPP.

For more information or to arrange a viewing please contact:

West Dulwich
113 Rosendale Road
Dulwich, SE21 8EZ
020 8761 0900
westdulwich.sales@kfh.co.uk

Kinleigh Folkard & Hayward

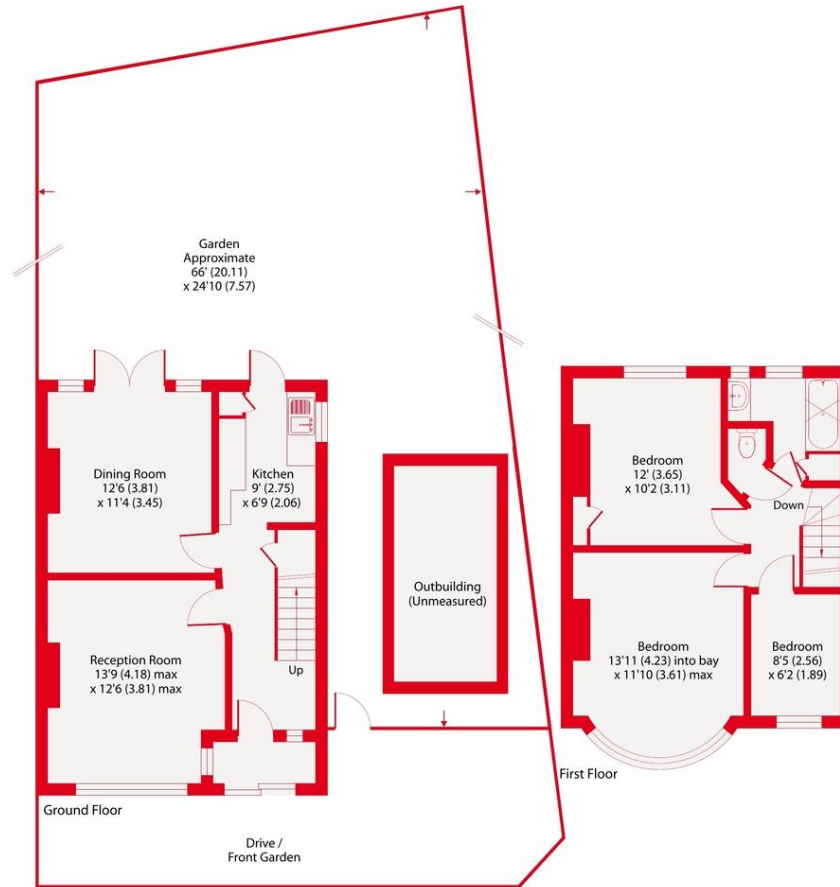

Uffington Road, SE27
 Approximate Area = 950 sq ft / 88.2 sq m
 For identification only - Not to scale

Kinleigh Folkard & Hayward



Floor plan produced in accordance with RICS Property Measurement Standards incorporating International Property Measurement Standards (IPMS2 Residential). © nichecom 2024. Produced for Kinleigh Folkard & Hayward. REF: 1167818

These particulars are believed to be correct but their accuracy is not guaranteed and they do not form part of any contract. Whilst every effort is made to ensure the accuracy of these details, it should be noted that the above measurements are approximate only. Floorplans are for representation purposes only and prepared according to the RICS Code of Measuring Practice by our floorplan provider. Therefore, the layout of doors, windows and rooms are approximate should be regarded as such by any prospective purchaser. Any internal photographs are intended as a guide only and it should not be assumed that any of the furniture/fittings are included in any sale. Where shown, details of lease, ground rent and service charge are provided by the vendor and their accuracy cannot be guaranteed, as the information may not have been verified and further checks should be made either through your solicitor/conveyancer or by referring to the home information pack for this property. Where appliances, including central heating, are mentioned, it cannot be assumed that they are in working order, as they have not been tested. Please also note that wiring, plumbing and drains have not been checked.

