



Front Elevation - 1:50
(North West)

Rear Elevation - 1:50
(South East)



New Build in Cricklade

Pauls Croft, Cricklade, Wiltshire, SN6 6AH

Offers in Excess Of £350,000

m^cfarlane
property.com

New Build High Street Cricklade, Wiltshire

- New Build Detached Home
- Nearing Completion
- Three Beds
- Fitted Kitchen

A New Build Detached House in a sought after Cricklade position. This home is now nearing completion and boasts an envious position close to Cricklade's thriving high street and amenities. Ideally situated between the larger neighbouring towns of Cirencester (9 miles Northwest) & Swindon (10 miles Southeast) and accessed the A419. A summary of the accommodation comprises: Entrance Hallway, Fitted Kitchen/Breakfast, Living Room, Cloakroom. Three Bedrooms and Family Bathroom to the First Floor. Outside Parking for Two Cars and Patio Style Gardens. There is SOLAR PANELS to both front and rear. Viewings by Appointment ONLY through McFarlane Sales & Lettings 36 High Street Cricklade 01793 751 044.





Ground Floor Plan - 1:50

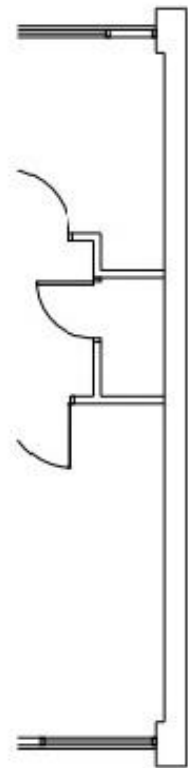

First Floor Plan - 1:50

We 
where you
LIVE

Our team are friendly, experienced and are all local. They know it better than they do their own living rooms and can help you find what you're looking for because **we love where we live.**

We would be delighted to show you around this property.

Because every home needs a personal touch.

If you would like to view this property then please get in touch.

📞 01793 751044

✉ cricklade@mcfarlaneproperty.com

mcfarlaneproperty.com

mcfarlane
property.com

Cricklade.
102 High Street
Cricklade SN6 6AA
📞 01793 751044

Marlborough.
106 High Street
Marlborough SN8 1LT
📞 01672 514380

Old Town.
28-30 Wood Street
Swindon SN1 4AB
📞 01793 296880

Swindon.
The Village Centre,
Redhouse SN25 2FW
📞 01793 296600

Agents Note: Whilst every care has been taken to prepare these sales particulars, they are for guidance purposes only. All measurements are approximate are for general guidance purposes only and whilst every care has been taken to ensure their accuracy, they should not be relied upon and potential buyers are advised to recheck the measurements