



Pauls Croft, Cricklade – SN6 6AL
Swindon

Guide Price **£275,000**
mcfarlane
property.com

Pauls Croft

Cricklade, Swindon

- Semi Detached Bungalow in Cricklade
- Desired Cul-de-Sac Setting
- Two Double Bedrooms
- In Need of Modernisation
- Kitchen with Separate Living Room
- Enclosed Rear Gardens
- No Chain

2 bed semi-detached bungalow in Cricklade. Needs updating Hallway, living room, kitchen, 2 bedrooms, wet room, garden room, garage, mature gardens. Viewings by appointment only through McFarlane.



Pauls Croft

Cricklade, Swindon

Cricklade is a historic former market town in North Wiltshire and Ideally placed for the neighbouring A419. Cricklade is also known as the first town on the Thames and boasts a bustling high street with a variety of amenities. The nationally renowned North Water Meadow is close by with the snake headed fritillaries that bloom annually. This has been classified as a SSSI & NNR (Site of Special Scientific Interest & National Nature reserve).

Council Tax band: B

Tenure: Freehold

mcfarlane
property.com

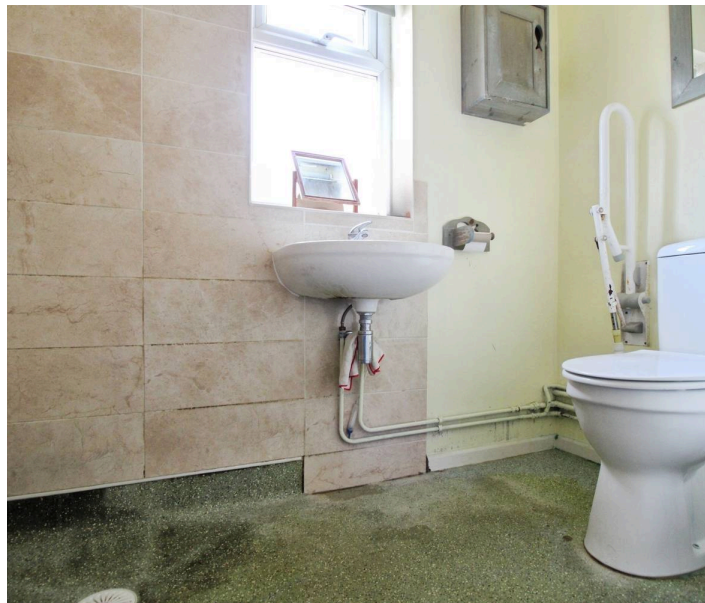

Ground Floor

Approx. 61.6 sq. metres (663.5 sq. feet)

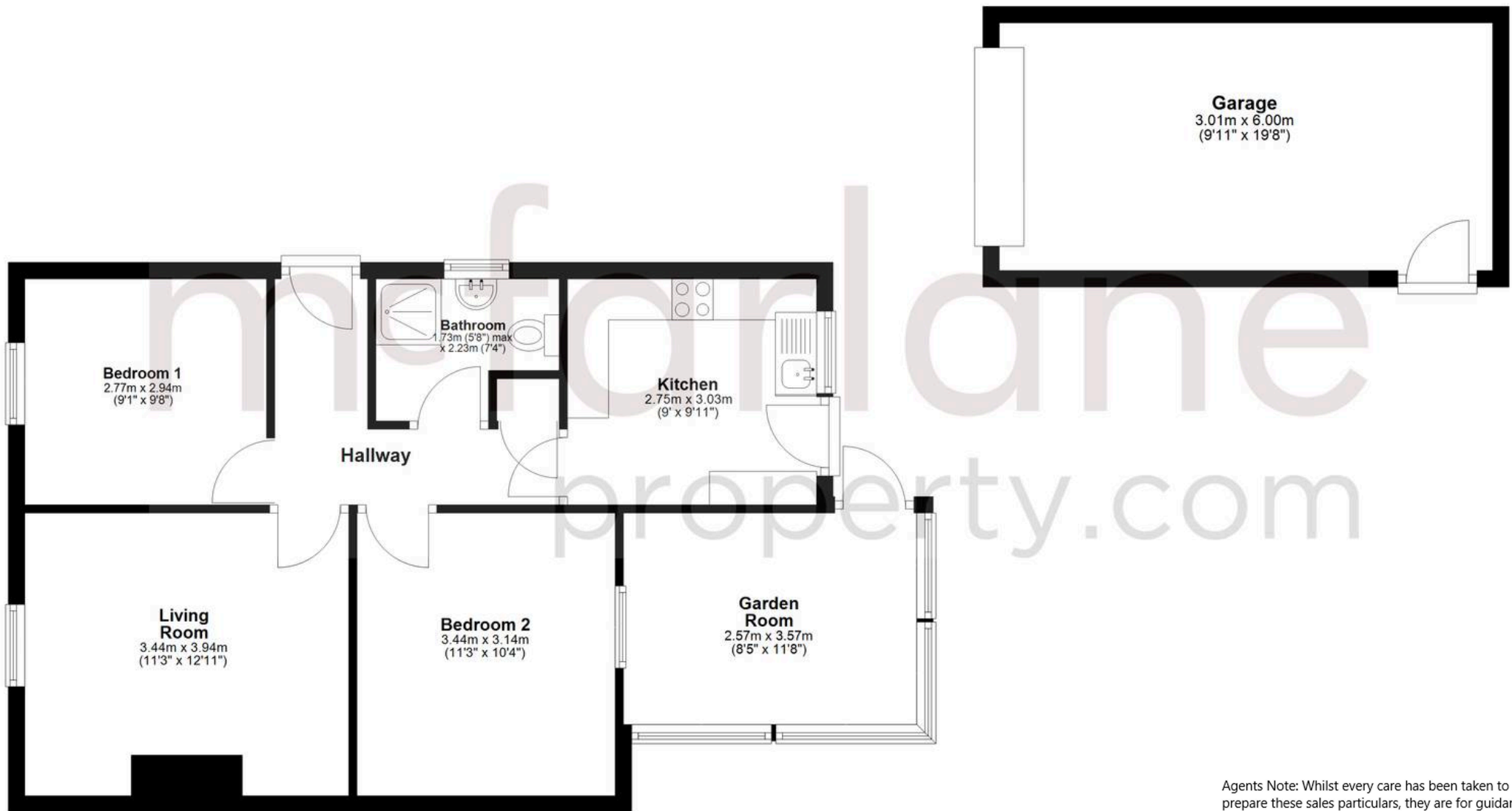

Total area: approx. 61.6 sq. metres (663.5 sq. feet)

Agents Note: Whilst every care has been taken to prepare these sales particulars, they are for guidance purposes only. All measurements are approximate and for general guidance purposes only and whilst every care has been taken to ensure their accuracy, they should not be relied upon and potential buyers are advised to recheck the measurements.