



mcfarlane  
property.com

**Windrush B High Road, Ashton Keynes – SN6 6NX**  
Swindon

In Excess of **£595,000**  
**mcfarlane**  
property.com



# Windrush B High Road

## Ashton Keynes, Swindon

- Generous Plot with Potential
- Generous Gardens plus Garage
- Three Bedroom Stone Built Home
- Modernisation Required
- Sought After Ashton Keynes Position

A Stone Built Three Bedroom home in a much sought after position within the sought after Village of Ashton Keynes. This purpose built property offers...





# Windrush B High Road

Ashton Keynes, Swindon

Council Tax band: TBD

EPC Energy Efficiency Rating: D

EPC Environmental Impact Rating: D



mcfarlane  
property.com

## Ground Floor

Approx. 75.5 sq. metres (812.3 sq. feet)

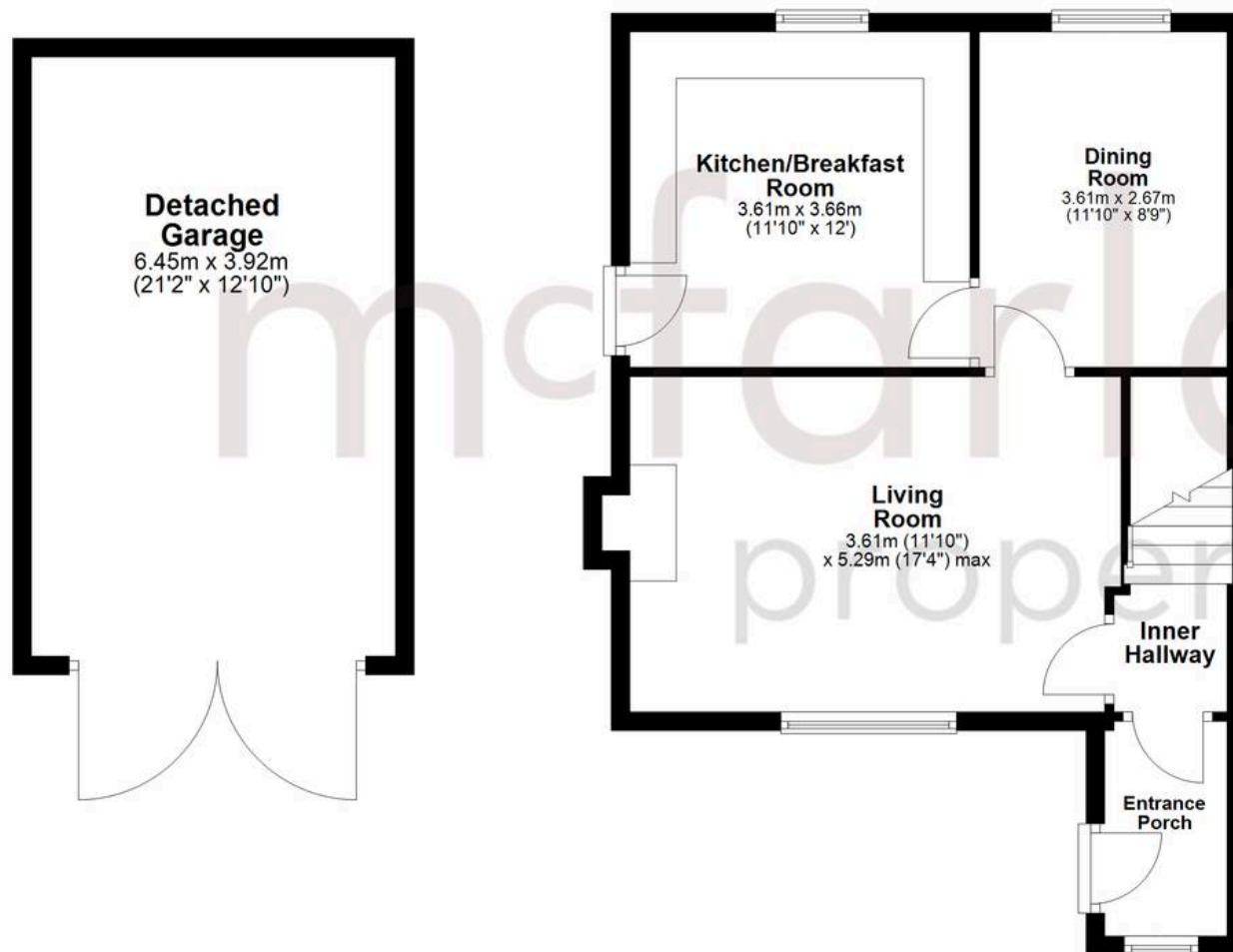

## First Floor

Approx. 47.6 sq. metres (512.0 sq. feet)

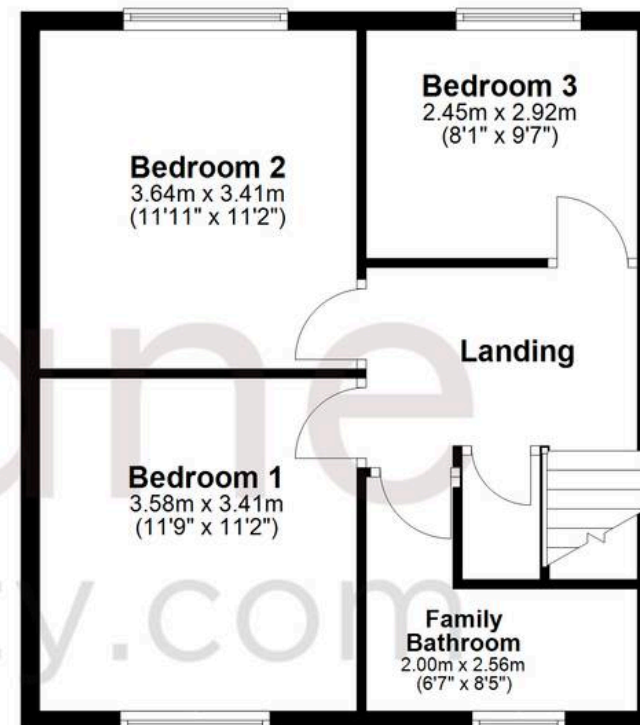

Total area: approx. 123.0 sq. metres (1324.3 sq. feet)

Agents Note: Whilst every care has been taken to prepare these sales particulars, they are for guidance purposes only. All measurements are approximate and for general guidance purposes only and whilst every care has been taken to ensure their accuracy, they should not be relied upon and potential buyers are advised to recheck the measurements.