



Baker Street, Marylebone, NW1

Kinleigh Folkard & Hayward









**Baker Street,  
Marylebone, NW1**  
**£900,000**  
**Leasehold**

The block is located within moments of the University of Westminster and Marylebone High Street.

- Two double bedrooms
- Two bathrooms
- Reception room
- Mezzanine area
- Galley kitchen
- Portered 24-7
- Lift
- EPC rating E

A two bedroom, two bathroom apartment for sale in Chiltern Court, a 1929 built residential block with 24 hour security. Located moments from the delightful green space of Regent's Park.

For more information or to arrange a viewing please contact:

**Marylebone**  
136 Baker Street  
Marylebone, W1U 6FL  
020 7486 5551  
marylebone.sales@kfh.co.uk

**Kinleigh Folkard & Hayward**

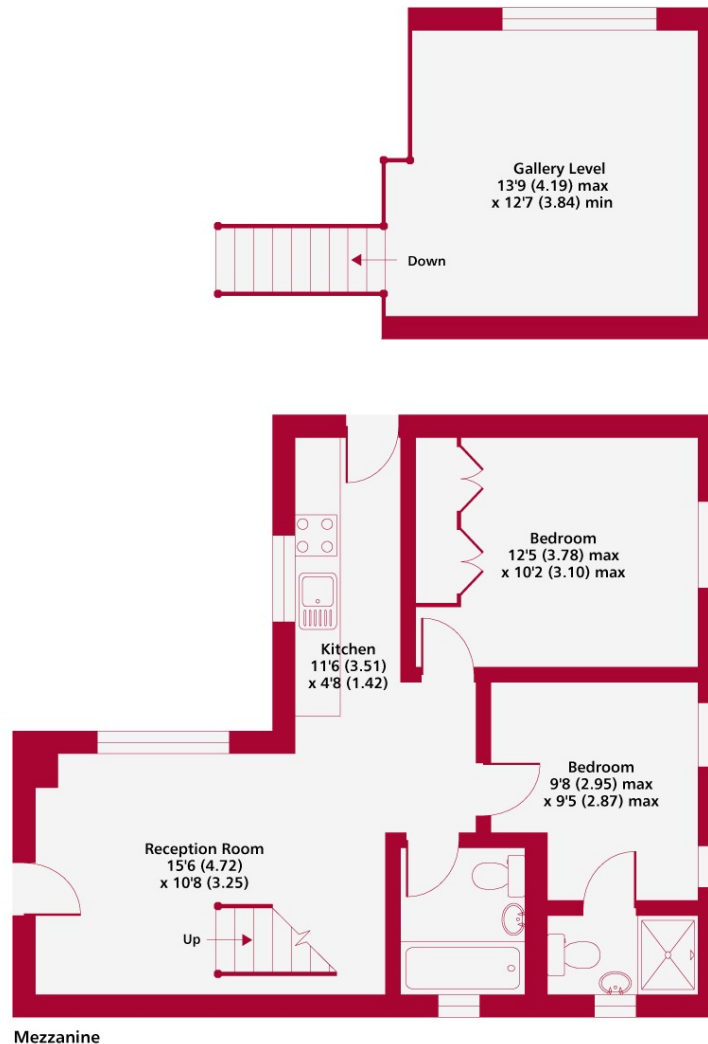

**Baker Street NW1**

**Gross internal floor area 729 sq ft 67.7 sq metres (Includes Mezzanine)**

Copyright nichecom.co.uk 2013 REF : 134031

These particulars are believed to be correct but their accuracy is not guaranteed and they do not form part of any contract. Whilst every effort is made to ensure the accuracy of these details, it should be noted that the above measurements are approximate only. Floorplans are for representation purposes only and prepared according to the RICS Code of Measuring Practice by our floorplan provider. Therefore, the layout of doors, windows and rooms are approximate should be regarded as such by any prospective purchaser. Any internal photographs are intended as a guide only and it should not be assumed that any of the furniture/fittings are included in any sale. Where shown, details of lease, ground rent and service charge are provided by the vendor and their accuracy cannot be guaranteed, as the information may not have been verified and further checks should be made either through your solicitor/conveyancer or by referring to the home information pack for this property. Where appliances, including central heating, are mentioned, it cannot be assumed that they are in working order, as they have not been tested. Please also note that wiring, plumbing and drains have not been checked.

