



# Albisdene Court

Blinco Road, Rushden, NN10 0EA

**£90,000**



1



1



1



D

# Albisdene Court

Blinco Road, Rushden, NN10 0EA



## Description

Prime Choice are delighted to offer this one bedroom purpose built first floor flat. Located in a popular area of Rushden with easy access to Rushden Lakes. The property comprises entrance hallway, lounge, fitted kitchen, bathroom with electric shower over bath, security intercom plus off road parking. Additional benefits include UPVC double glazing and electric heating.

Whole Building shown.

Need more information? For FAQs, information about council tax and local schools, area guides and to join our mailing list, visit our website [www.primechoiceproperties.co.uk](http://www.primechoiceproperties.co.uk).

- Easy Access To Rushden Lakes
- Double Glazed
- 155 Year Lease
- Private Parking
- Electric Heating





## Floor Plan

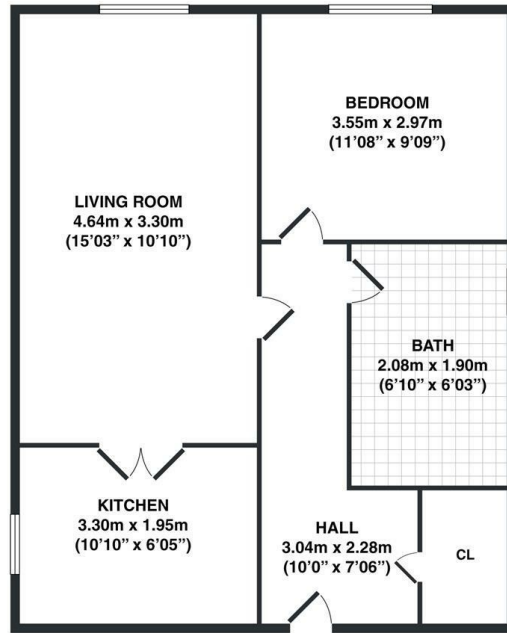

This floor plan is for illustrative purposes and layout guidance only. It is not drawn to scale. Dimensions should not be used for carpet or flooring sizes and are not intended to form part of any contract.

## Area Map



## Energy Efficiency Graph

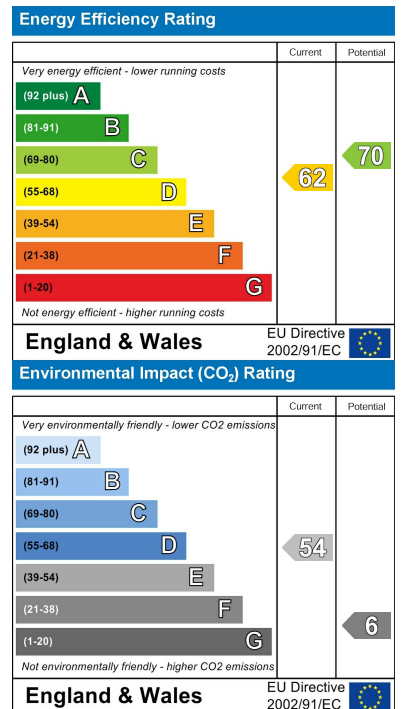

## Viewing

Please contact our Rushden Office on 01933 316 131 if you wish to arrange a viewing appointment for this property or require further information.

These particulars, whilst believed to be accurate are set out as a general outline only for guidance and do not constitute any part of an offer or contract. Intending purchasers should not rely on them as statements of representation of fact, but must satisfy themselves by inspection or otherwise as to their accuracy. No person in this firm's employment has the authority to make or give any representation or warranty in respect of the property.

123 -125 High Street, Rushden, Northamptonshire, NN10 0NZ  
 Tel: 01933 316 131 Email: info.rushden@primechoiceproperties.co.uk  
[www.primechoiceproperties.co.uk](http://www.primechoiceproperties.co.uk)

