



Queen Caroline Street, Hammersmith, W6

Kinleigh Folkard & Hayward











## Queen Caroline Street, Hammersmith, W6

£599,000

Leasehold

Set in a charming period mansion block, the flat itself has a modern feel and well-proportioned rooms.

The property is very well presented and set just moments from the Tube, Broadway Shopping Centre and riverside walks along the Thames Path.

- Two double bedrooms
- Spacious reception
- Large entrance hall
- Separate modern kitchen
- Direct access to roof
- Balcony
- Riverside nearby
- Tube & amenities nearby

A beautifully bright and spacious two bedroom flat located on a quiet street, with direct access to the large flat roof behind. A peaceful and private property with 727 sq ft of living space

For more information or to arrange a viewing please contact:

**Hammersmith**  
180 King Street  
Hammersmith, W6 0RA  
020 8563 9633  
hammersmith.sales@kfh.co.uk

Kinleigh Folkard & Hayward

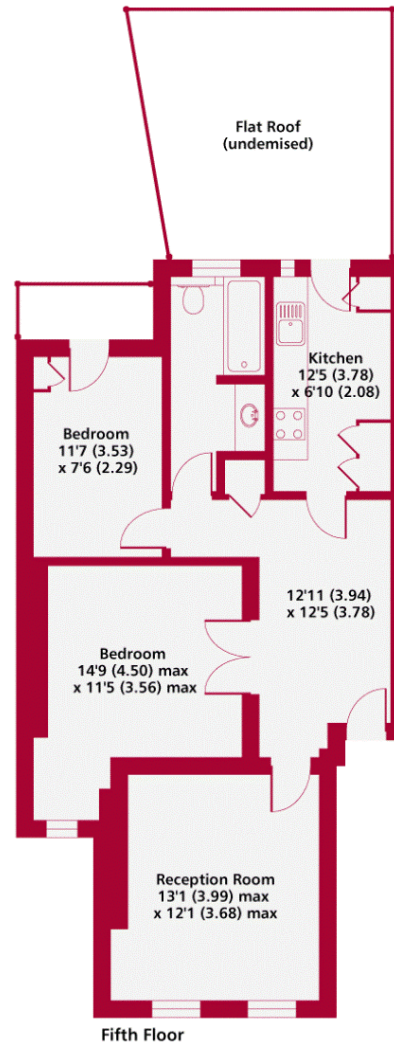

Queen Caroline Street W6  
Gross internal floor area 727 sq ft 68 sq metres

These particulars are believed to be correct but their accuracy is not guaranteed and they do not form part of any contract. Whilst every effort is made to ensure the accuracy of these details, it should be noted that the above measurements are approximate only. Floorplans are for representation purposes only and prepared according to the RICS Code of Measuring Practice by our floorplan provider. Therefore, the layout of doors, windows and rooms are approximate should be regarded as such by any prospective purchaser. Any internal photographs are intended as a guide only and it should not be assumed that any of the furniture/fittings are included in any sale. Where shown, details of lease, ground rent and service charge are provided by the vendor and their accuracy cannot be guaranteed, as the information may not have been verified and further checks should be made either through your solicitor/conveyancer or by referring to the home information pack for this property. Where appliances, including central heating, are mentioned, it cannot be assumed that they are in working order, as they have not been tested. Please also note that wiring, plumbing and drains have not been checked.

