



**Hamlet Gardens, Hammersmith, W6**

**Kinleigh Folkard & Hayward**









## Hamlet Gardens, Hammersmith, W6

£299,950  
Leasehold

Kings Court is ideally located just off King Street, W6 with many excellent restaurants, bars and amenities almost on the doorstep itself.

The beautiful green space of Ravenscourt Park and Tube stations are all just a short walk away.

- One bedroom
- Reception room
- Kitchen
- Bathroom
- Close to Ravenscourt Park
- Close to the tube
- Long extended lease
- EPC rating

---

A spacious one bedroom property on the ground floor of the popular Kings Court. This flat boasts high ceilings is ideally positioned overlooking Hamlet Gardens.

---

For more information or to arrange a viewing please contact:

**Hammersmith**  
180 King Street  
Hammersmith, W6 0RA  
020 8563 9633  
hammersmith.sales@kfh.co.uk

---

Kinleigh Folkard & Hayward



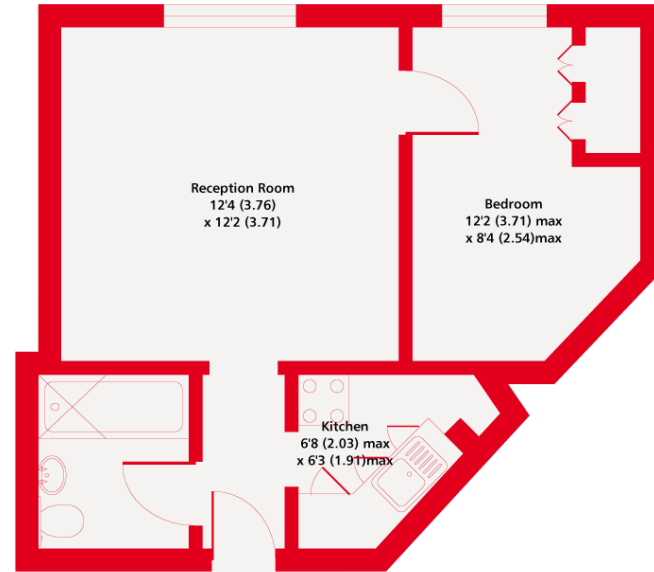

Ground Floor

Kings Court W6  
Gross Internal Floor Area 354 sqft 32.8 sqm  
Copyright nichecom.co.uk 2019 REF : 462188

Kinleigh Folkard & Hayward

Whilst every attempt has been made to ensure the accuracy of the floor plan contained here, measurements of doors, windows and rooms are approximate and no responsibility is taken for any error, omission or misstatement. These plans are for representation purposes only as defined by RICS Code of Measuring Practice and should be used as such by any prospective purchaser. Specifically no guarantee is given on the gross internal floor area of the property if quoted on this plan and any figure given is for initial guidance only and should not be relied on as a basis of valuation.

These particulars are believed to be correct but their accuracy is not guaranteed and they do not form part of any contract. Whilst every effort is made to ensure the accuracy of these details, it should be noted that the above measurements are approximate only. Floorplans are for representation purposes only and prepared according to the RICS Code of Measuring Practice by our floorplan provider. Therefore, the layout of doors, windows and rooms are approximate should be regarded as such by any prospective purchaser. Any internal photographs are intended as a guide only and it should not be assumed that any of the furniture/fittings are included in any sale. Where shown, details of lease, ground rent and service charge are provided by the vendor and their accuracy cannot be guaranteed, as the information may not have been verified and further checks should be made either through your solicitor/conveyancer or by referring to the home information pack for this property. Where appliances, including central heating, are mentioned, it cannot be assumed that they are in working order, as they have not been tested. Please also note that wiring, plumbing and drains have not been checked.

