



48 Lismore Place, Newton Mearns

[www.nicolestateagents.co.uk](http://www.nicolestateagents.co.uk)



Nicol Estate Agents



## Nicol Estate Agents

### Situation

A hugely popular suburb, Newton Mearns is a welcoming, family friendly town, with a fantastic, lively and inclusive community. If you choose to live in Newton Mearns, you will have access to some of Scotland's highest attaining primary and secondary schools.

Newton Mearns is located approximately 9 miles from Glasgow City Centre. Commuter routes are served by the M77, M8 and Glasgow Orbital motorways which also provide 30 minute journey times to both Glasgow and Prestwick international airports. There are regular train and bus services to Glasgow, East Kilbride and the beautiful Ayrshire coast.

Recognised as providing amongst the highest standards of local amenities, Newton Mearns offers an array of healthcare centres, banks and libraries and a broad range of supermarkets, boutique shops and restaurants, including The Avenue Shopping Centre and The Greenlaw Retail Park includes Waitrose and Tesco Metro.

Local sports and recreational facilities include David Lloyd Rouken Glen, Parklands Country Club, Cathcart, Williamwood and Whitecraigs Golf Clubs, a number of private bowling clubs and Whitecraigs tennis club. East Renfrewshire Council's own excellent sports and leisure facilities at Eastwood Toll. If you are an outdoors lover, Rouken Glen Park, voted Best Park in the UK 2016, is nearby with walking trails through the woods, a great adventure play area, a skate park, five a side football pitches and a boating pond.









## Description

A well presented four bedroom detached villa, extremely well located for amenities within the surrounding district and located in a peaceful cul de sac setting.

Internally the property provides flexible accommodation formed over two levels, well designed for family living.

The accommodation comprises:

Ground Floor: Entrance hallway. Spacious and dual aspect presented sitting/ dining room with bay window to front and patio doors leading the rear patio and garden. The kitchen is on an open plan arrangement to the sitting/ dining room. Well appointed kitchen equipped with a full complement of floor and wall mounted cabinets and complementary worktops. Family room with large cupboard space previously the single integral garage.

First Floor: Bedroom one with an ensuite shower room and fitted wardrobes. Three further bedrooms. House family bathroom with three piece suite and shower over bath.

The property is further complemented by gas central heating and double glazing. Well tended, enclosed rear garden, providing privacy and shelter. The driveway provides off street parking.









Nicol Estate Agents



48 Lismore Place, Newton Mearns, G77 6UQ

Approximate gross internal area 1,109 sq ft - 103 sq m

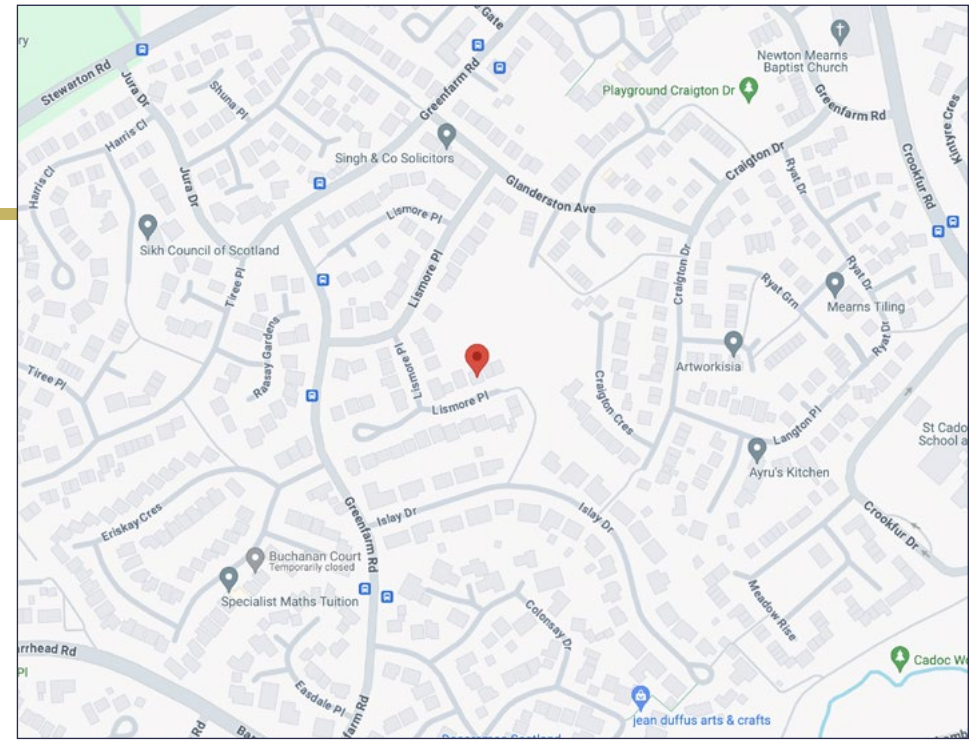

Ground Floor

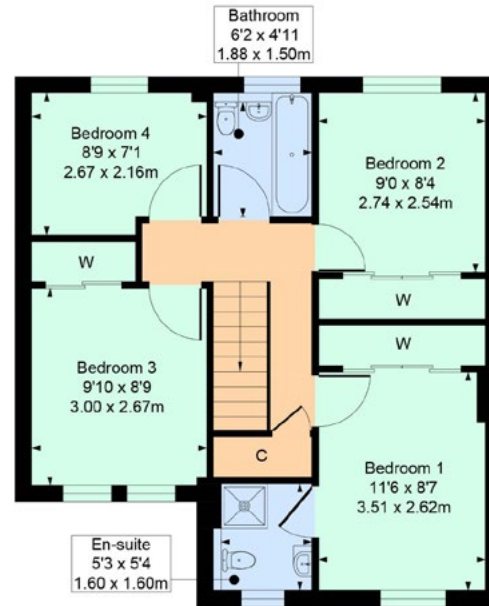

First Floor

### Viewing

By appointment through  
Nicol Estate Agents  
46 Ayr Road  
Newton Mearns, Glasgow G46 6SA  
Telephone 0141 616 3960  
mail@nicolestateagents.co.uk

### Outgoings

East Renfrewshire Council  
Band F

### Fixtures and Fittings

Only items specifically mentioned in the sale particulars are included in the sale price.

### Energy Efficiency Rating

Band C

### Services

The property will be supplied by mains water, gas and electricity. Gas central heating.

### Local Authority

East Renfrewshire Council  
Council headquarters  
Eastwood Park, Rouken Glen Road  
Giffnock G46 6UG  
Tel: (0141) 577 3000

### Property Reference 3140

#### SKETCH PLAN FOR ILLUSTRATIVE PURPOSES ONLY

All measurements, walls, doors, windows, fitting and appliances, their sizes and locations are approximate only. They cannot be regarded as being a representation by the seller, nor their agent, produced by Potterplans Ltd. 2024

We believe these details to be accurate however it is not guaranteed and they do not form any part of a contract. Fixtures and fittings are not included unless specified in the enclosed. Photographs are for general information and it must not be inferred that any item is included for sale with the property. All distances and measurements are approximate. Floorplans may not be to scale and are for illustration purposes only.

46 Ayr Road, Newton Mearns, Glasgow G46 6SA

T: 0141 616 3960 F: 0141 258 2761 E: mail@nicolestateagents.co.uk

www.nicolestateagents.co.uk

