

Scott Road, Oxford



2 Bedrooms



1 Bathroom



1 Reception

£475,000



Description

Well situated on the borders between Cutteslowe and Summertown, this house is a charming two-bedroom property that offers a blend of period features and modern comforts.

On the ground floor, you are greeted by a spacious entrance hall, leading into a large sitting room, where a log-burning stove serves as a characterful centrepiece. This room opens up to a well-appointed kitchen through double doors.

The kitchen offers direct access to a lovely private garden, featuring an extensive patio area perfect for outdoor dining and relaxation.

The upper floor houses two generously sized bedrooms, with the master bedroom being particularly large. Many homes in the area have converted this space into a smaller double and a single bedroom, to make it into a three-bedroom house.

The property also boasts a sizeable front garden, off-road parking with a large driveway, and a very useful storage shed in the rear garden.

With its superb location and extensive garden, this is a perfect home in the heart of Oxford.



- Log Burning Oven in Sitting Room
- Private Garden
- Extensive Patio
- Off-Road Parking
- Potential to Convert into 3-Bedroom House



Additional Information

EPC

The current EPC rating for this property is D. Please contact us if you require a copy of the full EPC.

Council Tax

The Property is in council tax band C.

Viewings

Viewings on this property are strictly through Alistair Redhouse Property Partners.

Handling Agent

Alistair Redhouse is the Property Partner looking after the sale of this property and he is working closely with the seller to ensure that they are the best person to answer your questions and to discuss your interest. You can contact Alistair directly on the details on the next page and he will be happy to help.

Opening Hours

The offices of Alistair Redhouse are open 09.00-18.00 Monday to Friday and Saturday 09.00-17.00.

Floorplan

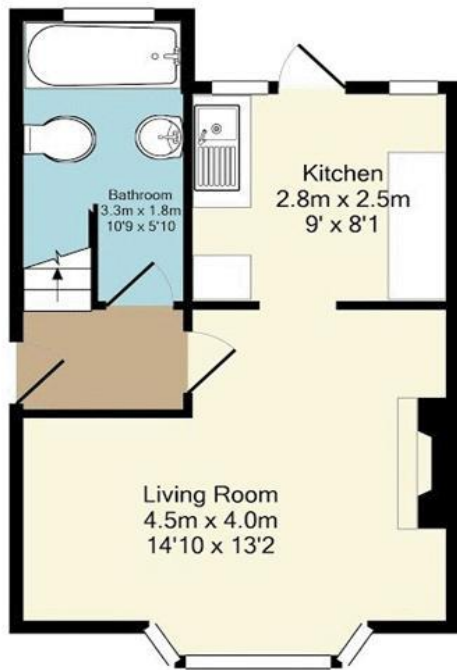

Ground Floor
Approx. Floor
Area 29.8 Sq.M.
(321 Sq.Ft.)

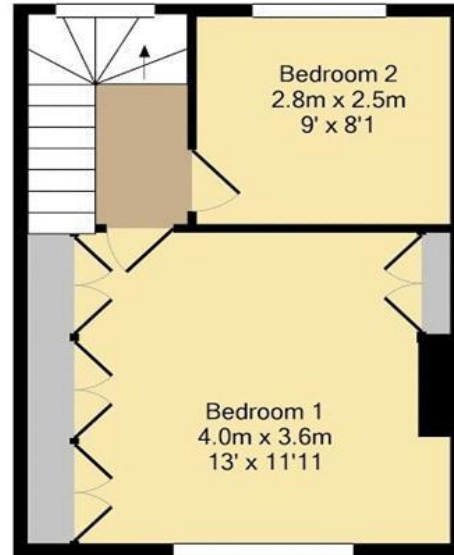

1st Floor
Approx. Floor
Area 27.1 Sq.M.
(292 Sq.Ft.)

Total Approx. Floor Area 57.0 Sq.M. (613 Sq.Ft.)

Measurements are approximate. Not to scale. Illustrative purposes only. Produced by
wideangles.co.uk
Made with Metropix ©2016

Alistair Redhouse

Direct Dial: 01865 593301

Alistair.Redhouse@ARPropertyPartners.co.uk



Whilst all statements contained in this brochure are believed to be correct, they are not to be regarded as statements or representations of fact and neither the selling agents nor sellers guarantee their accuracy.

The artist's impressions, photos, floor plans and other information are intended as a general guide only to the appearance and layout of the property.

However, it may be necessary, and rights are reserved to make changes to the appearance, layout and specification at any time without formal notice. Dimensions are approximate. This brochure and statements contained therein do not form any part of an offer or contract.