



SALES

LETTINGS

MANAGEMENT

chiswick@tatepartnership.co.uk

020 8996 0000

TATEPARTNERSHIP.CO.UK



Stamford Court W6

£2,250 pcm

***** Rent Includes Hot Water & Background Heating*****

Newly decorated and refitted, a generous two bedroom 5th floor (lift) purpose built apartment, with elevated position giving a bright outlook. Located just moments from Stamford Brook station. The accommodation is looking great. A comfortable 676 sq/ft (62.8 m2) of newly refitted/redecorated living space, comprising; entrance hall, dual aspect living room, separate kitchen, two fitted bedrooms and modern refitted bathroom. Lift, onsite building manager and off street parking for residents (FCFS). The rent includes background heating & hot water. Stamford Court is situated on Goldhawk Road just along from Stamford Brook station (zone 2). Chiswick High Road and King Street are a few minutes walk. EPC rated C. Available now, furnished/unfurnished (optional).

Stamford Court W6

Floor Plan

Approximate gross internal area
63 sq m / 676 sq ft

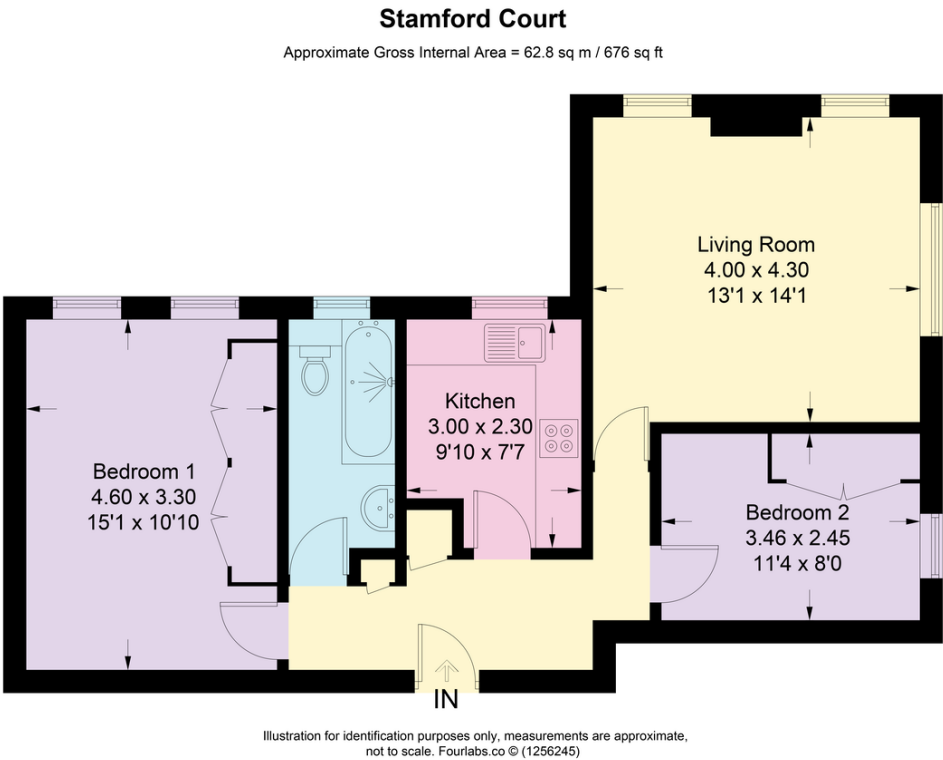

EPC

Score	Energy rating	Current	Potential
92+	A		
81-91	B		
69-80	C	69 C	77 C
55-68	D		
39-54	E		
21-38	F		
1-20	G		