



SALES

LETTINGS

MANAGEMENT

chiswick@tatepartnership.co.uk

020 8996 0000

TATEPARTNERSHIP.CO.UK



Chiswick High Road, W4

£1,625 pcm

****Patio Garden****

A delightful ground floor open plan Studio Apartment with the benefit of a raised Patio Garden. Great central Chiswick Location. Recently decorated, the accommodation is an open plan self-contained Studio Apartment, with separate Kitchenette and Shower Room. Outside is a delightful raised patio garden, large enough for dining. This Location is ideal for central shopping, eating out and transport, with Turnham Green Station just a few minutes walk. Council Tax Band C. Available Now, Unfurnished.

Chiswick High Road

Approximate Gross Internal Area = 33.9 sq m / 365 sq ft

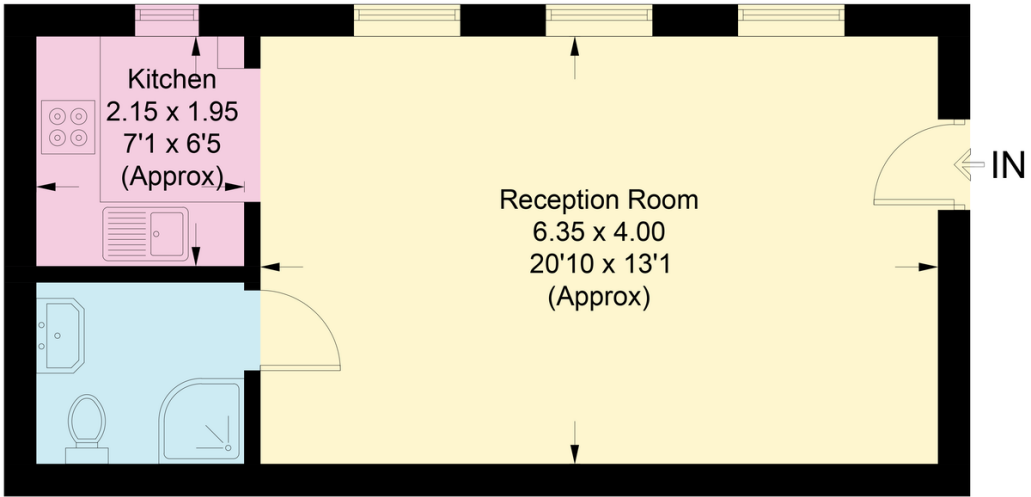

Illustration for identification purposes only, measurements are approximate, not to scale. floorplansUsketch.com © (ID992581)

EPC

