



**SALES**

**LETTINGS**

**MANAGEMENT**

[chiswick@tatepartnership.co.uk](mailto:chiswick@tatepartnership.co.uk)

**020 8996 0000**

**TATEPARTNERSHIP.CO.UK**



**Kings Court, Hammersmith**

**£1,600 pcm**

**\*\*\*RENT INCLUDES HOT WATER & BACKGROUND HEATING\*\*\***

Kings Court is a popular Mansion Block conveniently located on King Street & Hamlet Gardens. This apartment is on the 5th Floor (lift) and enjoys south facing elevated views towards the Thames, and very good light. The accommodation was redecorated and refitted prior to this last tenancy. Accommodation; open plan Living room and Kitchenette, separate Bedroom, separate Bathroom. Being on King Street, transport, shopping and dining facilities are immediately to hand. Available early July, part furnished or unfurnished (flexible).

# Kings Court, Hammersmith

## Floor Plan

Approximate gross internal area  
31 sq m / 338 sq ft

### Kings Court, W6

Approximate Gross Internal Area = 31.4 sq m / 338 sq ft

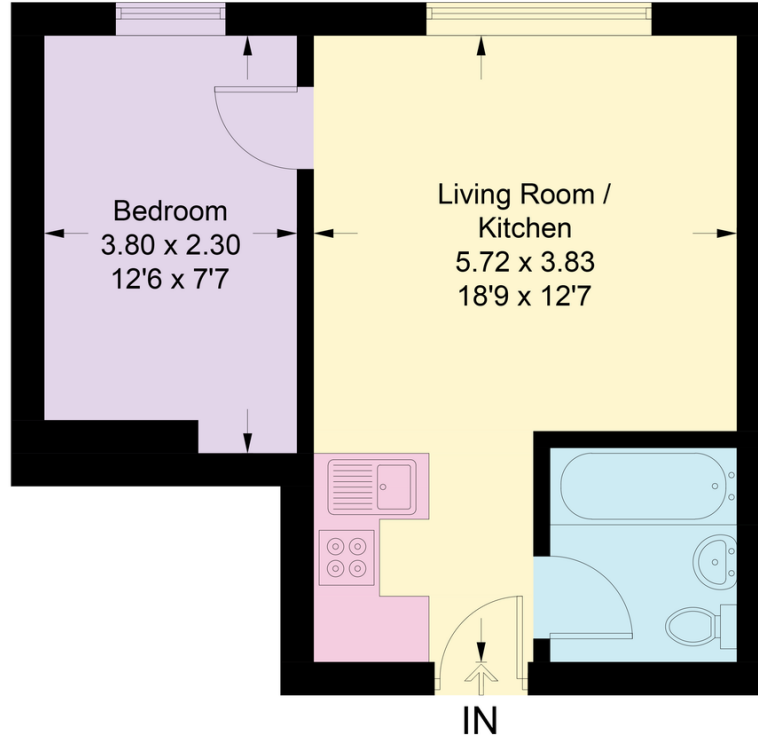

Illustration for identification purposes only, measurements are approximate, not to scale. floorplansUsketch.com © (ID1074464)

## EPC

Energy Efficiency Rating		Current	Potential
Very energy efficient - lower running costs			
(92-100) <b>A</b>			
(81-91) <b>B</b>			
(69-80) <b>C</b>			
(55-68) <b>D</b>			
(39-54) <b>E</b>			
(21-38) <b>F</b>			
(1-20) <b>G</b>			
Not energy efficient - higher running costs			
<b>England &amp; Wales</b>		75	77
	EU Directive 2002/91/EC		

Environmental Impact (CO <sub>2</sub> ) Rating		Current	Potential
Very environmentally friendly - lower CO <sub>2</sub> emissions			
(92-100) <b>A</b>			
(81-91) <b>B</b>			
(69-80) <b>C</b>			
(55-68) <b>D</b>			
(39-54) <b>E</b>			
(21-38) <b>F</b>			
(1-20) <b>G</b>			
Not environmentally friendly - higher CO <sub>2</sub> emissions			
<b>England &amp; Wales</b>		71	71
	EU Directive 2002/91/EC		