



**SALES**

**LETTINGS**

**MANAGEMENT**

[chiswick@tatepartnership.co.uk](mailto:chiswick@tatepartnership.co.uk)

**020 8996 0000**

**TATEPARTNERSHIP.CO.UK**



**Stamford Court W6**

**£1,900 pcm**

A generous two bedroom top floor (lift) purpose built apartment, with an elevated position giving a bright outlook. Situated just moments from Stamford Brook station. The accommodation extends to a comfortable 672 ft/sq (62.4 m2) and comprises: entrance hall, large living room, separate fitted kitchen, two double bedrooms and modern fitted bathroom. Lift, onsite building manager and off street parking for residents (FCFS). Included in the rent is background heating & hot water. Stamford Court is situated on Goldhawk Road just along from Stamford Brook station (zone 2). Chiswick High Road and King Street are a few minutes walk. Available mid-May, part furnished.

# Stamford Court W6

## Floor Plan

Approximate gross internal area  
62 sq m / 672 sq ft

### Stamford Court

Approximate Gross Internal Area = 62.4 sq m / 672 sq ft

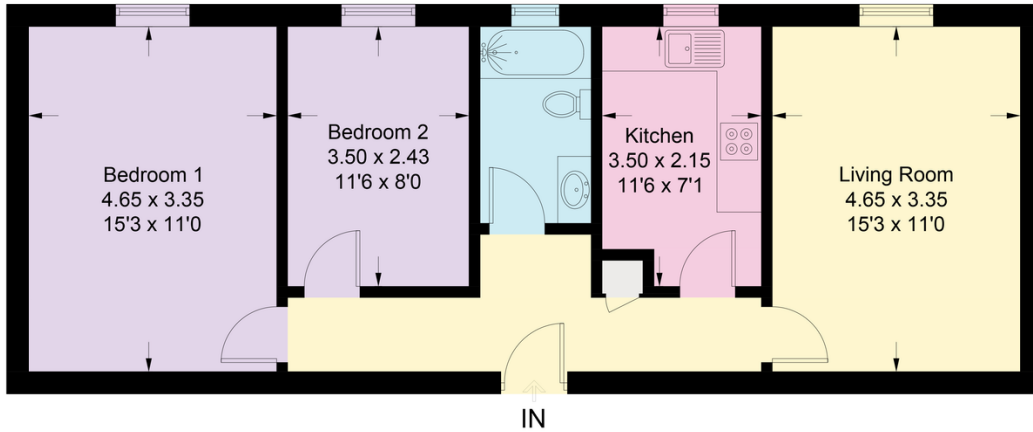

Illustration for identification purposes only, measurements are approximate, not to scale. floorplansUsketch.com © (ID1058998)

## EPC

