



Porchester Terrace, W2

£2,307 Per week

Situated on a quiet residential area, just 0.2 miles from Hyde park and within close proximity to well known shops , bars and restaurants in Notting Hill, Bayswater and Westbourne grove.

Features

- Four Double Bedrooms
- Three Bathrooms
- Separate Kitchen
- Fully Furnished
- Two Balconies
- Private Rear Patio
- Plenty Of Storage

Porchester Terrace, London, W2

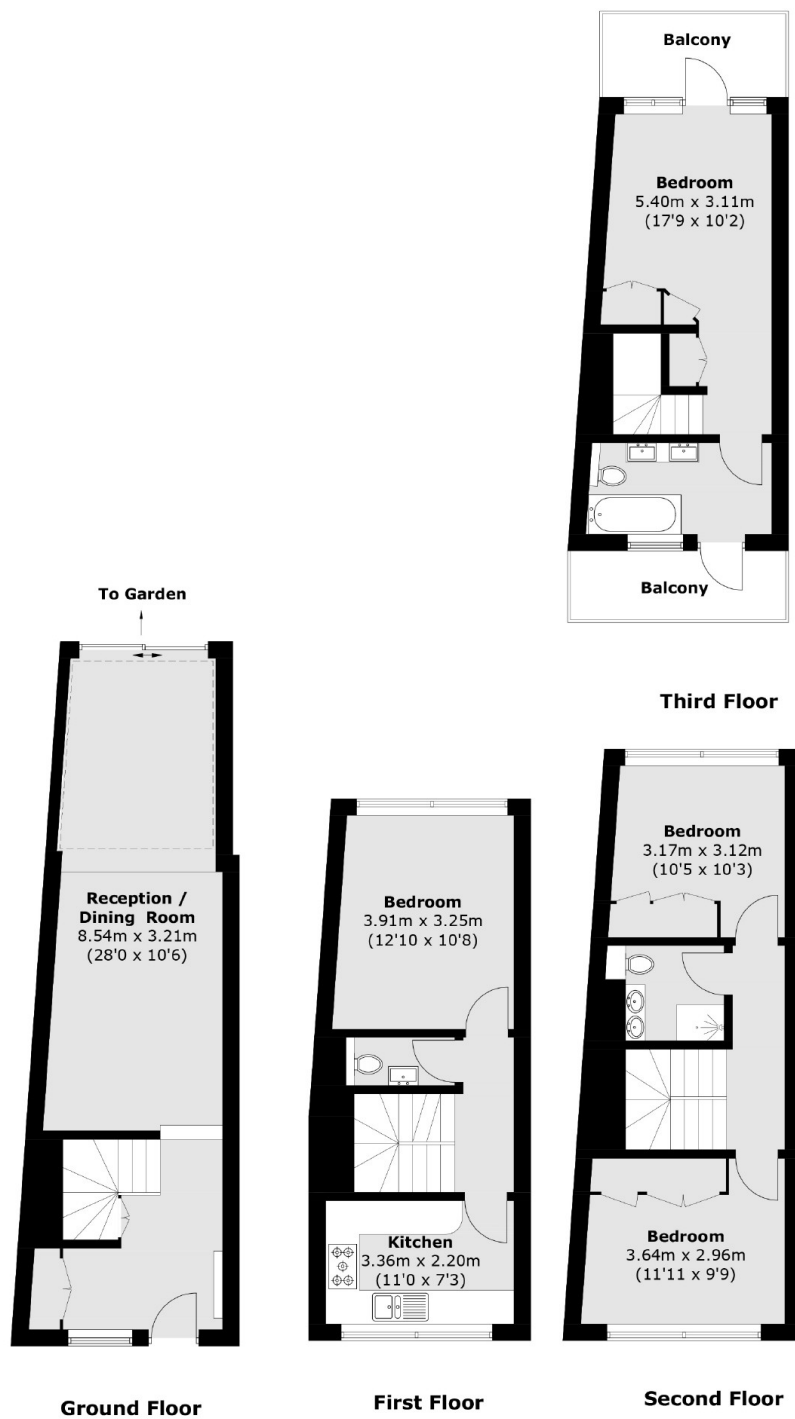

Total area (approx.): 122.6 sq. m (1319.5 sq. ft)
Balcony: 9.6 sq. m (103.3 sq. ft)

Dexters

Hyde Park and Bayswater
4-5 Spring Street
London
W2 3RA
Lettings
020 7298 1560

Energy Rating: D. We aim to make our particulars both accurate and reliable. However they are not guaranteed; nor do they form part of an offer or contract. If you require clarification on any points then please contact us, especially if you're traveling some distance to view. Please note that appliances and heating systems have not been tested and therefore no warranties can be given as to their good working order.

RICS Regulated
Estate Agent
and Letting Agent

dexters.co.uk