



Southwick Street, W2

£850 Per week

A lovely three double bedroom apartment located in the popular Hyde Park Estate. The property has been refurbished to a good standard and is arranged on the first floor of this prestigious purpose-built block with 24 hour concierge and lovely communal gardens. The apartment further benefits from three large double bedrooms, two bathrooms, spacious reception room and contemporary fully fitted kitchen.

Southwick Street is in the popular Connaught Village. Residents have easy access to local shops and bistros as well as Hyde Park and Oxford Street. The closest stations are Lancaster Gate and Marble Arch.

Features

- Three Bedrooms
- Lift
- Porter
- Large Reception
- Communal Gardens
- Separate kitchen

Southwick Street, London, W2

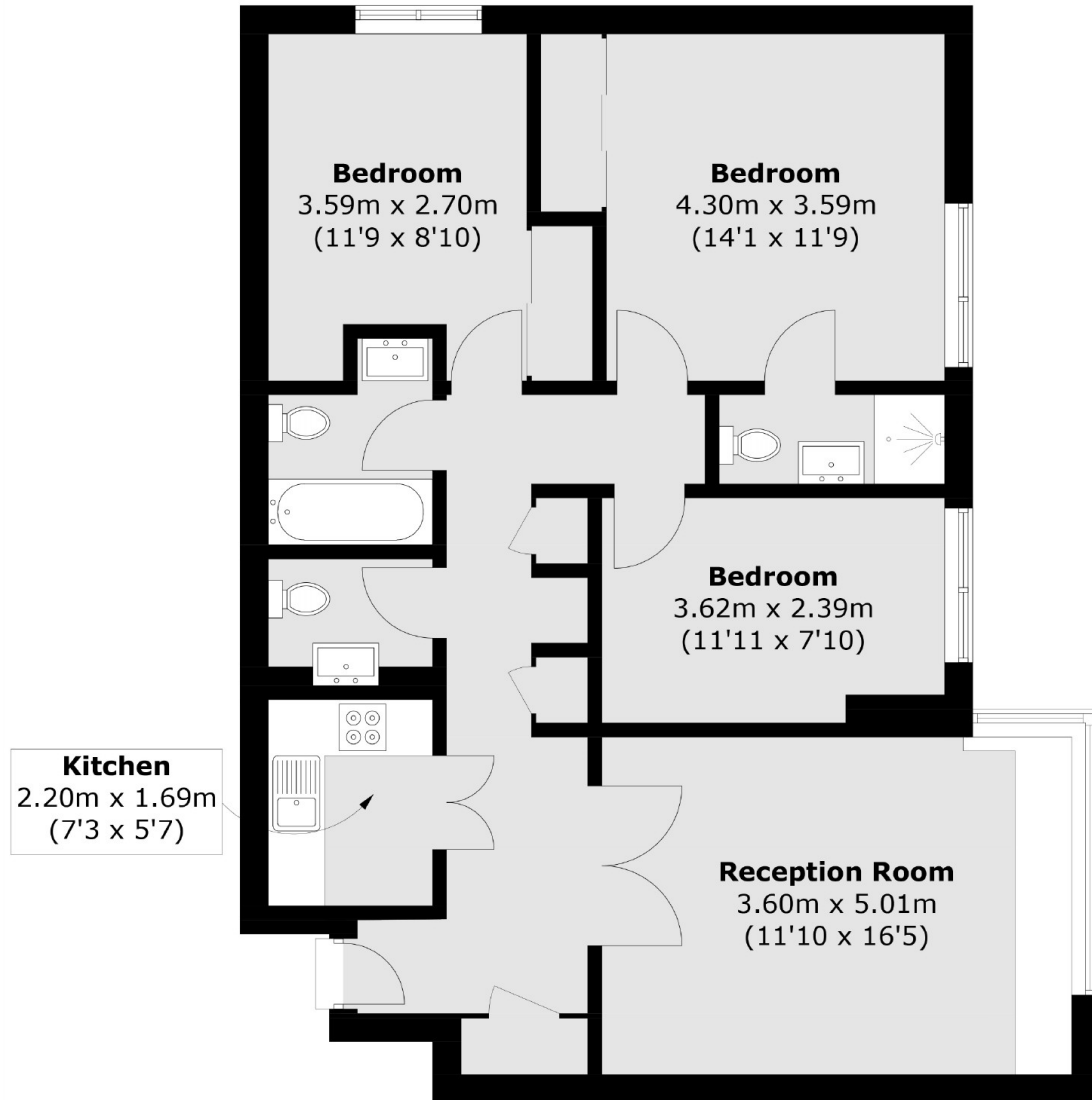

Total area (approx.): 80.4 sq. m (865.1 sq. ft)