



Southwick Street, W2

£623 Per week

A newly refurbished two bedroom apartment in a portered purpose built block. The property has an open plan reception with room to dine, built in wardrobes, and wooden flooring throughout.

Set back from the northern border of Hyde Park and within easy reach of Oxford Street shopping, Marble Arch Underground Station and the bistros and boutiques of Connaught Village.

Features

Two Bedroom
Porter
Open Plan
Wooden Flooring
Newly Refurbished

Southwick Street,
London, W2

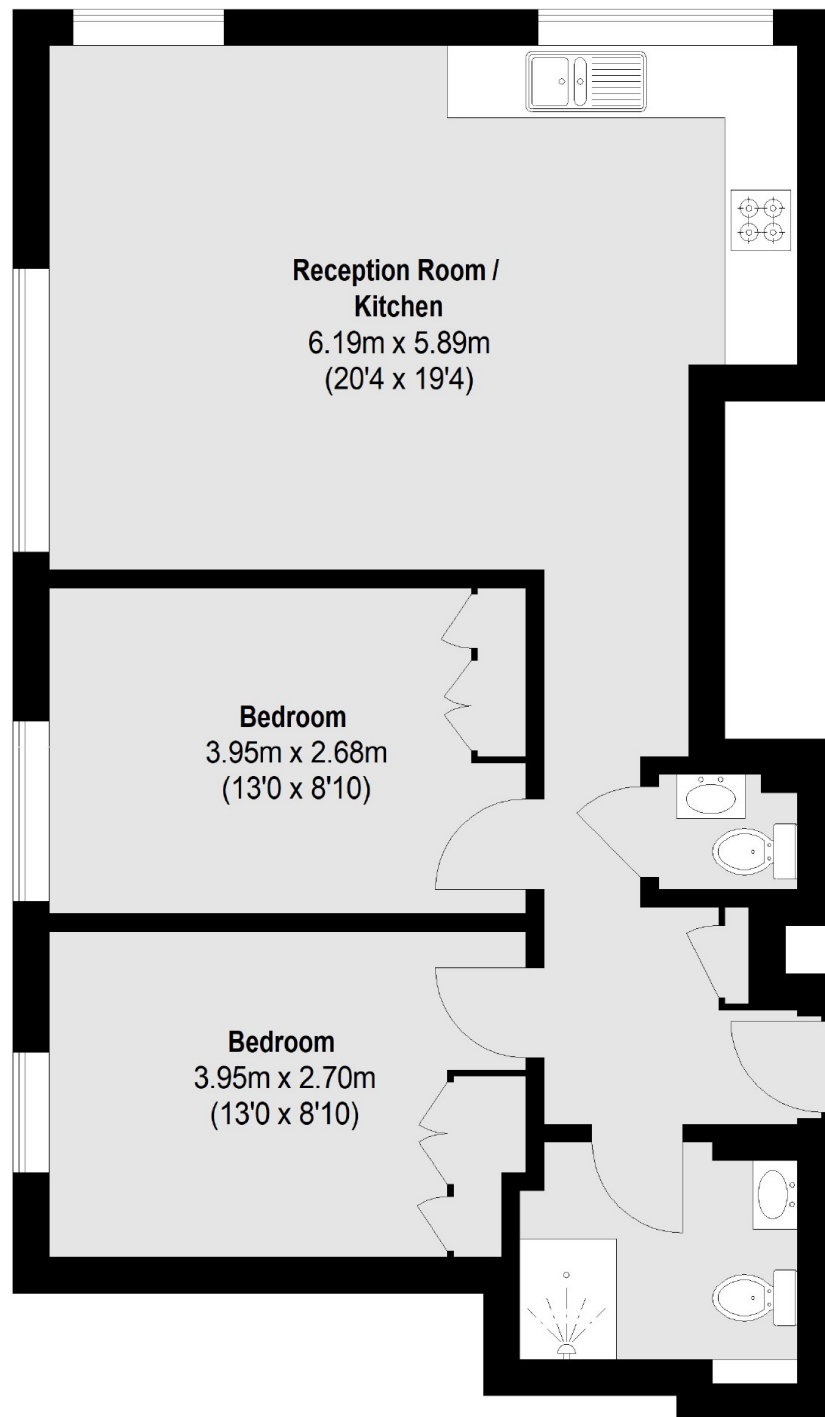

Total area (approx.): 61.11 sq. m (658 Sq. ft)

Dexters

Hyde Park and Bayswater
4-5 Spring Street
London
W2 3RA
Lettings
020 7298 1560

Energy Rating: B. We aim to make our particulars both accurate and reliable. However they are not guaranteed; nor do they form part of an offer or contract. If you require clarification on any points then please contact us, especially if you're traveling some distance to view. Please note that appliances and heating systems have not been tested and therefore no warranties can be given as to their good working order.

 **RICS** | Regulated
Estate Agent
and Letting Agent

[dexters.co.uk](https://www.dexters.co.uk)