



Gloucester Terrace, W2

£500,000

A one bedroom apartment in a Victorian period conversion. The property has a well sized reception with room to dine, a feature fireplace and wooden flooring, a separate modern kitchen, and built in wardrobes in the bedroom.

Gloucester Terrace is conveniently placed for the shops and The Whitleys in Queensway. Lancaster Gate and Paddington stations are also located nearby.

Features

- One Bedroom
- Separate Kitchen
- Share Of Freehold
- Hyde Park
- Period Conversion

Gloucester Terrace,
London, W2

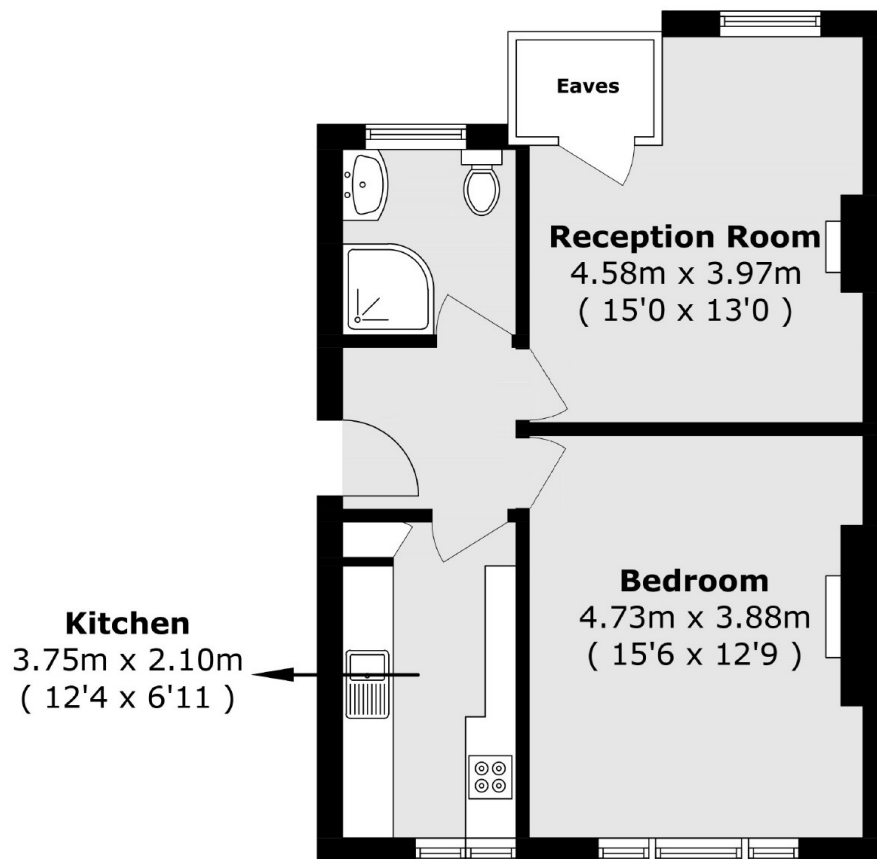

Total area (approx.): 53.4 sq. m (574.7 sq. ft)

(Excluding Eaves)

Dexters

Hyde Park and Bayswater
4-5 Spring Street
London
W2 3RA
Sales
020 7298 1550

Energy Rating: D. We aim to make our particulars both accurate and reliable. However they are not guaranteed; nor do they form part of an offer or contract. If you require clarification on any points then please contact us, especially if you're traveling some distance to view. Please note that appliances and heating systems have not been tested and therefore no warranties can be given as to their good working order.

RICS | Regulated
Estate Agent
and Letting Agent

dexters.co.uk