

## Talbot Square, W2

£800,000

A well presented two double bedroom flat on the first floor (with lift) of a white stucco fronted building. With a reception room leading to the balcony, separate kitchen, wooden floors and high ceilings throughout, this is an ideal investment or first time purchase.

Ideally located within close proximity of Hyde Park and benefitting from the many local amenities as well as excellent transport links, from both Paddington and Lancaster Gate.

### Features

- First floor
- Balcony
- High Ceilings
- Excellent Transport Links
- Lift
- Garden Square View

Talbot Square,  
London, W2

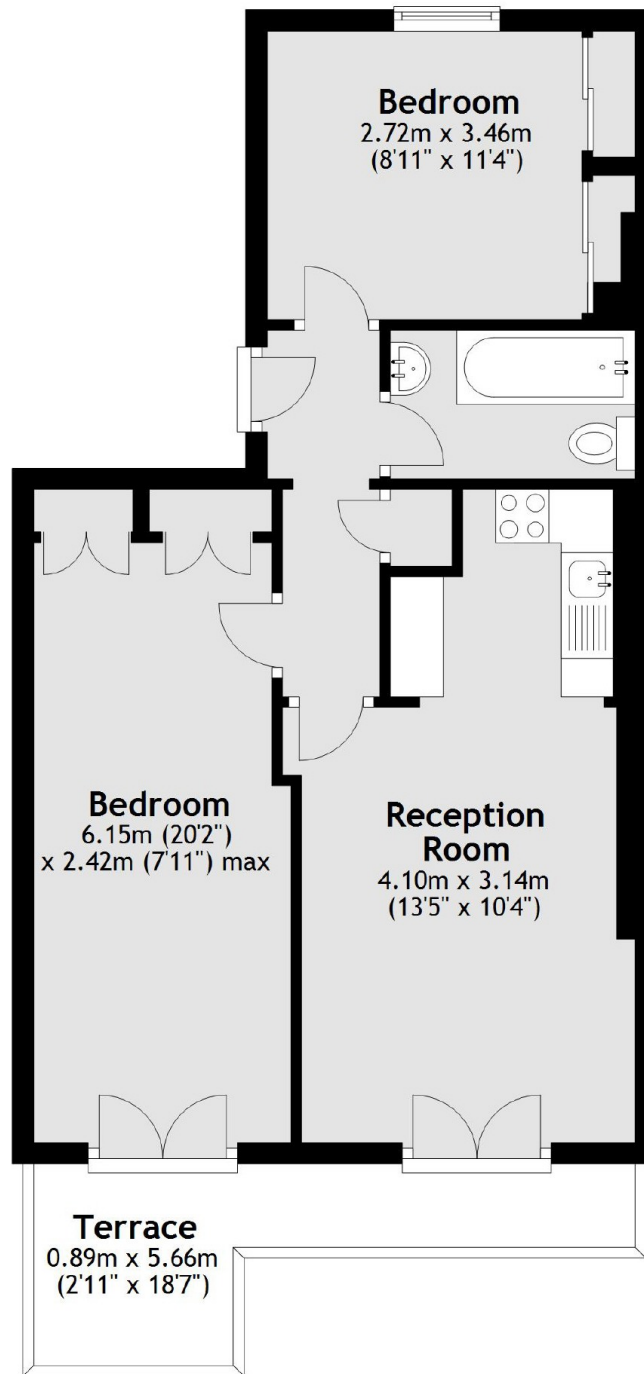

Total area: approx. 49.8 sq. metres (535.8 sq. feet)