



## Queens Gardens, W2

£692 Per week

Excellent two-bedroom apartment set on the third floor of a beautiful Victorian Stucco Fronted period conversion. The property comprises of a large and bright reception room, two bedrooms a separate fully equipped kitchen and a good size bathroom.

Queens Gardens is a leafy garden square moments from Hyde Park and close to local transport. The property has easy access to Bayswater, Lancaster Gate and Paddington station with access to the Heathrow Express.

### Features

- Two Bedrooms
- Period Conversion
- High Ceilings
- Bright and light
- Spacious living area
- Excellent transport links

Queens Gardens,  
London, W2

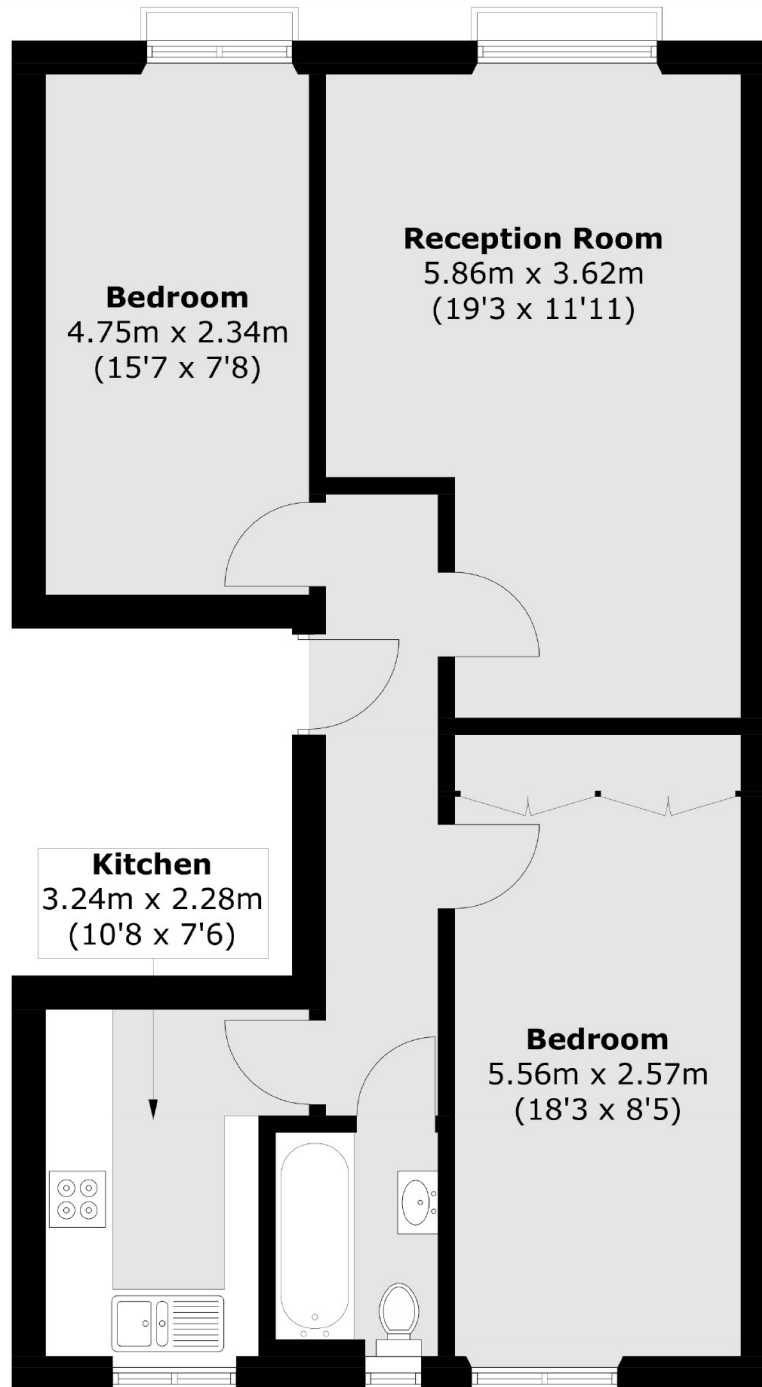

Total area (approx.): 62.3 sq. m (670.6 sq. ft)