

Westbourne Terrace, W2

£520 Per week

A one bedroom apartment in a Victorian period conversion on Westbourne Terrace, close to Hyde Park. The property has an open plan reception with wooden floors, a good size bedroom with fitted storage and a modern, tiled shower room.

The nearest stations are Lancaster Gate and Paddington with access to the Heathrow Express.

Features

Modern
One Bedroom
Wooden Floors
Hyde Park
Lift Access
Period Conversion

Westbourne Terrace,
London, W2

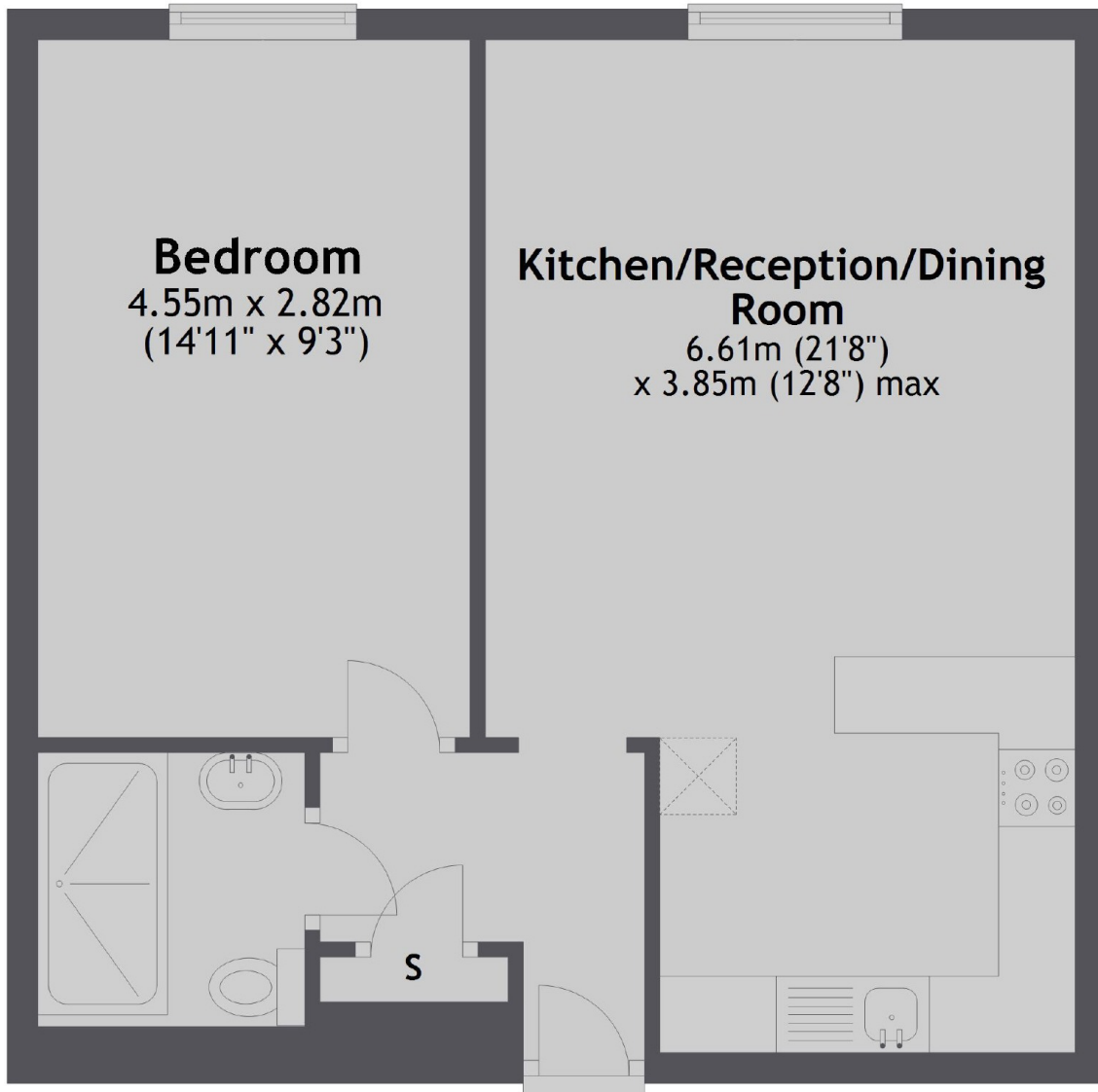

Second Floor

Total area: approx. 44.7 sq. metres (481.3 sq. feet)