



London Mews, W2

£630 Per week

A lovely two bedroom mews house in Hyde Park. The property has a spacious reception room leading to the fitted kitchen and garage on the ground floor, with the bedrooms and bathroom on the top.

London Mews is a small mews street, moments from Paddington Station with easy access into Oxford Street. The open spaces of Hyde Park are also nearby.

Features

- Two Bedrooms
- Garage
- Separate Kitchen
- Mews House
- Wood Flooring
- Hyde Park

London Mews, London, W2

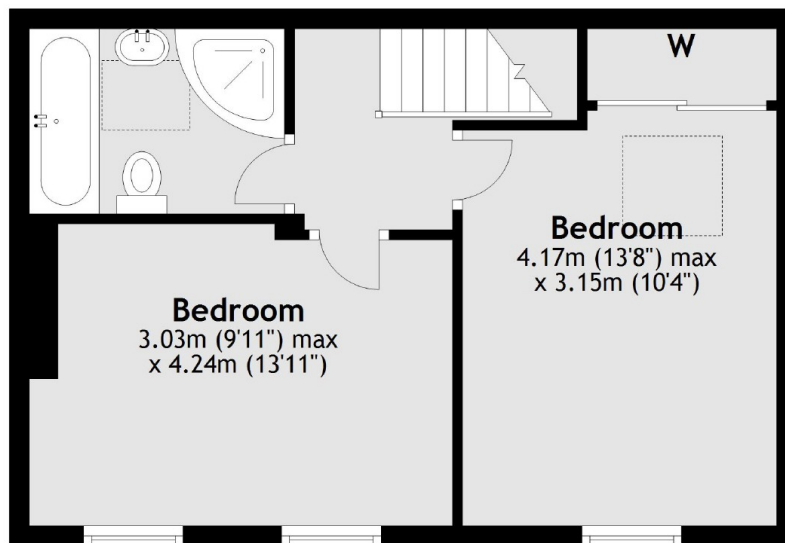
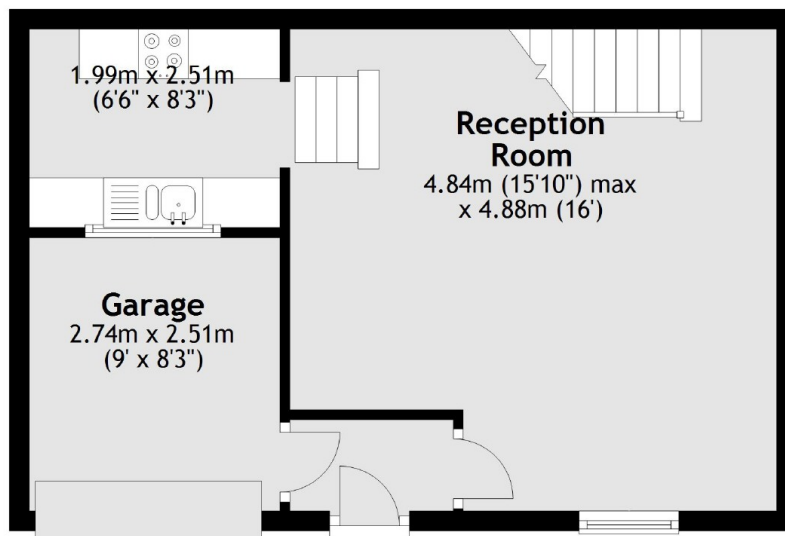

Total area: approx. 73.7 sq. metres (792.8 sq. feet)