



Star Street, W2

£392 Per week

A one bedroom apartment in a Victorian period conversion. The property has been newly refurbished, and has an open plan reception, and built in wardrobe.

Moments from Praed Street, St Marys Hospital and Paddington Station, the property is close to the shops of Connaught Village and less than a mile away from Hyde Park.

Features

- One Bedroom
- Open Plan Reception
- Newly Refurbished
- Period Conversion
- Hyde Park

**Star Street,
London, W2**

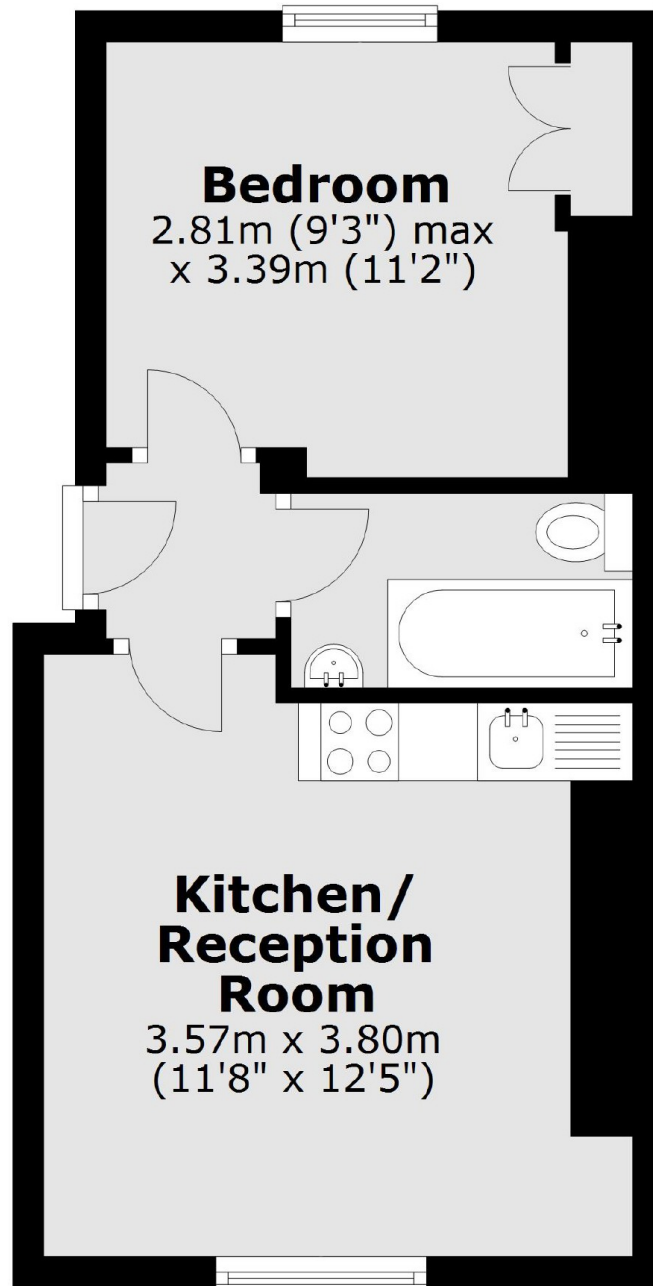

Total area: approx. 28.1 sq. metres (302.9 sq. feet)