



## Warwick Crescent, W2

£461 Per week

A one bedroom apartment in Little Venice by the canal. The property has a patio garden with access to the communal gardens, an open plan kitchen, and jack-and-jill bathroom.

Warwick Crescent is ideally located on the Grand Union Canal. Closest tube stations include Royal Oak (Circle Line and Hammersmith and City Line) and Warwick Avenue (Bakerloo Line).

### Features

- One Bedroom
- Patio
- Canal Views
- Open Plan Kitchen
- Little Venice

# Warwick Crescent, London, W2

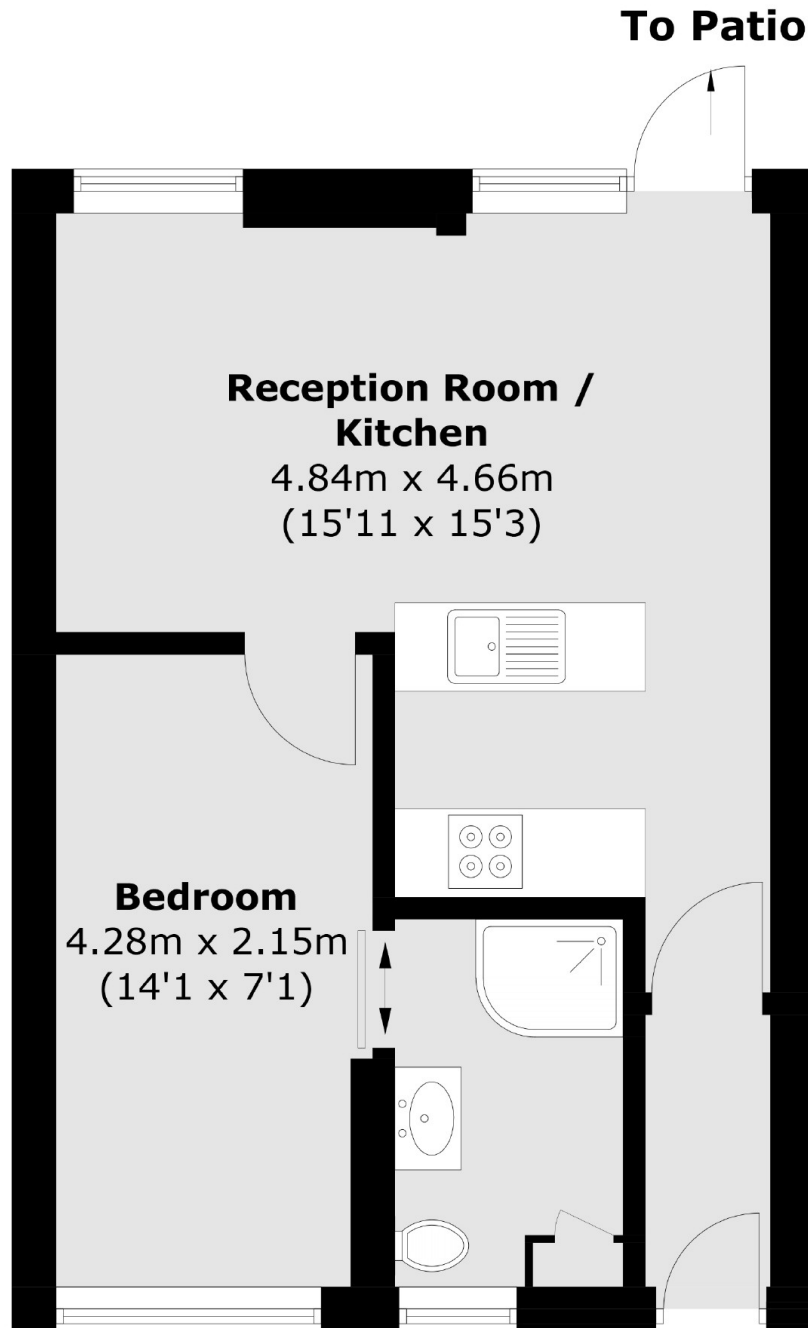

Total area (approx.): 35.6 sq. m (383.2 sq. ft)