



Porchester Square, W2

£475,000

A well presented one double bedroom garden flat located in a Victorian period conversion. The property benefits from a large reception room leading to a private patio garden, access to a garden square and an eat-in kitchen. Property is currently let on AST for £2,100 pcm with a minimum contract until 20/12/23.

Porchester Square is ideally located near a large Waitrose supermarket and the shops of Westbourne Grove and Queensway. The closest transport links are Royal Oak and Bayswater whilst Paddington Station is also a short walk away.

Features

- One Double Bedroom
- Private Garden
- Separate Kitchen
- Garden Square
- Beautifully Refurbished
- Buy to Let Investment

Porchester Square,
London, W2

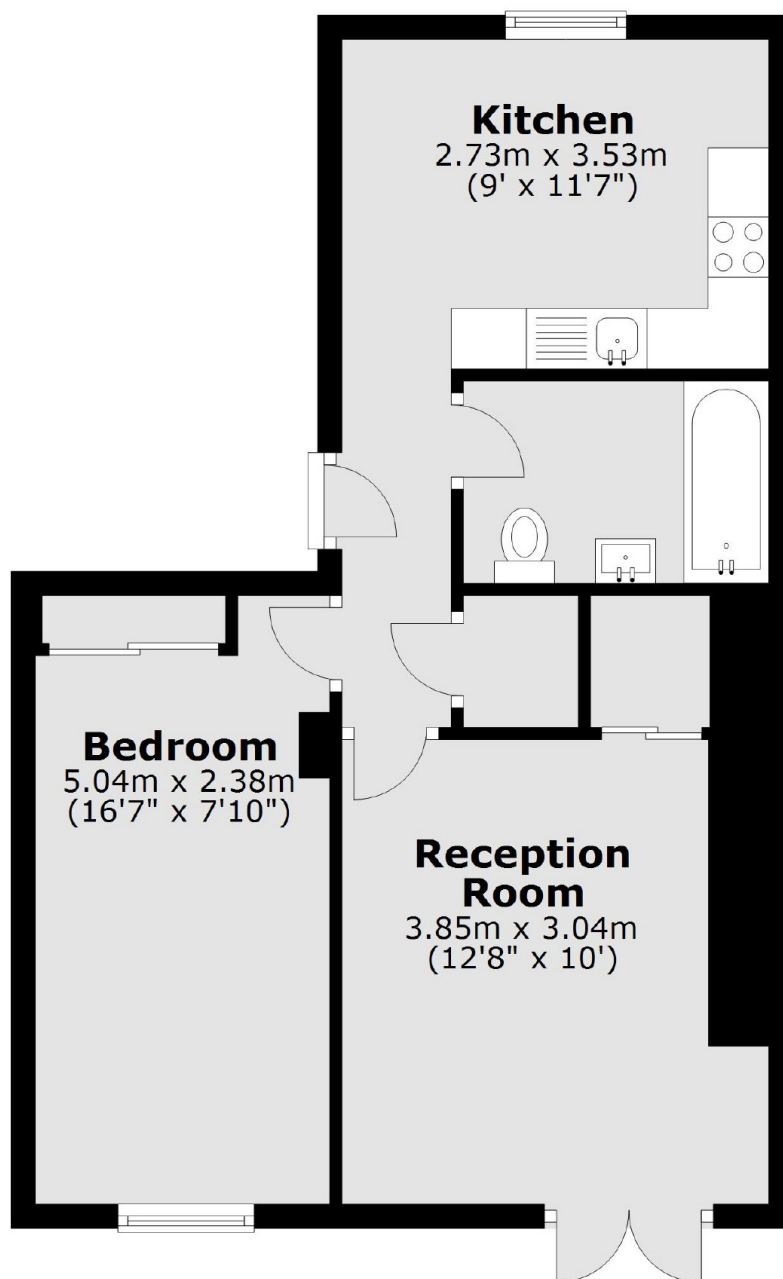

Total area: approx. 46.6 sq. metres (501.6 sq. feet)