



**3 Wood View, Shotts, ML7 5AU**  
**Offers Over £104,000**

Beautiful Two-Bed Mid-Terraced Family Home in Wood View, Allanton — Offered with No Onward Chain

This well-presented mid-terraced home offers a fantastic opportunity for first-time buyers, young families, or investors. Located in the popular Wood View area of Allanton, the property features a bright and spacious lounge, a traditional fitted kitchen, and two well-proportioned bedrooms. The upper level is complete with a modern wet floor shower room for added convenience.

Outside, you'll find private front and rear gardens, ideal for relaxing or entertaining. The home benefits from its peaceful residential setting while remaining close to local amenities, transport links, and schools. On Street parking.

With no chain, this property is ready for a smooth and straightforward move.

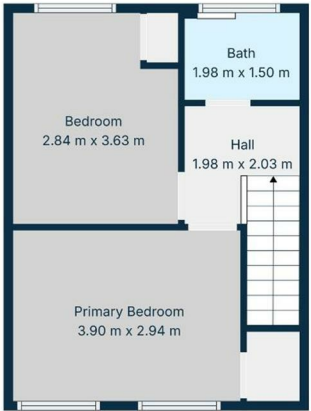

Energy Efficiency Rating		
	Current	Potential
Very energy efficient - lower running costs		
(92 plus) A		
(81-91) B		
(69-80) C		
(55-68) D		
(39-54) E		
(21-38) F		
(1-20) G		
Not energy efficient - higher running costs		
Scotland	EU Directive 2002/91/EC	

Environmental Impact (CO <sub>2</sub> ) Rating		
	Current	Potential
Very environmentally friendly - lower CO <sub>2</sub> emissions		
(92 plus) A		
(81-91) B		
(69-80) C		
(55-68) D		
(39-54) E		
(21-38) F		
(1-20) G		
Not environmentally friendly - higher CO <sub>2</sub> emissions		
Scotland	EU Directive 2002/91/EC	

