



**Flat 2, Alma House 43 Church Street, Newent GL18 1AA**  
**£125,000**





## Flat 2, Alma House 43 Church Street, Newent GL18 1AA

• Two bedroom top floor apartment • Popular market town location • Communal garden • Potential rental income of £750 pcm. • Tax Band A • EPC C69

**£125,000**

### Living Room

Laminated flooring. Sash window to front aspect of the apartment.

### Kitchen

Ample storage in a range of floor and eye level units accompanied by space for cooker and washing machine. Window to front aspect.

### Master Bedroom

Carpeted. Window to front aspect overlooking Newent High street.

### Second Bedroom

Carpeted. Above stairs storage cupboard. Window to front aspect

### Bathroom

Tiled bathroom with white suite to include WC, vanity wash hand basin and bath with shower over. Skylight.

### Outside

There is a communal garden located to the rear of the property. This space offers a combination of gravelled and lawned areas.

### Location

Newent originally called Noent is a small market

town about 8 miles north west of Gloucester, on the northern edge of the Forest of Dean. The town includes a half-timbered market house, plus other houses of historical nature and Newent Lake a large picturesque lake in the centre of the town, originally part of the Newent Court Estate. Newent is served by three schools, doctors' surgery and dentist, Sports & Leisure Centre. Excellent motorway links to the M50 & M5.

### Material Information

Tenure: Share of the freehold. Lease length 999 years from January 2024.

Management charge: £420 per annum paid to Alma House Ltd to cover building insurance.

Council tax band: A

Local Authority & rates: Forest of Dean District Council - £1,525.80 2024/25

Electricity supply: mains

Water supply: mains

Sewerage: mains

Heating: gas

Broadband speed: Basic 16 Mbps Superfast 80 Mbps

Mobile phone coverage: EE, Vodaphone, Three, O2



1 High Street, Newent, GL18 1AN

01531 828970

[newent@naylorpowell.com](mailto:newent@naylorpowell.com)

[www.naylorpowell.com](http://www.naylorpowell.com)



GROUND FLOOR

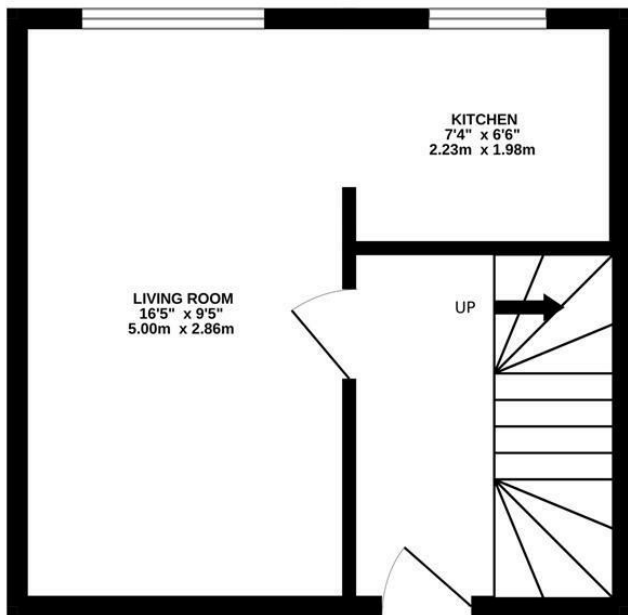

1ST FLOOR

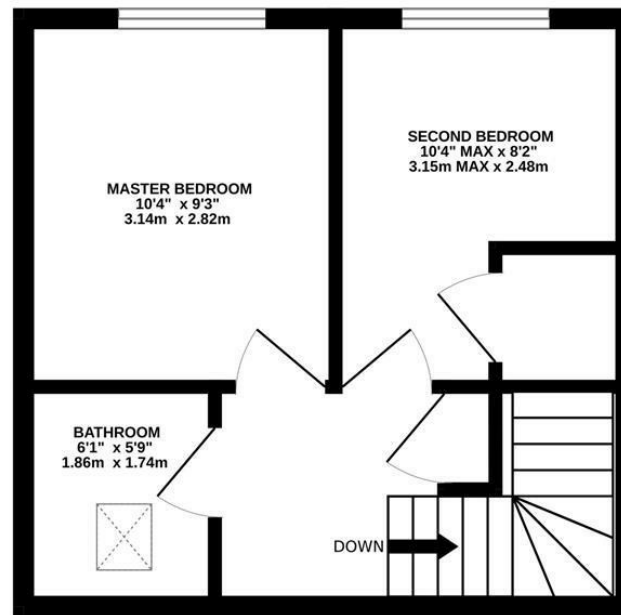

Whilst every attempt has been made to ensure the accuracy of the floorplan contained here, measurements of doors, windows, rooms and any other items are approximate and no responsibility is taken for any error, omission or mis-statement. This plan is for illustrative purposes only and should be used as such by any prospective purchaser. The services, systems and appliances shown have not been tested and no guarantee as to their operability or efficiency can be given.  
Made with Metropix ©2024

Disclaimer: These particulars do not form part of any contract and no responsibility is accepted for any errors or omissions in any statement made, whether verbally or written for or on behalf of Naylor Powell.

Floorplans have been prepared for identification purposes only, they are not to scale and no guarantee can be given as to their accuracy.

Prospective purchasers please be aware none of the appliances, boiler, heaters etc. which may have been mentioned in these particulars have been tested and no guarantee can be given that they are in working order. Prospective purchasers should arrange for such items to be tested at their own expense.

