



22A WILLOW WAY
CHRISTCHURCH
Dorset, BH23 1JJ

£1,100 PCM

goadsby.com

WELL-PRESENTED
TWO BEDROOM
APARTMENT CLOSE
TO CHRISTCHURCH
QUAY

- Two Bedroom Apartment
- Offered Unfurnished with Allocated Parking Space
- Close to Christchurch Quay
- Modern Throughout
- EPC Rating: Band D

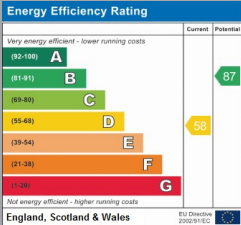

Reference: 891725

Deposit amount: £1,269.23

Council Tax Band: A

Furnishing: Unfurnished

Heating Type: Gas fired hot water radiators

Parking: Allocated Parking Space

Utilities:

- Mains Supply Electricity
- Mains Supply Gas
- Mains Supply Water - metered

Drainage: Mains Supply Drainage

Broadband: Refer to Ofcom website
www.ofcom.org.uk/phones-and-broadband

Mobile Signal: Refer to Ofcom website
www.ofcom.org.uk/phones-and-broadband

Flood Risk: For more information refer to
gov.uk, check long term flood risk
www.gov.uk/check-long-term-flood-risk

01202 432188
southbourne@goadsby.com

31 Southbourne Grove

Southbourne
Bournemouth, Dorset
BH6 3QT



Located within walking distance to Christchurch Quay, this two bedroom apartment is modern and well presented. The property offers ample living space in a highly sought after location and also benefits from a balcony. Offered on an unfurnished basis this apartment also benefits from a private entrance and single allocated parking space.

Please note the marketing photos were taken prior to previous Tenancy in 2022.

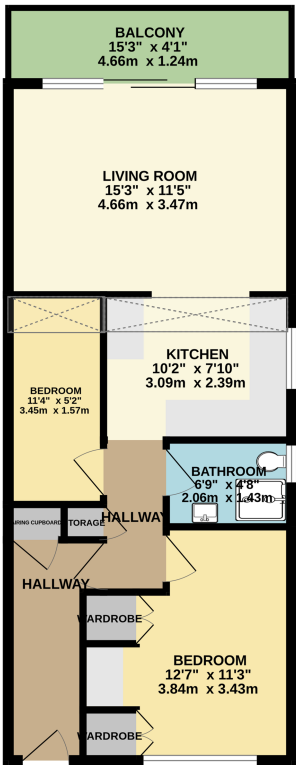

This Floor Plan is for guidance only and is NOT to SCALE
Made with Metropix 62025

PLEASE NOTE:

Measurements quoted are approximate and for guidance only. Fixtures, fittings, services & appliances have not been tested and therefore no guarantee can be given that they are in working order. Images have been produced for information and it cannot be inferred that any item shown is included with the property. These particulars are believed to be correct but their accuracy is not guaranteed and they do not constitute an offer or form part of a contract. Solicitors are specifically requested to verify the sales particulars details in the pre-contract enquiries, in particular: price, local and other searches.

Goadsby & Harding (Residential) Ltd
Registered Office: 99 Holdenhurst Road, Bournemouth, Dorset BH8 8DY Registered in England No. 1871280