



4 FISHERMANS WHARF
HAMWORTHY
Dorset, BH15 4AS

£1,050 PCM

goadsby.com

A WELL PRESENTED ONE BEDROOM FLAT WITH STUDY & PARKING

- First Floor Flat
- One Double Bedroom
- Additional Study Room
- Allocated Parking
- EPC Rating: Band D

Energy Efficiency Rating		
	Current	Potential
Very energy efficient - lower running costs		
A (92-100)		
B (81-91)		
C (69-80)		
D (55-68)		
E (39-54)		
F (21-38)		
G (1-20)		
Not energy efficient - higher running costs		
England, Scotland & Wales		
	67	75

Reference: 1005506

Deposit Amount: £1,211.53

Council Tax Band: A

Furnishing: Part-furnished

Heating Type: Gas Central Heating

Parking: Allocated Parking

Utilities:

Mains Supply Electricity
Mains Supply Gas
Mains Supply Water

Drainage: Mains Supply Drainage

Broadband: Refer to Ofcom website
www.ofcom.org.uk/phones-and-broadband

Mobile Signal: Refer to Ofcom website
www.ofcom.org.uk/phones-and-broadband

Flood Risk: For more information refer to
gov.uk, check long term flood risk
www.gov.uk/check-long-term-flood-risk

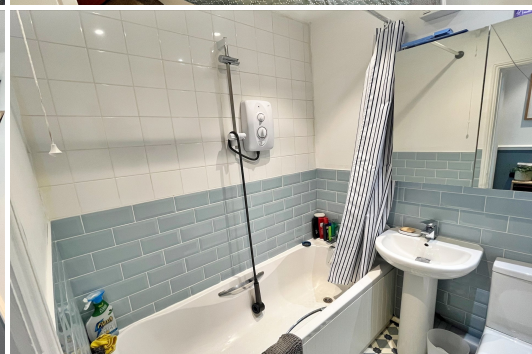

This well presented first floor flat is ideally situated within walking distance to Poole Quay and Hamworthy Beach. The property offers one double bedroom plus a study room and a spacious living room with modern kitchen and bathroom. The property is neutrally decorated and is offered part-furnished with white goods and benefits from allocated parking and ample storage.

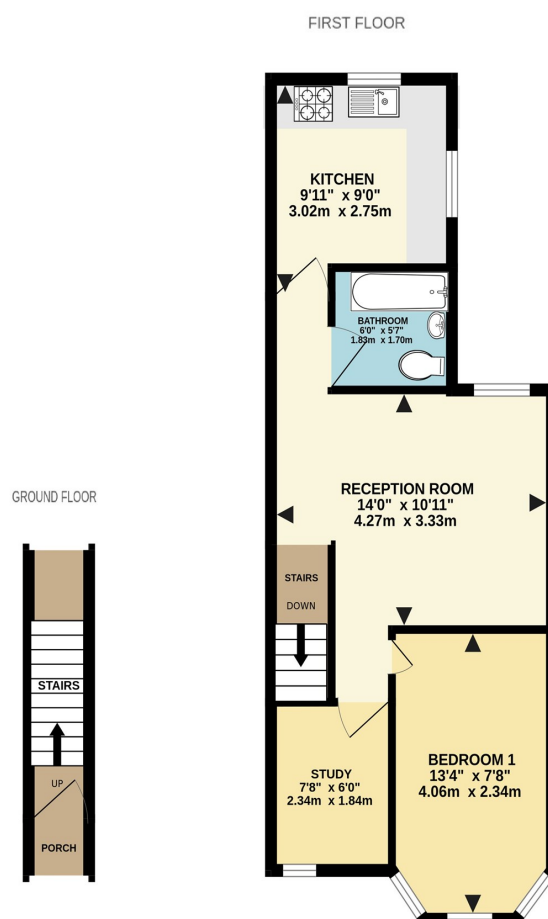

This Floor Plan is for guidance only and is NOT to SCALE
Made with Metropix ©2025

PLEASE NOTE:

Measurements quoted are approximate and for guidance only. Fixtures, fittings, services & appliances have not been tested and therefore no guarantee can be given that they are in working order. Images have been produced for information and it cannot be inferred that any item shown is included with the property. These particulars are believed to be correct but their accuracy is not guaranteed and they do not constitute an offer or form part of a contract. Solicitors are specifically requested to verify the sales particulars details in the pre-contract enquiries, in particular: price, local and other searches.

Goadsby & Harding (Residential) Ltd

Registered Office: 99 Holdenhurst Road, Bournemouth, Dorset BH8 8DY Registered in England No. 1871280

01202 686555
poole@goadsby.com

245 High Street North
Poole, Dorset
BH15 1DX