



15 THE PEAK
WESTBOURNE
Dorset, BH2 6DH

£1,200 PCM

goadsby.com

MODERN TWO BEDROOM APARTMENT CLOSE TO WESTBOURNE AND TOWN CENTRE.

- Two Bedroom Apartment
- Unfurnished
- Popular Location
- Allocated Parking
- EPC Rating: Band C

Energy Efficiency Rating		
	Current	Potential
Very energy efficient - lower running costs		
A (92+)		
B (81-91)		
C (69-80)	79	85
D (55-68)		
E (39-54)		
F (21-38)		
G (1-20)		
Not energy efficient - higher running costs		
England, Scotland & Wales		
EPC Directive 2002/91/EC		

Reference: 693008

Deposit Amount: £1384.61

Council Tax: Band A

Furnishing: Unfurnished

Heating Type: Electric

Parking: 1 Parking Space

Utilities:

- Private Supply Electricity
- Private Supply Water - metered

Drainage: Private Supply Drainage

Broadband: Refer to Ofcom website
www.ofcom.org.uk/phones-and-broadband

Mobile Signal: Refer to Ofcom website
www.ofcom.org.uk/phones-and-broadband

Flood Risk: For more information refer to
gov.uk, check long term flood risk
www.gov.uk/check-long-term-flood-risk



This second floor two bedroom apartment is offered to the market unfurnished. Located in a convenient location close to Westbourne Village, the property comprises of two bedrooms, bathroom and open plan lounge/kitchen/diner. The property also benefits from an allocated parking space and has a lift.

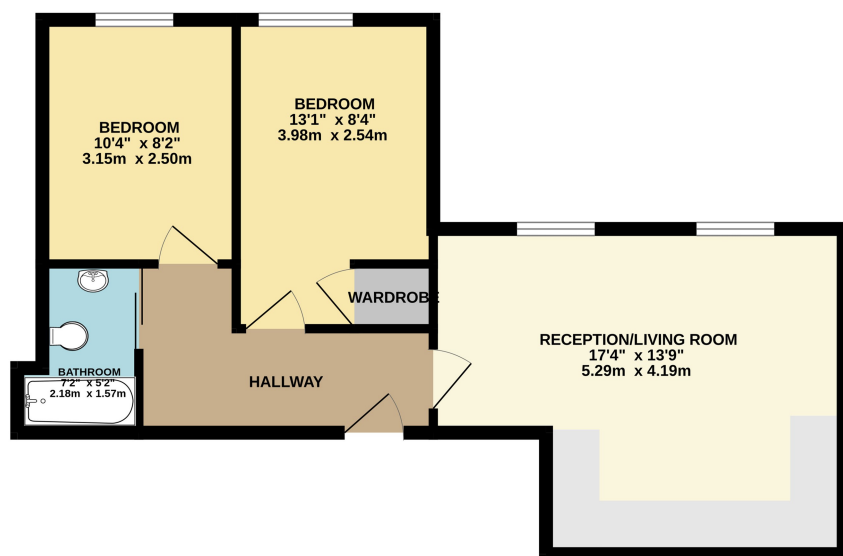

This Floor Plan is for guidance only and is NOT to SCALE
Made with Metropix C2025

PLEASE NOTE:

Measurements quoted are approximate and for guidance only. Fixtures, fittings, services & appliances have not been tested and therefore no guarantee can be given that they are in working order. Images have been produced for information and it cannot be inferred that any item shown is included with the property. These particulars are believed to be correct but their accuracy is not guaranteed and they do not constitute an offer or form part of a contract. Solicitors are specifically requested to verify the sales particulars details in the pre-contract enquiries, in particular: price, local and other searches.

Goadsby & Harding (Residential) Ltd

Registered Office: 99 Holdenhurst Road, Bournemouth, Dorset BH8 8DY Registered in England No. 1871280

01202 544644

bournemouthlettings@goadsby.com

114 Old Christchurch Road
Bournemouth, Dorset
BH1 1LU