

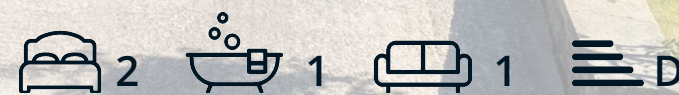

12 Ridd Way

Wingerworth, Chesterfield, S42 6UX

Asking Price £240,000



12 Ridd Way

Wingerworth, Chesterfield, S42

Situated in the pretty village of Wingerworth, located close to the village's amenities and close to local transport links is this well-presented 2 bedroom detached bungalow, perfect for a buyer wanting to add their own touch.

Offering 828 sqft of accommodation over one storey, the property features a detached single garage with front and side access, a large driveway with carport, 2 generously sized bedrooms, 2 formal reception rooms including a lounge and a dining room, a kitchen and a bathroom.

Externally, to the rear is a low maintenance garden and to the front and side of the home is a driveway providing off road parking for multiple vehicles.

Dales & Peaks ForwardMove
please read





Floor Plan

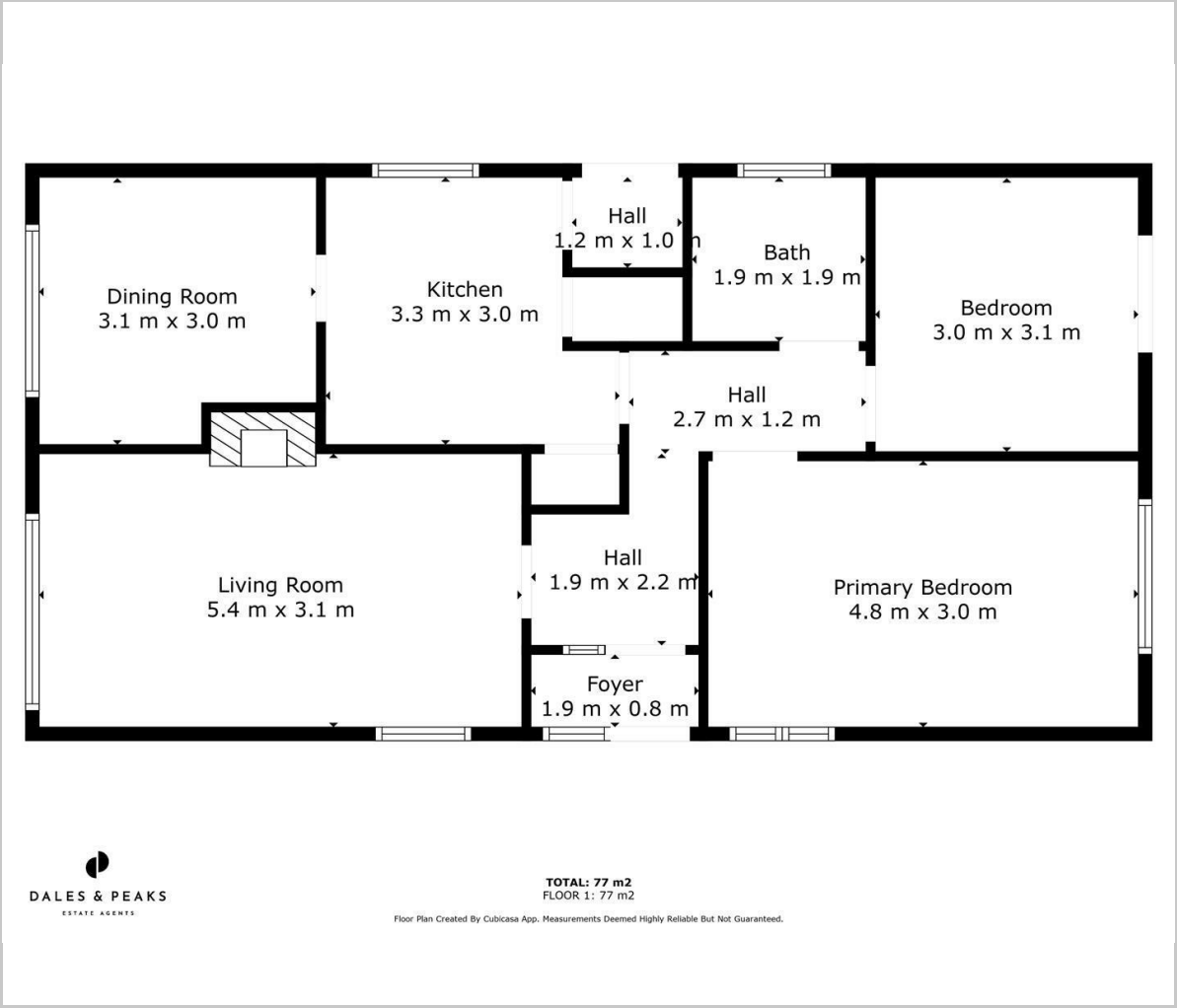

Viewing

Please contact our Chesterfield Office on 01246 567540 if you wish to arrange a viewing appointment for this property or require further information.

These particulars, whilst believed to be accurate are set out as a general outline only for guidance and do not constitute any part of an offer or contract. Intending purchasers should not rely on them as statements of representation of fact, but must satisfy themselves by inspection or otherwise as to their accuracy. No person in this firms employment has the authority to make or give any representation or warranty in respect of the property.

Area Map

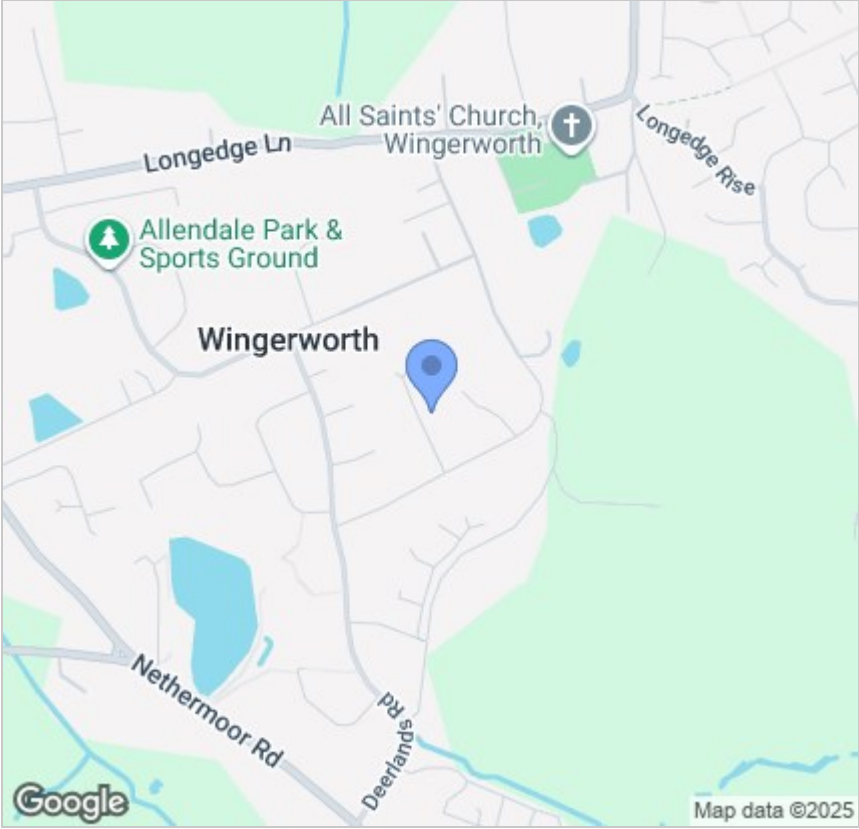

Energy Efficiency Graph

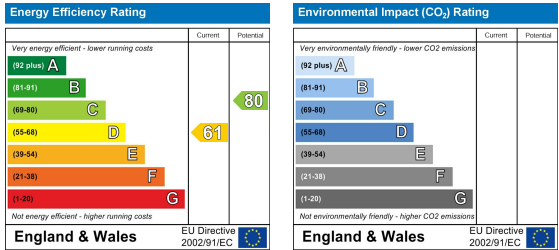

131 Chatsworth Road, Chesterfield, Derbyshire, S40 2AP
T: 01246 567540



E: info@dalesandpeaks.co.uk
www.dalesandpeaks.co.uk