



2 Errington Road
, Chesterfield, S40 3EP

Guide Price £350,000



2 Errington Road

, Chesterfield, S40 3EP

£350,000 - £375,000 (Guide price)
Situating in this highly sought-after location, surrounded by neighbouring countryside walks and within close proximity to a selection of vibrant amenities is this tastefully styled and practically designed 4 bedroom semi-detached property. Extended to offer 1280 sqft of accommodation over 2 storeys, the property features an open plan living and dining space leading off the kitchen, a modern shaker kitchen with a range of integrated appliances, a separate formal lounge, spacious bedrooms, 2 bathrooms including the master en-suite and a generous corner plot with low maintenance garden and ample off road parking.

The ground floor comprises; entrance hallway, dual aspect open plan family space with patio doors to the rear garden, shaker kitchen with breakfast bar and a range of integrated appliances, separate utility room, ground floor WC and a family lounge with log burning stove.

The first floor comprises; 4 generously sized bedrooms, 2 bathrooms including the master en-suite.

Dales & Peaks ForwardMove
please read





Floor Plan

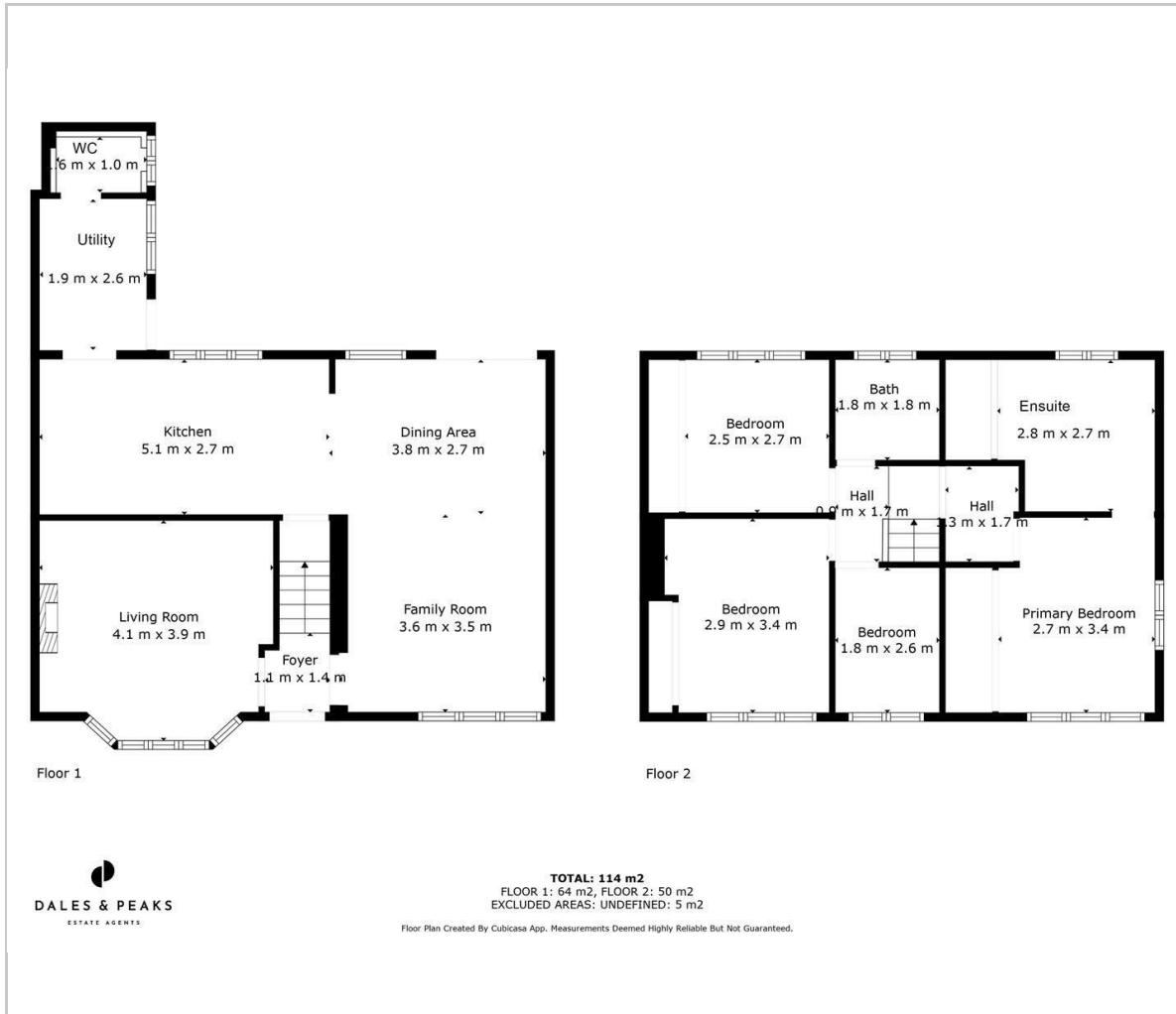

Viewing

Please contact our Chesterfield Office on 01246 567540 if you wish to arrange a viewing appointment for this property or require further information.

These particulars, whilst believed to be accurate are set out as a general outline only for guidance and do not constitute any part of an offer or contract. Intending purchasers should not rely on them as statements of representation of fact, but must satisfy themselves by inspection or otherwise as to their accuracy. No person in this firm's employment has the authority to make or give any representation or warranty in respect of the property.

Area Map



Energy Efficiency Graph

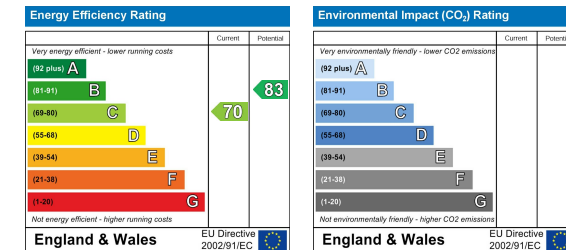

131 Chatsworth Road, Chesterfield, Derbyshire, S40 2AP
 T: 01246 567540



E: info@dalesandpeaks.co.uk
 www.dalesandpeaks.co.uk