



27 - 29 Dale Road
, Matlock, DE4 3LT
£1,200 PCM

27 - 29 Dale Road

, Matlock, DE4 3LT

FULLY FURNISHED -3 Derwent Views is located on Dale Road in the picturesque town of Matlock and as the property suggests it overlooks the River Derwent. This property offers 1370 sq ft of living space with a spacious open plan kitchen, dining and living area. The apartment features 3 bedrooms and 2 bathrooms, offering convenience and privacy for all residents. Situated in a desirable location, this property provides easy access to local amenities, shops, and restaurants, making it a convenient place to call home. The charm of Matlock with its stunning views and friendly community is right at your doorstep.

For fee information please copy and paste the link below for our tenant brochure

https://ggfx-dalesandpeaks.s3.eu-west-2.amazonaws.com/i.prod/Tenants_broc

- * We are a member of the Propertymark Client Money Protection Scheme - propertymark.co.uk
- * We are a member of The Property Ombudsman Scheme - tpos.co.uk
- * We place all our deposits in the Deposit Protection Scheme DPS - depositprotection.com





Floor Plan

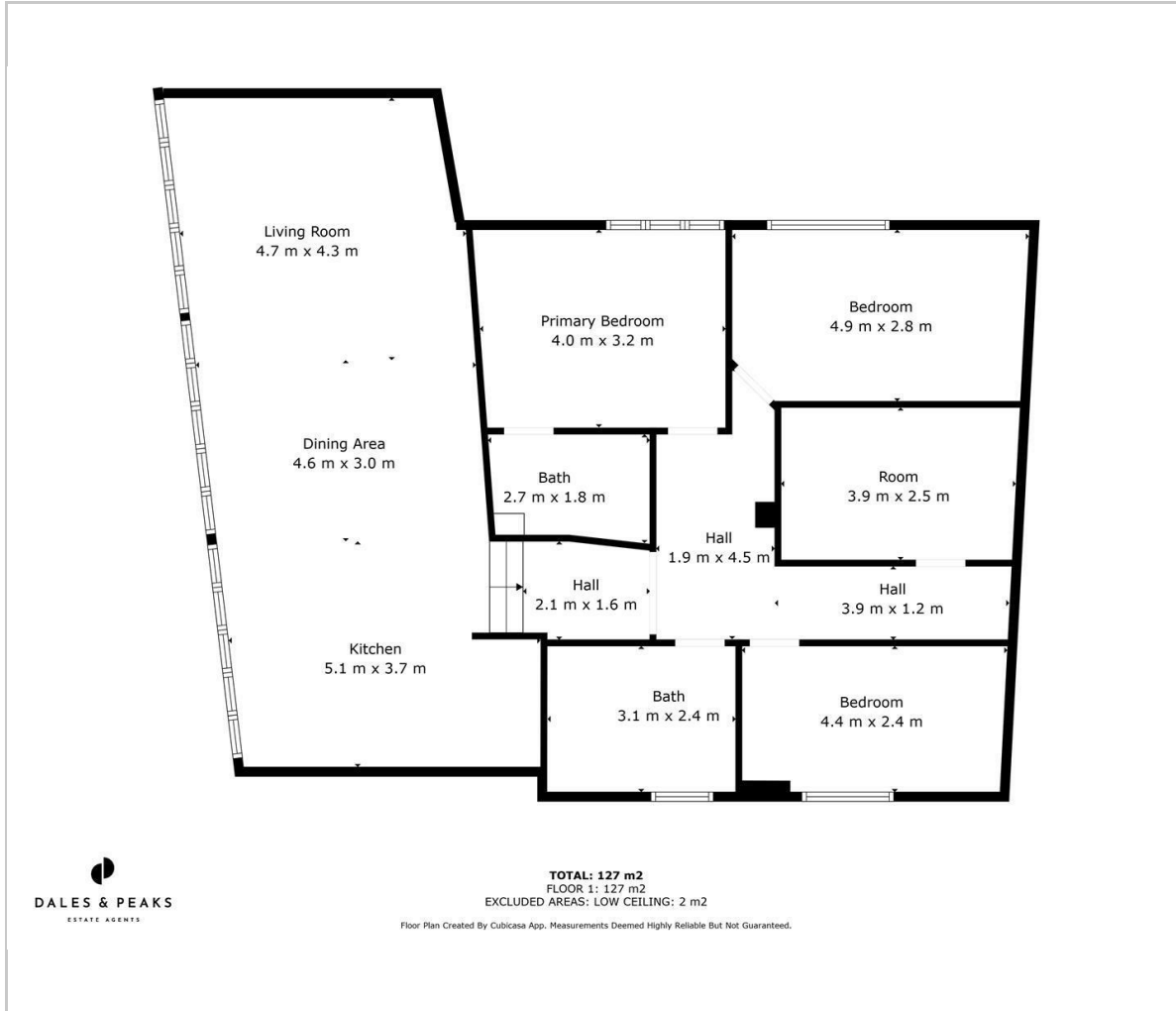

Viewing

Please contact our Chesterfield Office on 01246 567540 if you wish to arrange a viewing appointment for this property or require further information.

These particulars, whilst believed to be accurate are set out as a general outline only for guidance and do not constitute any part of an offer or contract. Intending purchasers should not rely on them as statements of representation of fact, but must satisfy themselves by inspection or otherwise as to their accuracy. No person in this firm's employment has the authority to make or give any representation or warranty in respect of the property.

Area Map

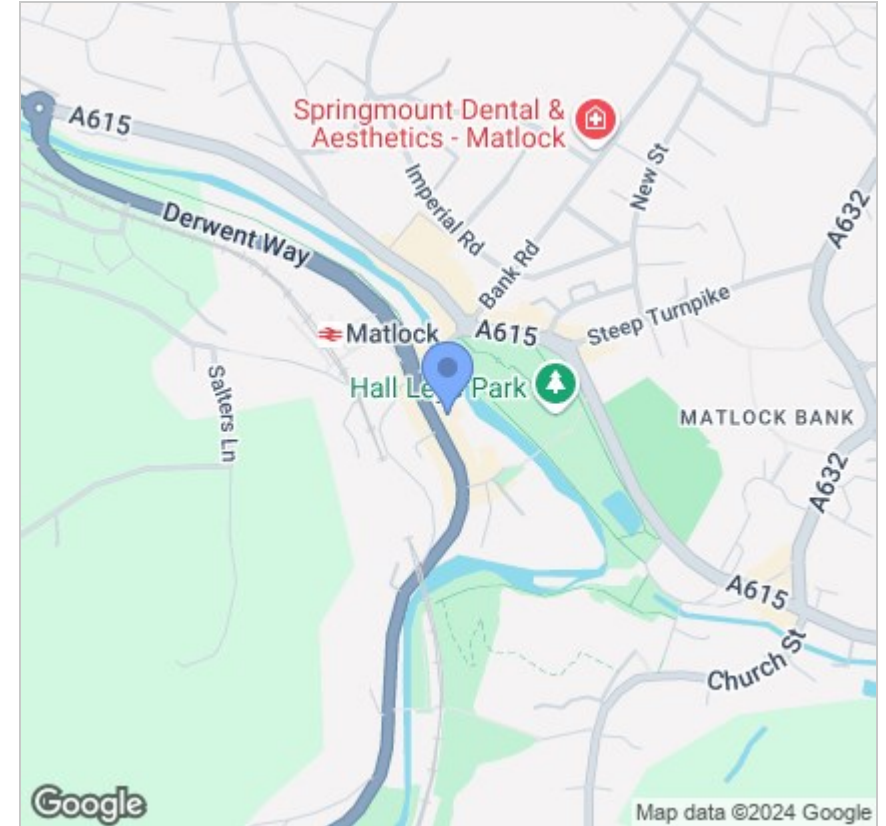

Energy Efficiency Graph

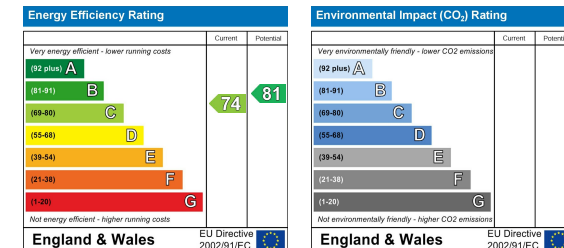

131 Chatsworth Road, Chesterfield, Derbyshire, S40 2AP
T: 01246 567540



E: info@dalesandpeaks.co.uk
www.dalesandpeaks.co.uk