



Rose Cottage Derby Road

Old Tupton, Chesterfield, S42 6LA

£500,000



Rose Cottage Derby Road

Old Tupton, Chesterfield, S42 6LA

£500,000 - £550,000 (Guide price)
Occupying a plot measuring approximately 0.4 acres, surrounded by stunning Derbyshire countryside on the outskirts of Chesterfield is this charming and characterful detached stone built property, presenting a unique opportunity to personalise and modernise throughout. Offering 2288 sqft of accommodation over 2 storeys, the property features 3 large reception rooms providing fantastic flexibility for family space and work-from-home space, breakfast kitchen with pantry, 5 bathrooms including 3 en-suites and a ground floor bathroom, generously proportioned bedrooms and ample off road parking with a large in-out driveway and adjoining double garage.





Floor Plan

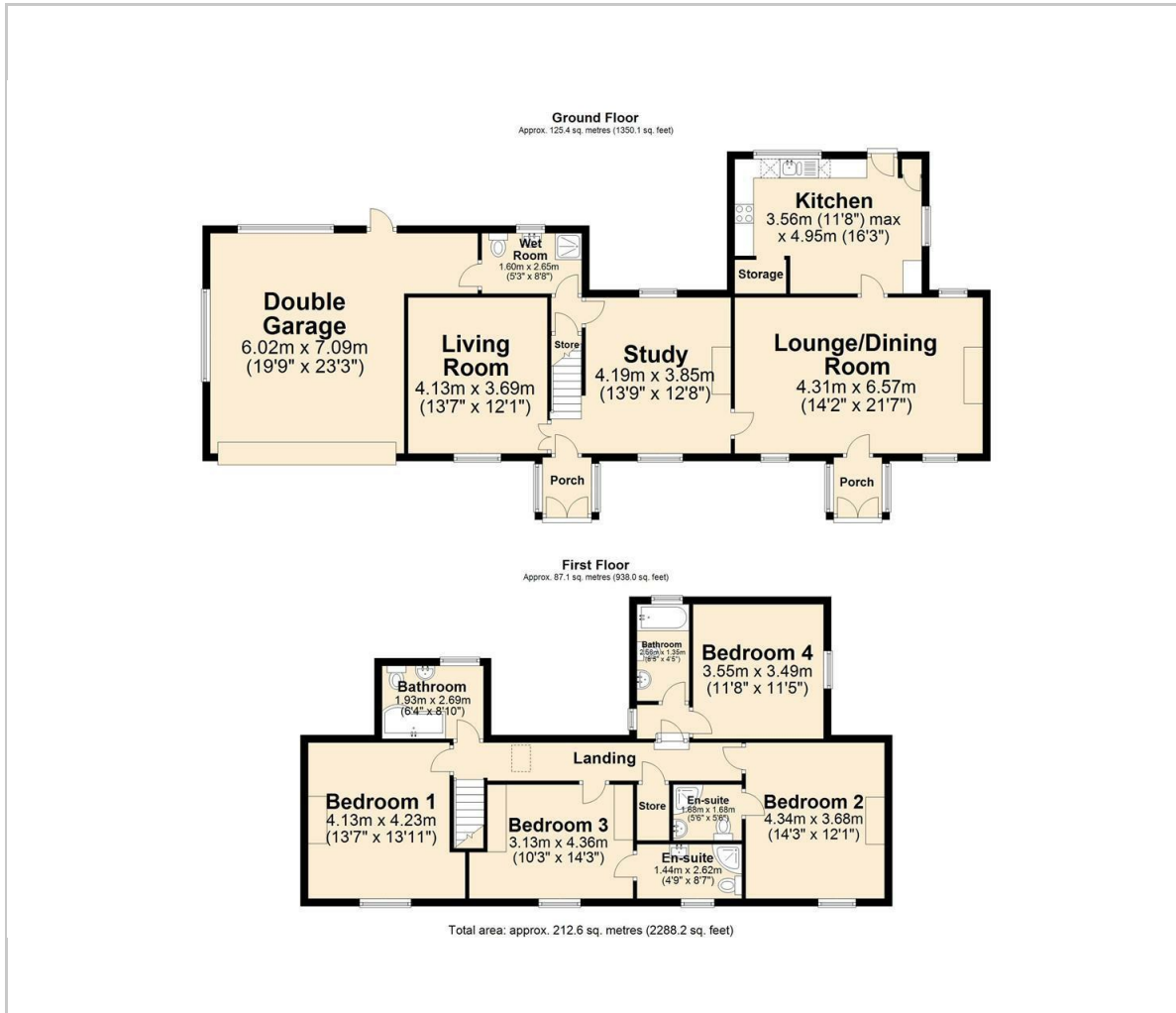

Viewing

Please contact our Chesterfield Office on 01246 567540 if you wish to arrange a viewing appointment for this property or require further information.

These particulars, whilst believed to be accurate are set out as a general outline only for guidance and do not constitute any part of an offer or contract. Intending purchasers should not rely on them as statements of representation of fact, but must satisfy themselves by inspection or otherwise as to their accuracy. No person in this firm's employment has the authority to make or give any representation or warranty in respect of the property.

Area Map



Energy Efficiency Graph

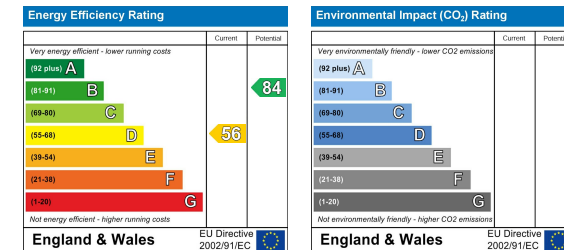

131 Chatsworth Road, Chesterfield, Derbyshire, S40 2AP
T: 01246 567540



E: info@dalesandpeaks.co.uk
www.dalesandpeaks.co.uk