



See More Online

KFB: Key Facts For Buyers

A Guide to This Property & the Local Area

Thursday 22nd January 2026

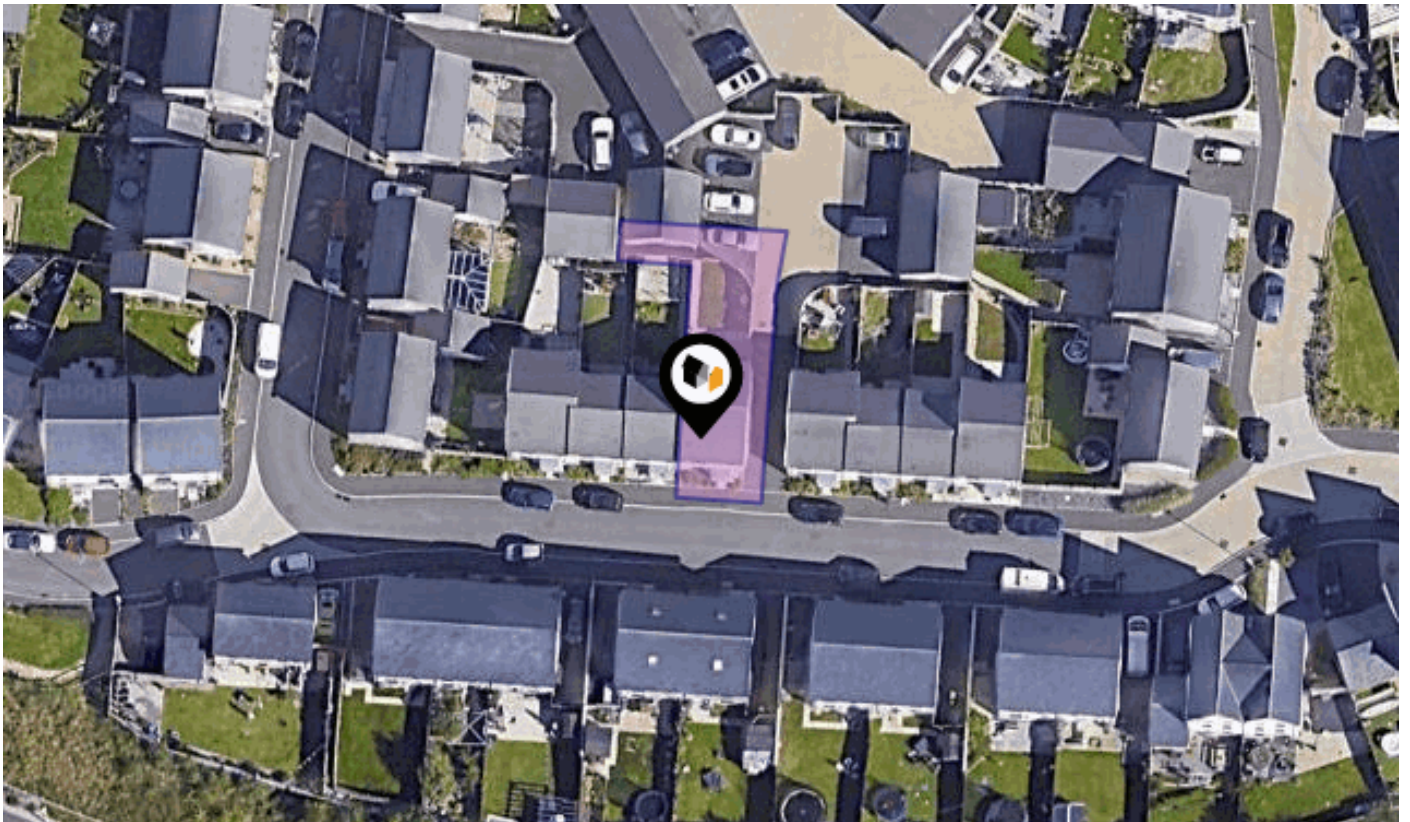

58, KILMAR STREET, PLYMOUTH, PL9 7FJ

6 Mannamead Road Plymouth Devon PL4 7AA

01752 256000

property@langtownandcountry.com

www.langtownandcountry.com

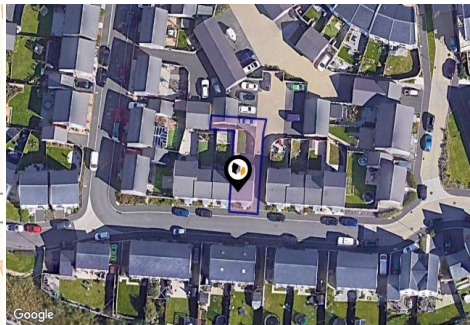
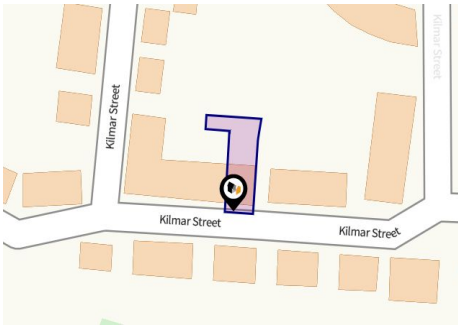

Property Overview



Property

Type:	Terraced	Last Sold Date:	11/12/2020
Bedrooms:	3	Last Sold Price:	£217,500
Floor Area:	861 ft ² / 80 m ²	Last Sold £/ft ² :	£252
Plot Area:	0.05 acres	Tenure:	Leasehold
Council Tax :	Band C	Start Date:	15/05/2017
Annual Estimate:	£2,067	End Date:	01/01/3014
Title Number:	DN684867	Lease Term:	999 years from 1 January 2015
UPRN:	10091561650	Term Remaining:	988 years

Local Area

Local Authority:	City of plymouth	Estimated Broadband Speeds		
Conservation Area:	No	(Standard - Superfast - Ultrafast)		
Flood Risk:		14	80	1800
• Rivers & Seas	Very low	mb/s	mb/s	mb/s
• Surface Water	Very low			

Mobile Coverage:
(based on calls indoors)



Satellite/Fibre TV Availability:



Property

Multiple Title Plans

Freehold Title Plan



DN441788

Leasehold Title Plan



DN684867

Start Date:	15/05/2017
End Date:	01/01/3014
Lease Term:	999 years from 1 January 2015
Term Remaining:	988 years

58, KILMAR STREET, PLYMOUTH, PL9 7FJ

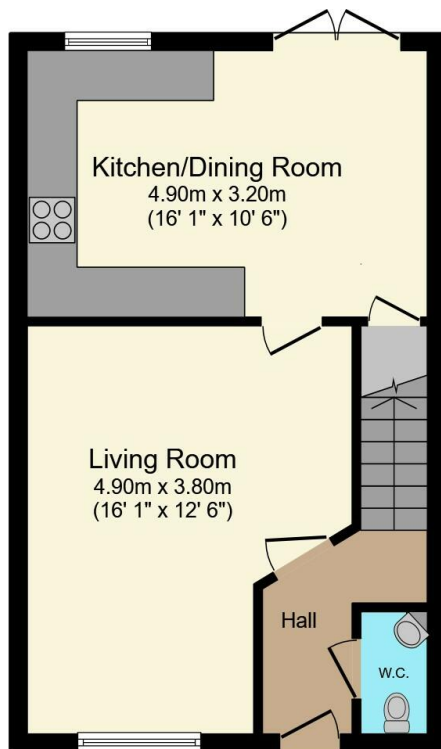

Ground Floor

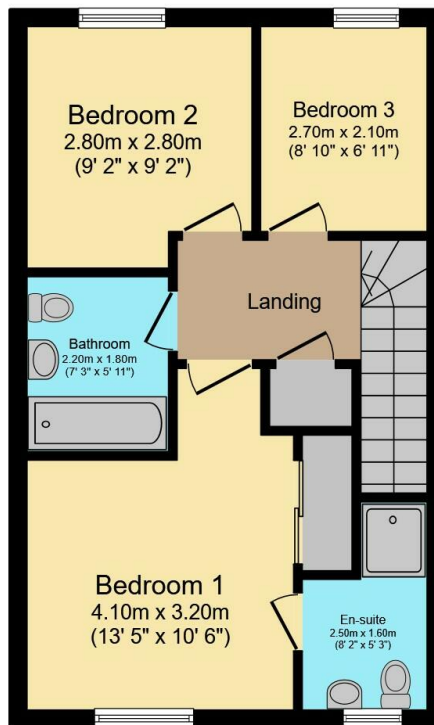

First Floor

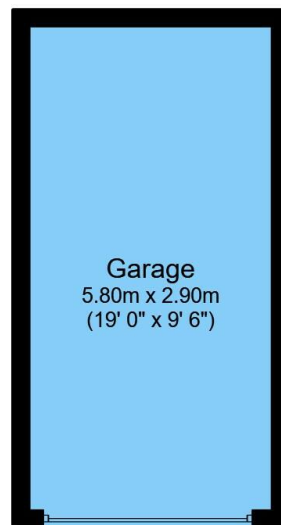

Garage

Total floor area 95.5 sq.m. (1,028 sq.ft.) approx

This floor plan is for illustrative purposes only. It is not drawn to scale. Any measurements, floor areas (including any total floor area), openings and orientation are approximate. No details are guaranteed, they cannot be relied upon for any purpose and they do not form part of any agreement. No liability is taken for any error, omission or misstatement. A party must rely upon its own inspection(s). Plan produced for Purplebricks. Powered by www.focalagent.com

Property

EPC - Certificate

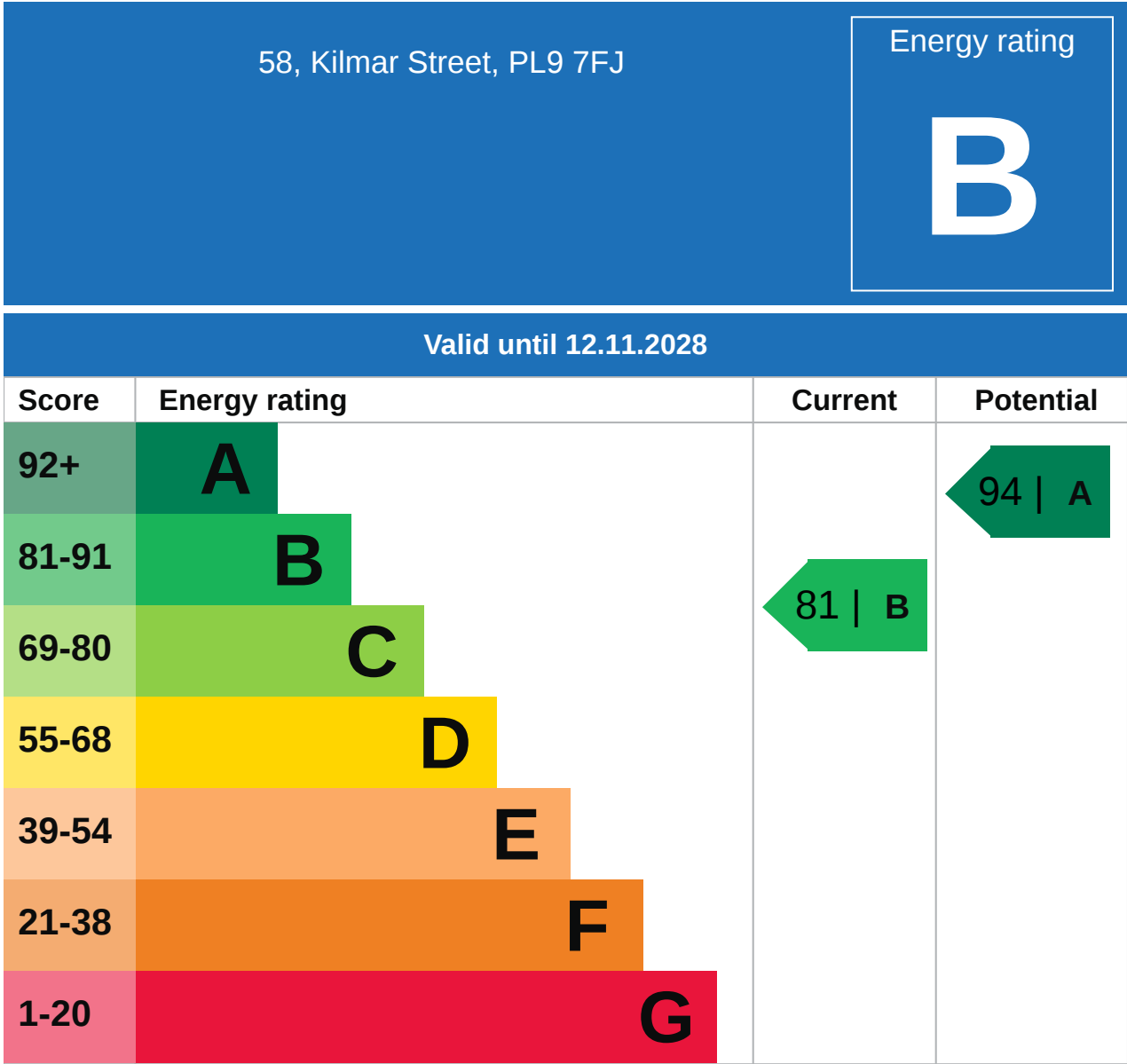

Property

EPC - Additional Data

Additional EPC Data

Property Type:	House
Build Form:	Semi-Detached
Transaction Type:	New dwelling
Energy Tariff:	Standard tariff
Main Fuel:	Mains gas - this is for backwards compatibility only and should not be used
Previous Extension:	0
Open Fireplace:	0
Walls:	Average thermal transmittance 0.29 W/m-Â°K
Walls Energy:	Very Good
Roof:	Average thermal transmittance 0.15 W/m-Â°K
Roof Energy:	Good
Main Heating:	Boiler and radiators, mains gas
Main Heating Controls:	Programmer, room thermostat and TRVs
Hot Water System:	From main system
Hot Water Energy Efficiency:	Good
Lighting:	Low energy lighting in 25% of fixed outlets
Floors:	Average thermal transmittance 0.19 W/m-Â°K
Total Floor Area:	80 m ²

Maps

Coal Mining

This map displays nearby coal mine entrances and their classifications.



Mine Entry

- ✕ Adit
- ✕ Gutter Pit
- ✕ Shaft

The Coal Authority has records of over 175,000 mine entries within the UK captured in the National Coal Mining database, derived from sources including abandonment plans, geological and topographical plans.

Coal mining activity is recorded as far back as the 13th century, but prior to 1872 there was no requirement to deposit abandonment plans. It is therefore believed there may be many unrecorded mine entries of which the Authority has no information or knowledge. These entries do not, therefore, appear within the Authority's national dataset as shown on this map.

Maps

Conservation Areas

This map displays nearby official conservation areas. Every local authority in England has at least one conservation area. Most are designated by the Council as the local planning authority, though Historic England and the Secretary of State also have the power to create them.

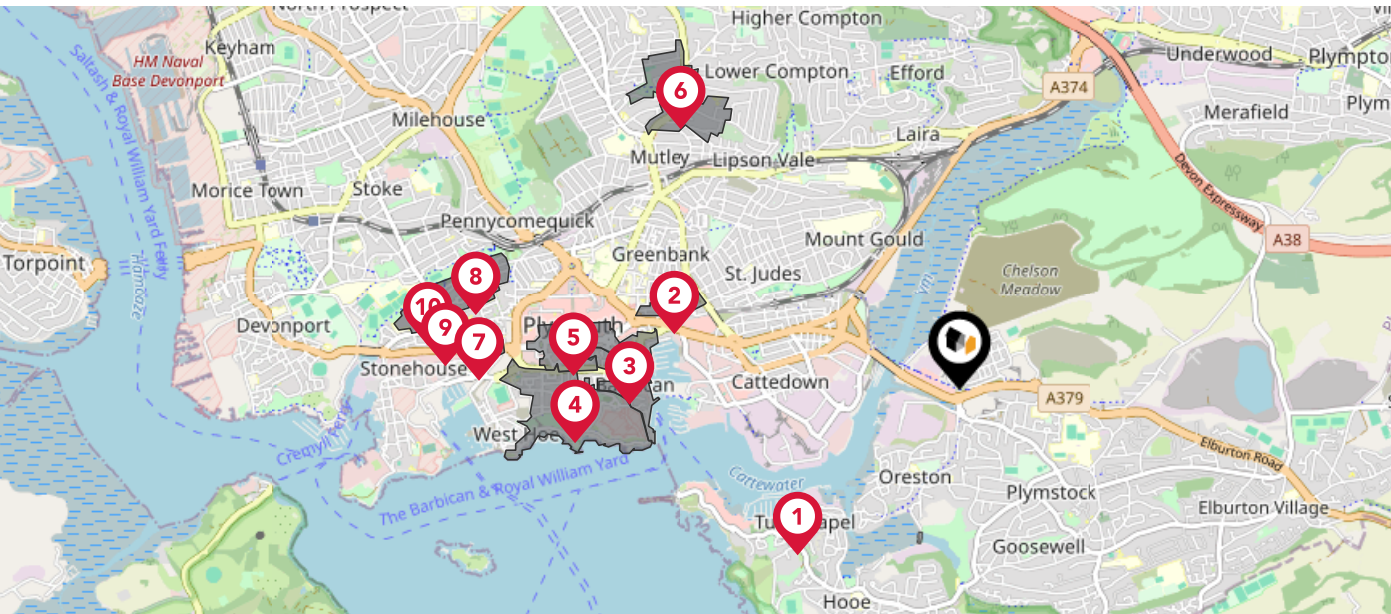

Nearby Conservation Areas	
1	Turnchapel
2	Ebrington Street
3	Barbican
4	The Hoe
5	City Centre
6	Mannamead
7	Union Street
8	North Stonehouse
9	Adelaide Street/Clarence Place
10	Royal Naval Hospital

Maps

Council Wards

The UK is divided into wards that are used for local elections to elect local government councillors. Sometimes these are known as 'electoral divisions'. Population counts can vary substantially between wards, but the national average is about 5,500

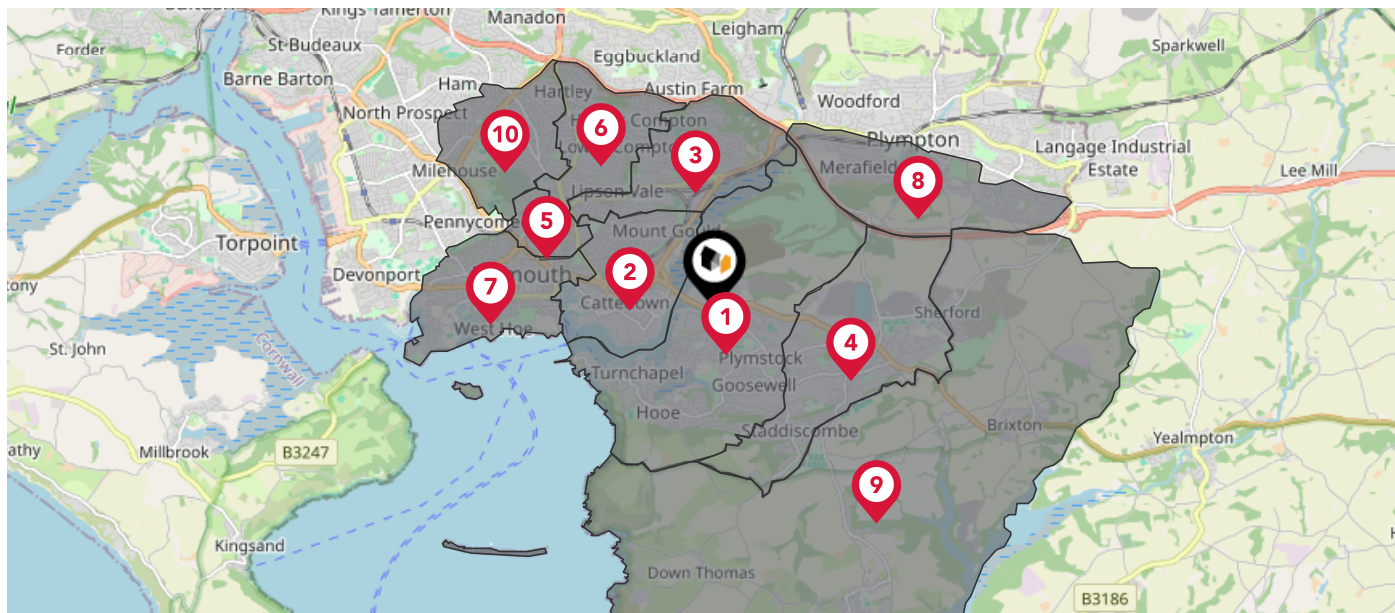

Nearby Council Wards

1

Plymstock Radford Ward

2

Sutton and Mount Gould Ward

3

Efford and Lipson Ward

4

Plymstock Dunstone Ward

5

Drake Ward

6

Compton Ward

7

St. Peter and the Waterfront Ward

8

Plympton Erle Ward

9

Wembury & Brixton Ward

10

Peverell Ward

Maps

Rail Noise

This map displays the noise levels from nearby network rail and HS1 railway routes that affect this property...

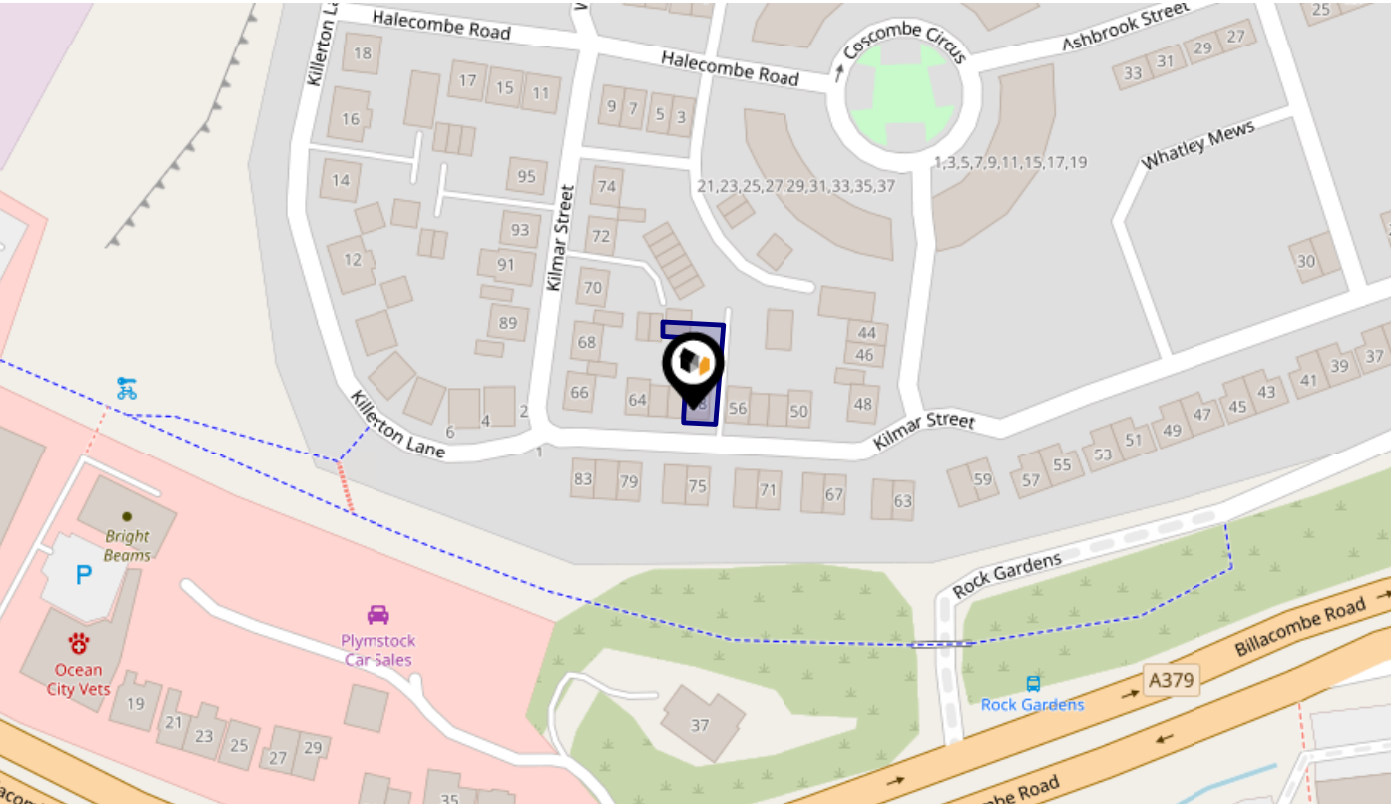

Rail Noise Data

This data indicates the level of noise according to the strategic noise mapping of rail sources within areas with a population of at least 100,000 people (agglomerations) and along Network Rail and HS1 traffic routes.

The data indicates the annual average noise levels for the 16-hour period between 0700 - 2300.

Noise levels are modelled on a 10m grid at a receptor height of 4m above ground, polygons are then produced by merging neighbouring cells within the following noise classes:

5	75.0+ dB	Red
4	70.0-74.9 dB	Orange
3	65.0-69.9 dB	Yellow
2	60.0-64.9 dB	Green
1	55.0-59.9 dB	Blue

Flood Risk

Rivers & Seas - Flood Risk

This map shows the chance of flooding from rivers and / or the sea, taking into account flood defences and their condition.

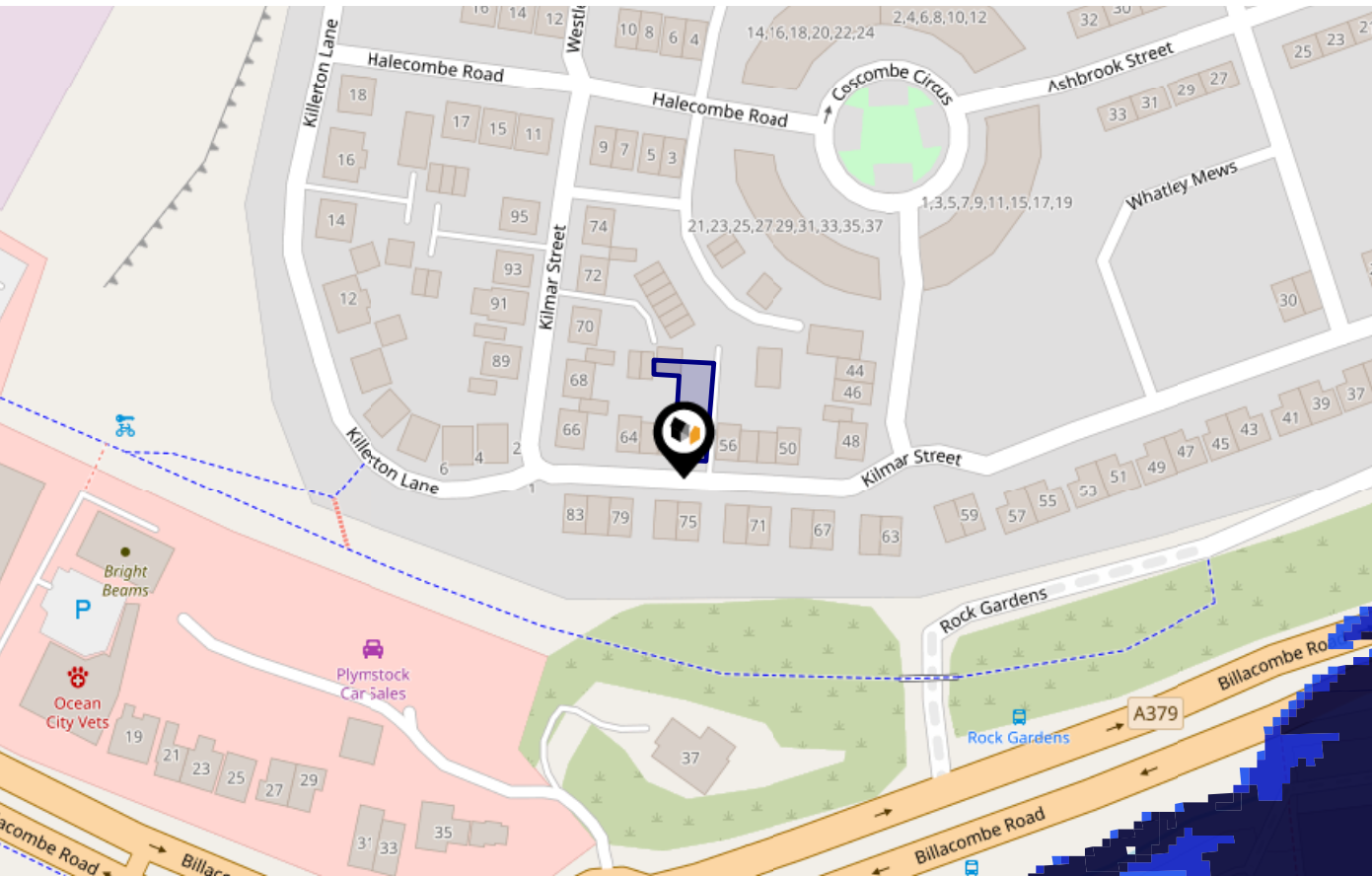

Risk Rating: Very low

The map does not contain sufficient information for it to be used to determine flood risk to individual properties, but it does give you an indication of whether your area may be affected by surface water flooding at this risk level.

- High Risk** - an area which has a chance of flooding of greater than 1 in 30 (3.3%) in any one year.
- Medium Risk** - an area which has a chance of flooding of greater than 1 in 100 (1.0%) in any one year.
- Low Risk** - an area which has a chance of flooding of greater than 1 in 1000 (0.1%) in any one year.
- Very Low Risk** - an area in which the risk is below 1 in 1000 (0.1%) in any one year.

Chance of flooding to the following depths at this property:

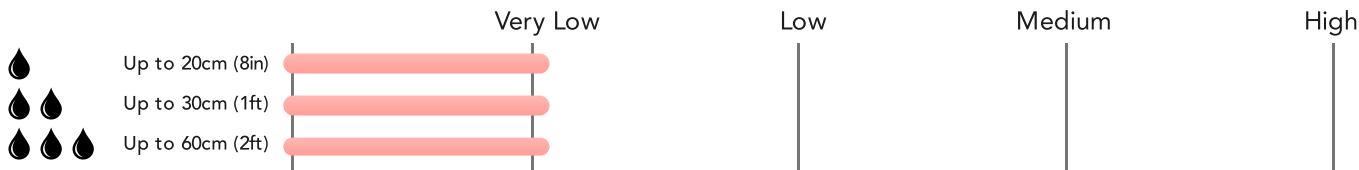

Flood Risk

Rivers & Seas - Climate Change

This map shows the future chance of flooding from rivers and / or the sea **between 2036 and 2069**, taking into account flood defences and their condition. The government climate change models cannot predict exactly when the chance of flooding will go up. It could happen at any time during the time period.

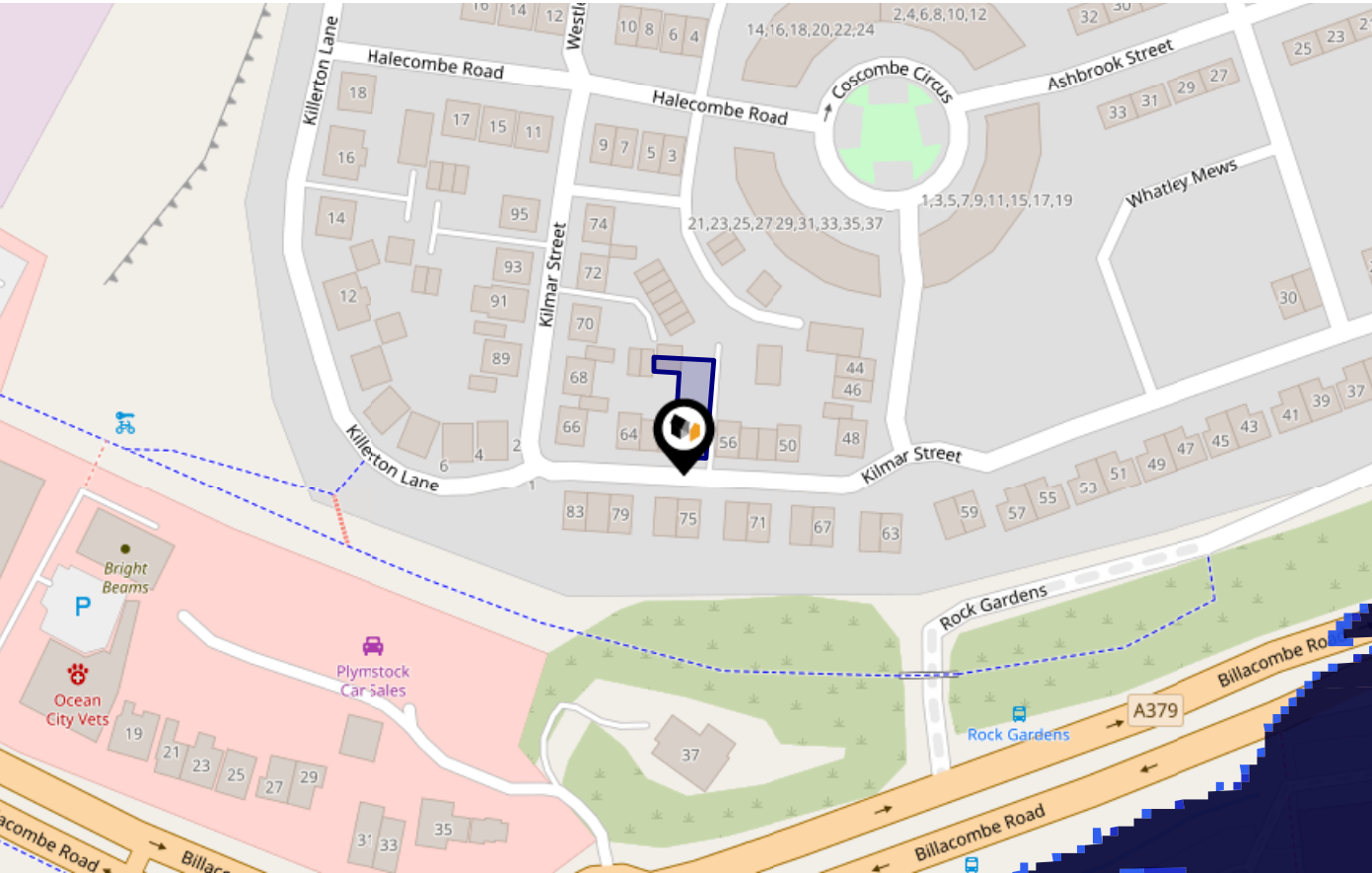

Risk Rating: Very low

The map does not contain sufficient information for it to be used to determine flood risk to individual properties, but it does give you an indication of whether your area may be affected by surface water flooding at this risk level.

- High Risk** - an area which has a chance of flooding of greater than 1 in 30 (3.3%) in any one year.
- Medium Risk** - an area which has a chance of flooding of greater than 1 in 100 (1.0%) in any one year.
- Low Risk** - an area which has a chance of flooding of greater than 1 in 1000 (0.1%) in any one year.
- Very Low Risk** - an area in which the risk is below 1 in 1000 (0.1%) in any one year.

Chance of flooding to the following depths at this property:

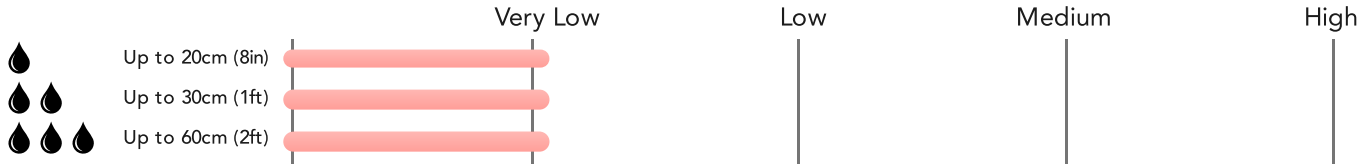

Flood Risk

Surface Water - Flood Risk

This map shows the chance of flooding where rainwater has nowhere to drain. This kind of flooding can occur far from rivers or seas.

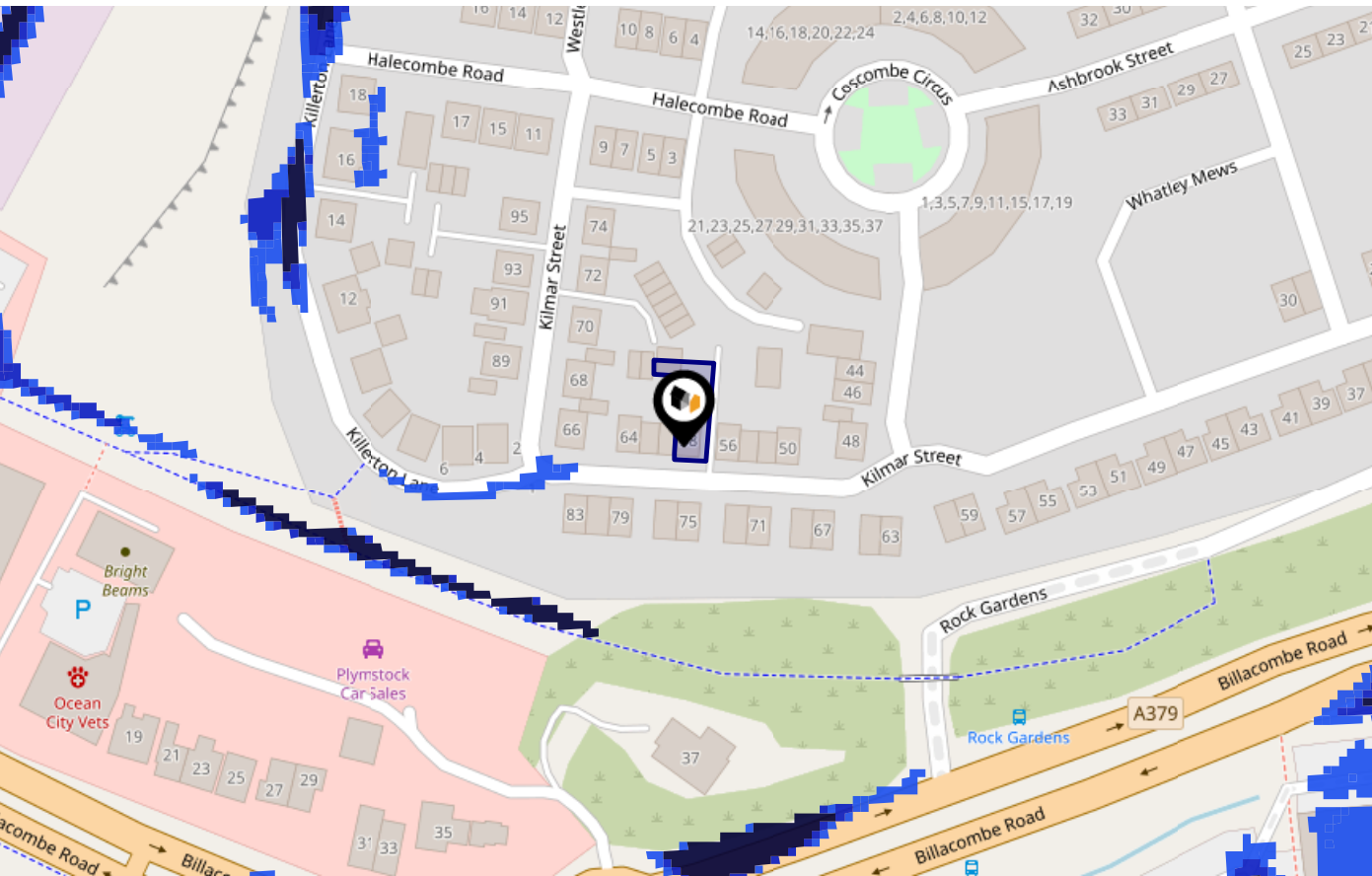

Risk Rating: Very low

The map does not contain sufficient information for it to be used to determine flood risk to individual properties, but it does give you an indication of whether your area may be affected by surface water flooding at this risk level.

- High Risk** - an area which has a chance of flooding of greater than 1 in 30 (3.3%) in any one year.
- Medium Risk** - an area which has a chance of flooding of greater than 1 in 100 (1.0%) in any one year.
- Low Risk** - an area which has a chance of flooding of greater than 1 in 1000 (0.1%) in any one year.
- Very Low Risk** - an area in which the risk is below 1 in 1000 (0.1%) in any one year.

Chance of flooding to the following depths at this property:

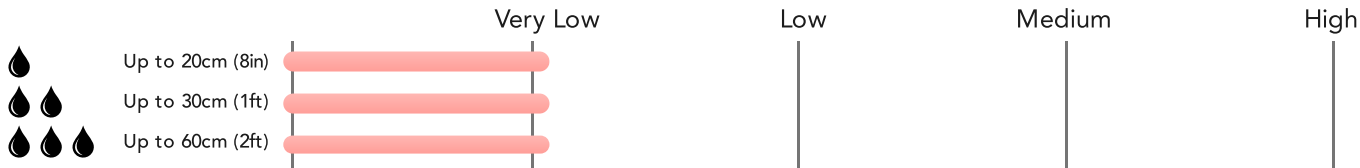

Flood Risk

Surface Water - Climate Change

This map shows the future chance of flooding **between 2040 and 2060** where rainwater has nowhere to drain. This kind of flooding can occur far from rivers or seas. The government climate change models cannot predict exactly when the chance of flooding will go up. It could happen at any time during the time period.

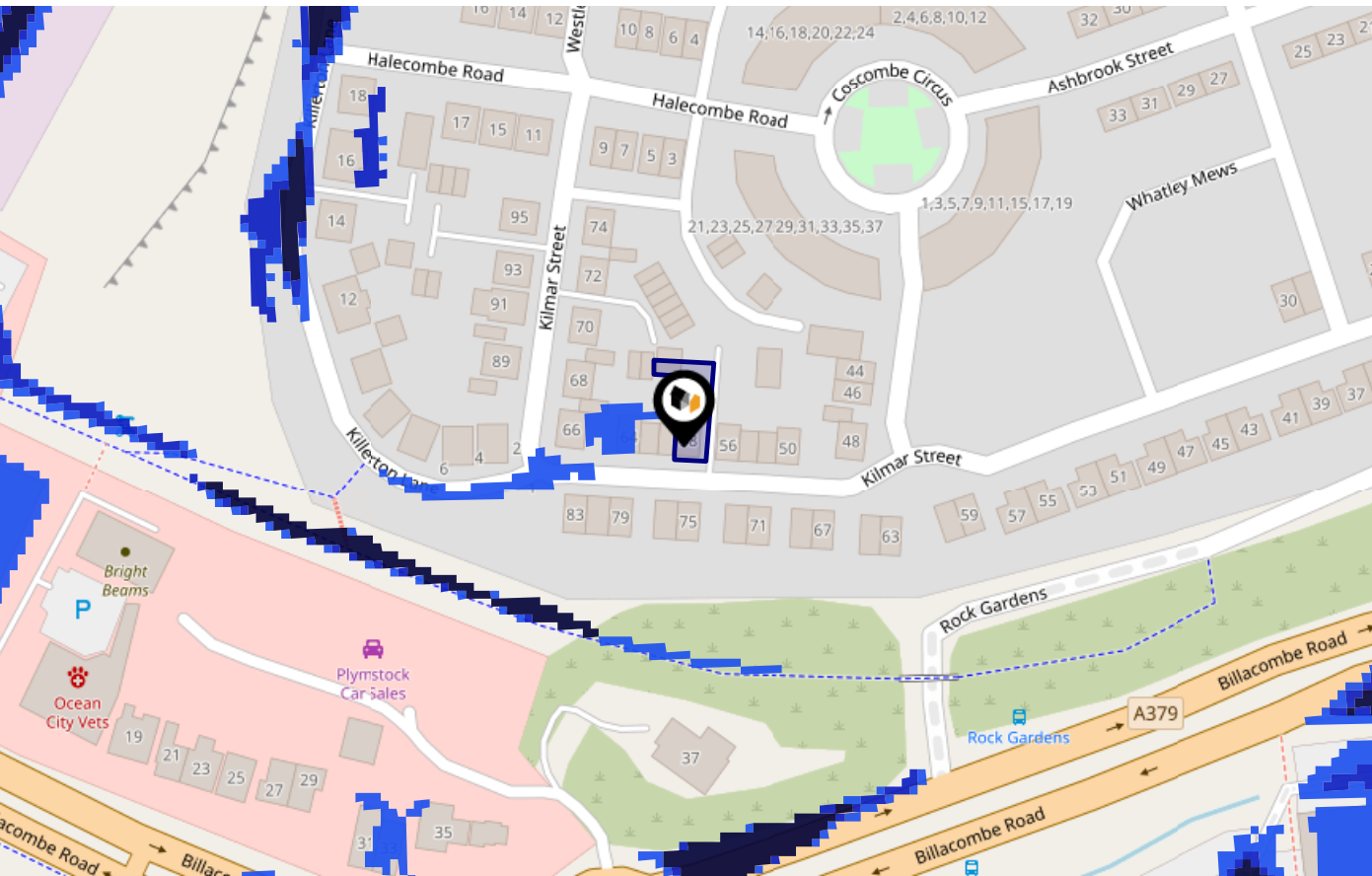

Risk Rating: Very low

The map does not contain sufficient information for it to be used to determine flood risk to individual properties, but it does give you an indication of whether your area may be affected by surface water flooding at this risk level.

- High Risk** - an area which has a chance of flooding of greater than 1 in 30 (3.3%) in any one year.
- Medium Risk** - an area which has a chance of flooding of greater than 1 in 100 (1.0%) in any one year.
- Low Risk** - an area which has a chance of flooding of greater than 1 in 1000 (0.1%) in any one year.
- Very Low Risk** - an area in which the risk is below 1 in 1000 (0.1%) in any one year.

Chance of flooding to the following depths at this property:

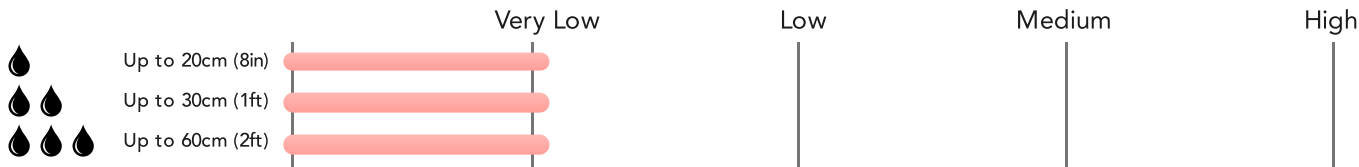

Maps

Green Belt

This map displays nearby areas that have been designated as Green Belt...

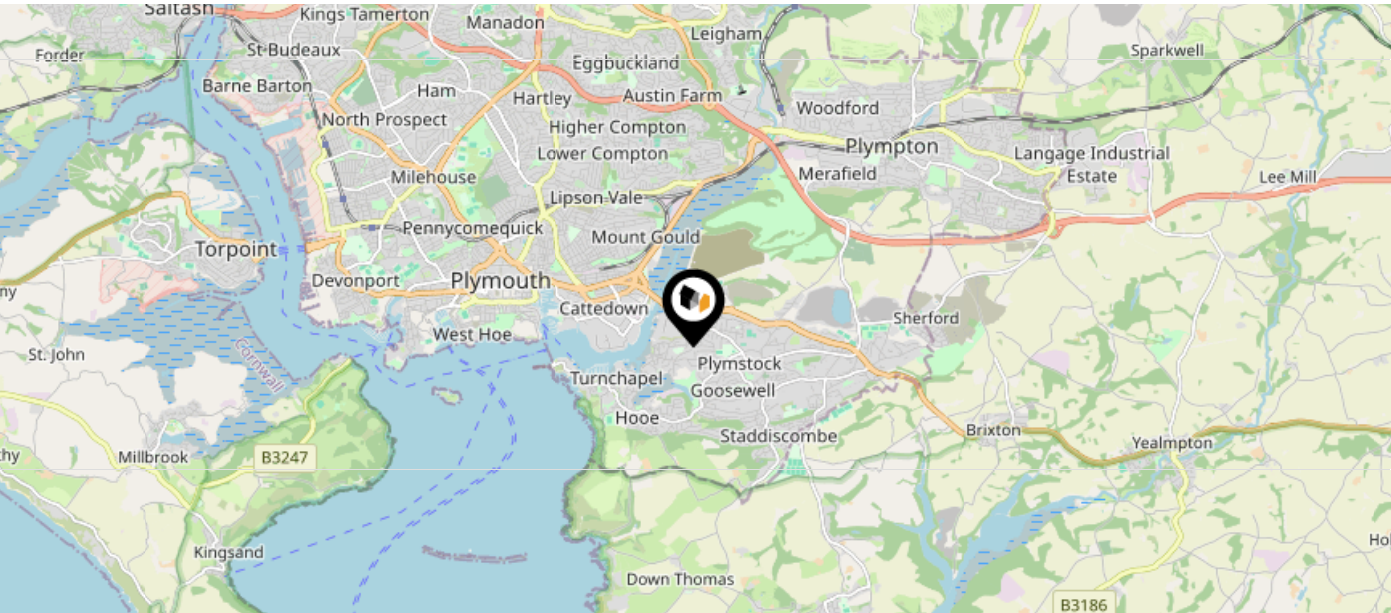

Nearby Green Belt Land

No data available.

Maps

Landfill Sites

This map displays the location of known landfill sites. Historic sites are where there is no environmental permit in force. Active sites are currently authorised by the Environment Agency under Environmental Permitting Regulations.

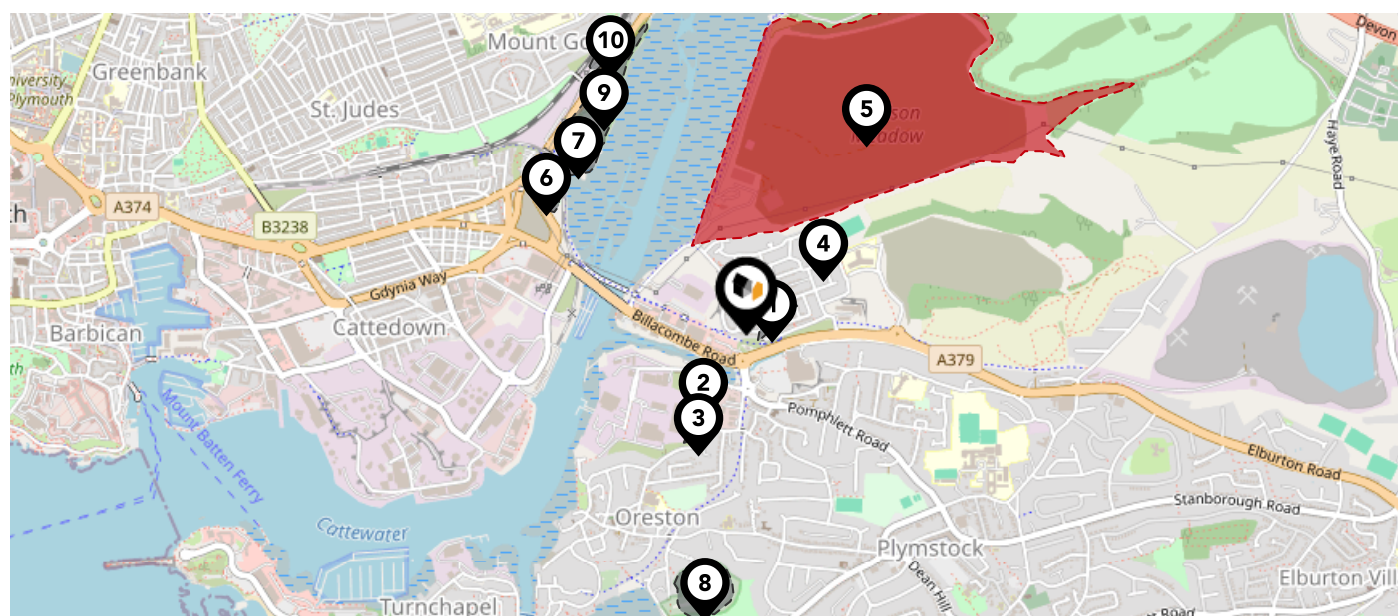

Nearby Landfill Sites

1	Former Warkham Quarry-Pomphlett, Plymouth	Historic Landfill	
2	Bedford Quarry Oreston A-Oreston, Plymouth	Historic Landfill	
3	Bedford Quarry Oreston B-Oreston, Plymouth	Historic Landfill	
4	Plymstock Works-Plymstock Works, Plymstock, Plymouth, Devon	Historic Landfill	
5	EA/EPR/EP3096HZ/V002	Active Landfill	
6	Cattedown Junction Playing Field-Embankment Road, Plymouth	Historic Landfill	
7	Blagdons Shipyard-Embankment Road Lane, Laira, Plymouth	Historic Landfill	
8	Radford Quarry Oreston-Radford Quarry Oreston, Plymouth	Historic Landfill	
9	Embankment Road-Laira, Plymouth	Historic Landfill	
10	Allotments Embankment Road-Laira, Plymouth	Historic Landfill	

Maps

Listed Buildings

This map displays nearby listed buildings and protected structures, as well as their listed tier and distance from the target property...

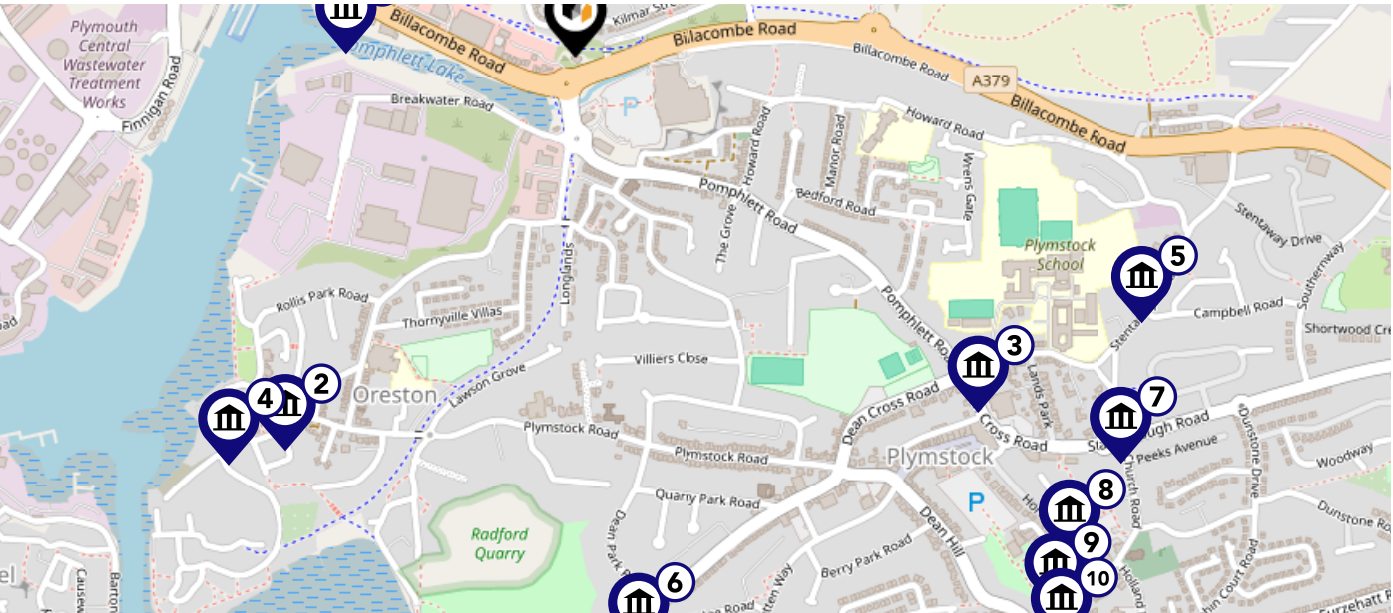

Listed Buildings in the local district		Grade	Distance
	1322011 - The Morley Arms Public House	Grade II	0.3 miles
	1386332 - 160 And 162, Plymstock Road	Grade II	0.6 miles
	1130041 - Burrow Lodge	Grade II	0.6 miles
	1386313 - Park Cottage	Grade II	0.6 miles
	1386417 - Stentaway House	Grade II	0.7 miles
	1386349 - Radford Lodge And Gate Piers	Grade II	0.7 miles
	1130042 - Elmleigh	Grade II	0.8 miles
	1321998 - Glendene And Eventide	Grade II	0.8 miles
	1321997 - Downhorn Farmhouse	Grade II	0.9 miles
	1130044 - Marchant House	Grade II	0.9 miles



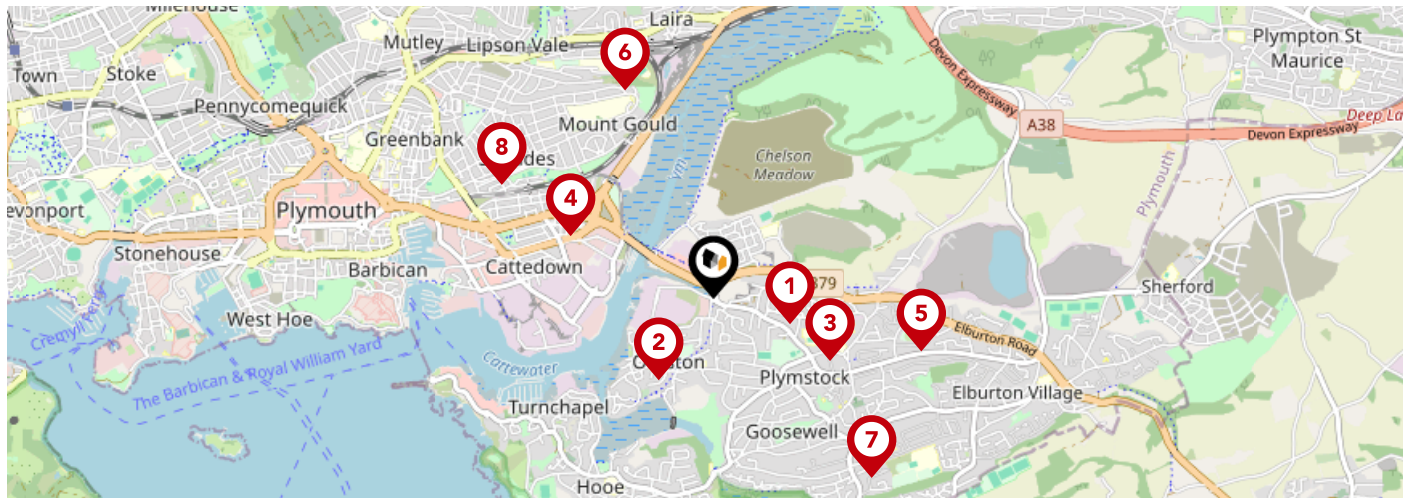



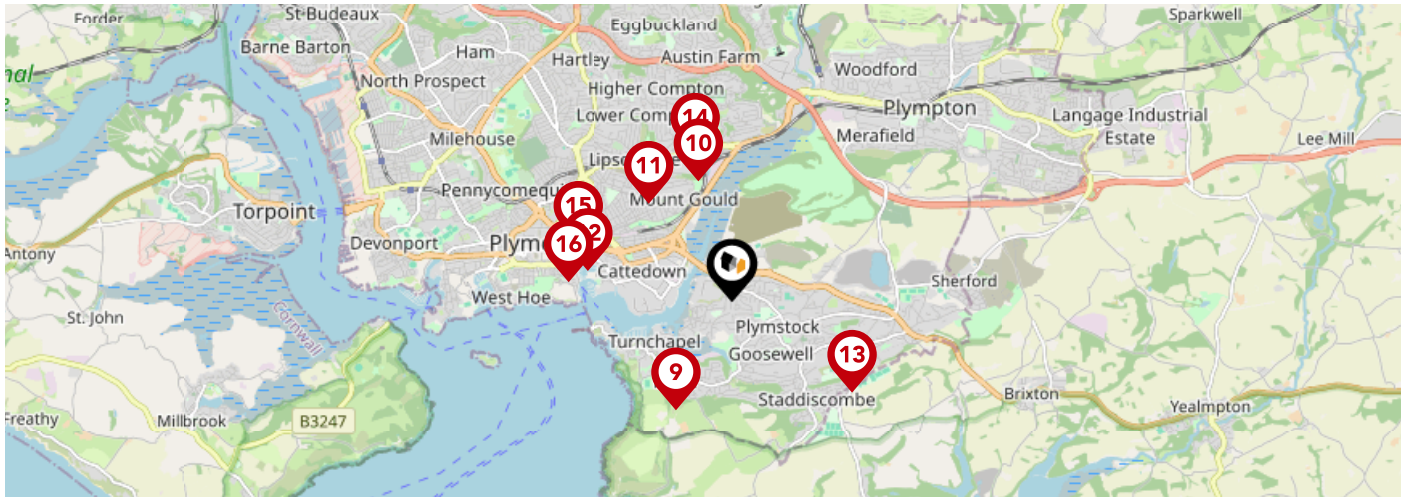

Area Schools



		Nursery	Primary	Secondary	College	Private
1	Pomphlett Primary School Ofsted Rating: Good Pupils: 424 Distance:0.38	<input type="checkbox"/>	<input checked="" type="checkbox"/>	<input type="checkbox"/>	<input type="checkbox"/>	<input type="checkbox"/>
2	Oreston Community Academy Ofsted Rating: Good Pupils: 419 Distance:0.46	<input type="checkbox"/>	<input checked="" type="checkbox"/>	<input type="checkbox"/>	<input type="checkbox"/>	<input type="checkbox"/>
3	Plymstock School Ofsted Rating: Good Pupils: 1671 Distance:0.63	<input type="checkbox"/>	<input type="checkbox"/>	<input checked="" type="checkbox"/>	<input type="checkbox"/>	<input type="checkbox"/>
4	Prince Rock Primary School Ofsted Rating: Outstanding Pupils: 408 Distance:0.74	<input type="checkbox"/>	<input checked="" type="checkbox"/>	<input type="checkbox"/>	<input type="checkbox"/>	<input type="checkbox"/>
5	Morley Meadow Primary School Ofsted Rating: Good Pupils: 224 Distance:1.01	<input type="checkbox"/>	<input checked="" type="checkbox"/>	<input type="checkbox"/>	<input type="checkbox"/>	<input type="checkbox"/>
6	Lipson Co-operative Academy Ofsted Rating: Good Pupils: 1102 Distance:1.07	<input type="checkbox"/>	<input type="checkbox"/>	<input checked="" type="checkbox"/>	<input type="checkbox"/>	<input type="checkbox"/>
7	Goosewell Primary Academy Ofsted Rating: Good Pupils: 419 Distance:1.13	<input type="checkbox"/>	<input checked="" type="checkbox"/>	<input type="checkbox"/>	<input type="checkbox"/>	<input type="checkbox"/>
8	Salisbury Road Primary School Ofsted Rating: Good Pupils: 381 Distance:1.14	<input type="checkbox"/>	<input checked="" type="checkbox"/>	<input type="checkbox"/>	<input type="checkbox"/>	<input type="checkbox"/>

Area Schools



		Nursery	Primary	Secondary	College	Private
	Hooe Primary Academy Ofsted Rating: Good Pupils: 212 Distance: 1.15	<input type="checkbox"/>	<input checked="" type="checkbox"/>	<input type="checkbox"/>	<input type="checkbox"/>	<input type="checkbox"/>
	Laira Green Primary School Ofsted Rating: Good Pupils: 230 Distance: 1.18	<input type="checkbox"/>	<input checked="" type="checkbox"/>	<input type="checkbox"/>	<input type="checkbox"/>	<input type="checkbox"/>
	Lipson Vale Primary School Ofsted Rating: Good Pupils: 405 Distance: 1.22	<input type="checkbox"/>	<input checked="" type="checkbox"/>	<input type="checkbox"/>	<input type="checkbox"/>	<input type="checkbox"/>
	Holy Cross Catholic Primary School Ofsted Rating: Good Pupils: 306 Distance: 1.39	<input type="checkbox"/>	<input checked="" type="checkbox"/>	<input type="checkbox"/>	<input type="checkbox"/>	<input type="checkbox"/>
	Coombe Dean School Ofsted Rating: Good Pupils: 995 Distance: 1.41	<input type="checkbox"/>	<input type="checkbox"/>	<input checked="" type="checkbox"/>	<input type="checkbox"/>	<input type="checkbox"/>
	High View School Ofsted Rating: Outstanding Pupils: 356 Distance: 1.44	<input type="checkbox"/>	<input checked="" type="checkbox"/>	<input type="checkbox"/>	<input type="checkbox"/>	<input type="checkbox"/>
	Mount Street Primary School Ofsted Rating: Good Pupils: 258 Distance: 1.56	<input type="checkbox"/>	<input checked="" type="checkbox"/>	<input type="checkbox"/>	<input type="checkbox"/>	<input type="checkbox"/>
	ACE Schools Plymouth Ofsted Rating: Good Pupils: 233 Distance: 1.56	<input type="checkbox"/>	<input type="checkbox"/>	<input checked="" type="checkbox"/>	<input type="checkbox"/>	<input type="checkbox"/>

Local Area

Masts & Pylons

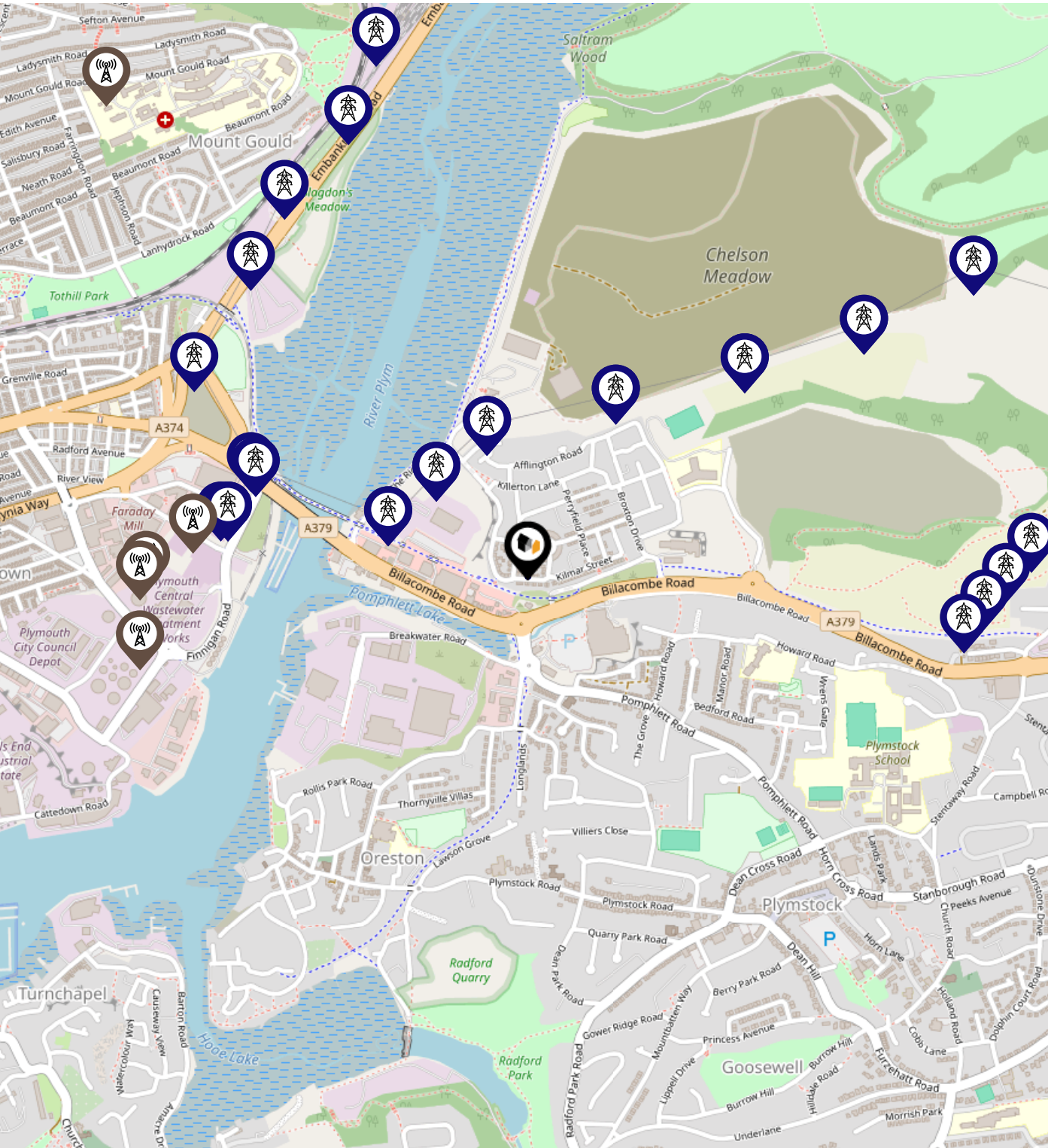

- Key:**
-  Power Pylons
 -  Communication Masts

Environment

Radon Gas

What is Radon?

Radon is a natural radioactive gas, which enters buildings from the ground. Exposure to high concentrations increases the risk of lung cancer. The UK Health Security Agency (UKHSA) recommends that radon levels should be reduced in homes where the annual average is at or above 200 becquerels per cubic metre (200 Bq/m3).

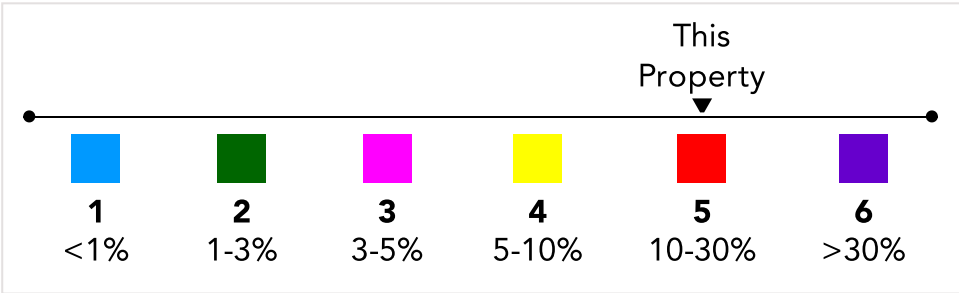
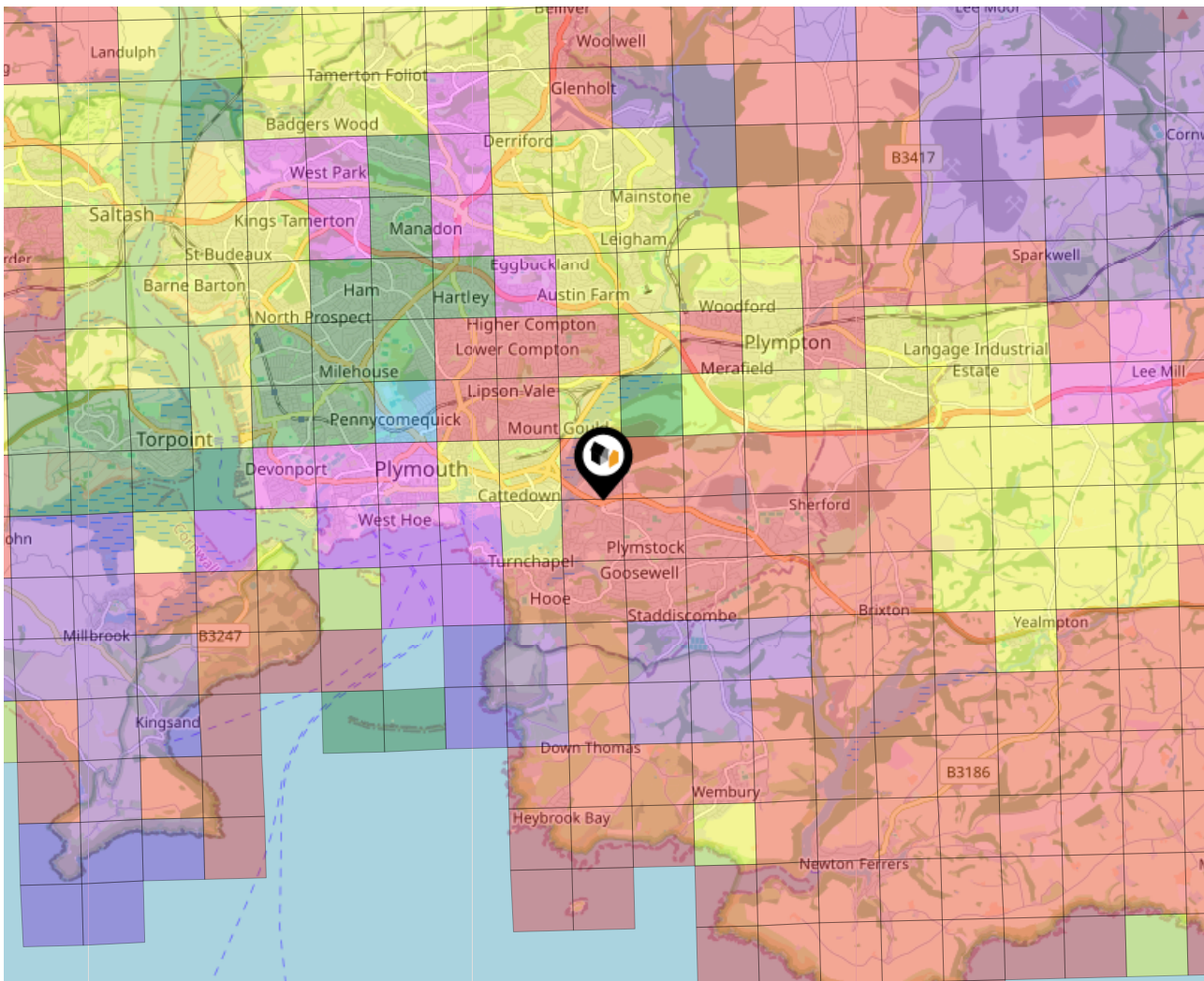

Local Area

Road Noise

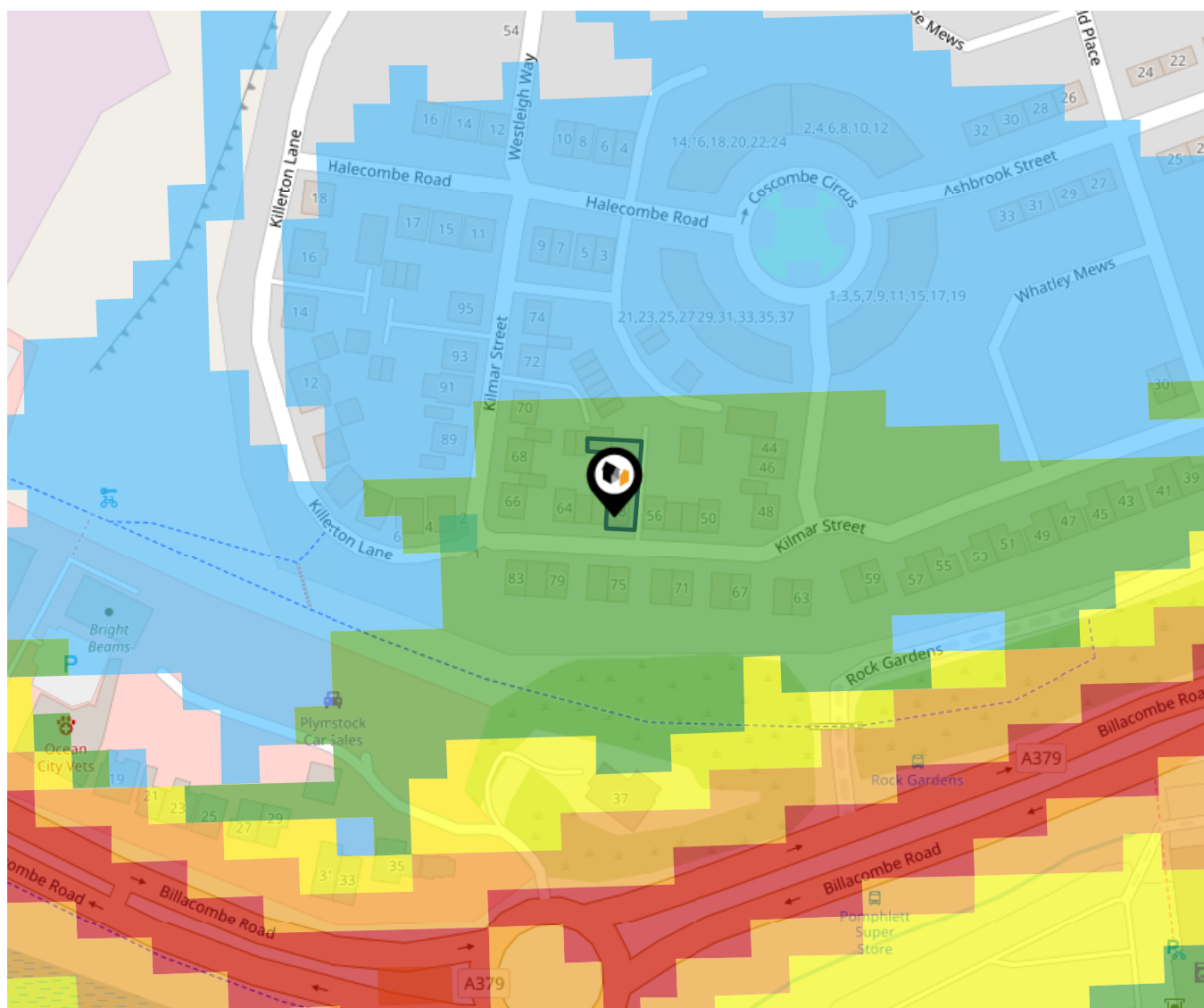

This data indicates the level of noise according to the strategic noise mapping of road sources within areas with a population of at least 100,000 people (agglomerations) and along major traffic routes. This indicates a 24 hour annual average noise level with separate weightings for the evening and night periods.

Noise levels are modelled on a 10m grid at a receptor height of 4m above ground, polygons are then produced by merging neighbouring cells within the following noise classes:

- 75.0+ dB
- 70.0-74.9 dB
- 65.0-69.9 dB
- 60.0-64.9 dB
- 55.0-59.9 dB

Ground Composition for this Address (Surrounding square kilometer zone around property)

Carbon Content:	NONE	Soil Texture:	LOAM TO SILTY LOAM
Parent Material Grain:	ARGILLACEOUS	Soil Depth:	INTERMEDIATE-SHALLOW
Soil Group:	MEDIUM TO LIGHT(SILTY) TO HEAVY		

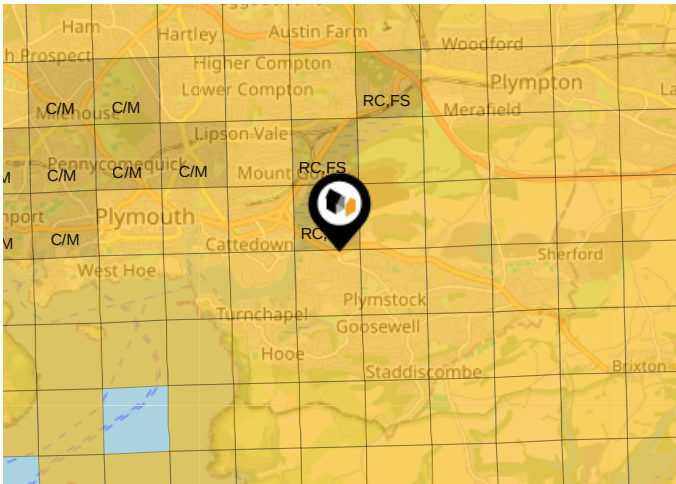

Primary Classifications (Most Common Clay Types)

C/M	Claystone / Mudstone
FPC,S	Floodplain Clay, Sand / Gravel
FC,S	Fluvial Clays & Silts
FC,S,G	Fluvial Clays, Silts, Sands & Gravel
PM/EC	Prequaternary Marine / Estuarine Clay / Silt
QM/EC	Quaternary Marine / Estuarine Clay / Silt
RC	Residual Clay
RC/LL	Residual Clay & Loamy Loess
RC,S	River Clay & Silt
RC,FS	Riverine Clay & Floodplain Sands and Gravel
RC,FL	Riverine Clay & Fluvial Sands and Gravel
TC	Terrace Clay
TC/LL	Terrace Clay & Loamy Loess

Area

Transport (National)

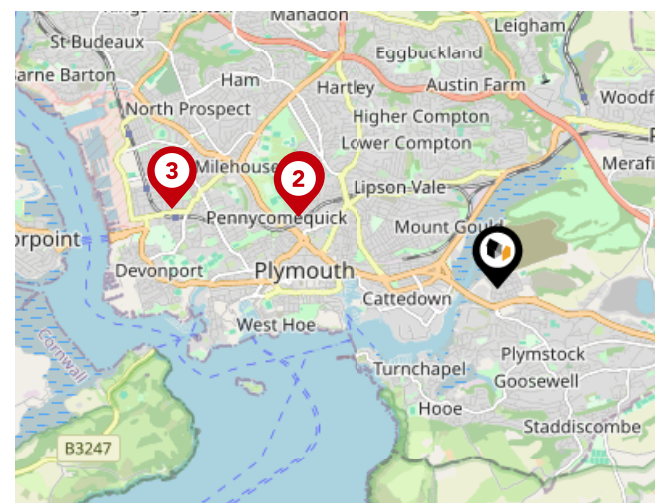

National Rail Stations

Pin	Name	Distance
1	Plymouth Rail Station	2 miles
2	Plymouth Rail Station	2.01 miles
3	Devonport Rail Station	3.17 miles

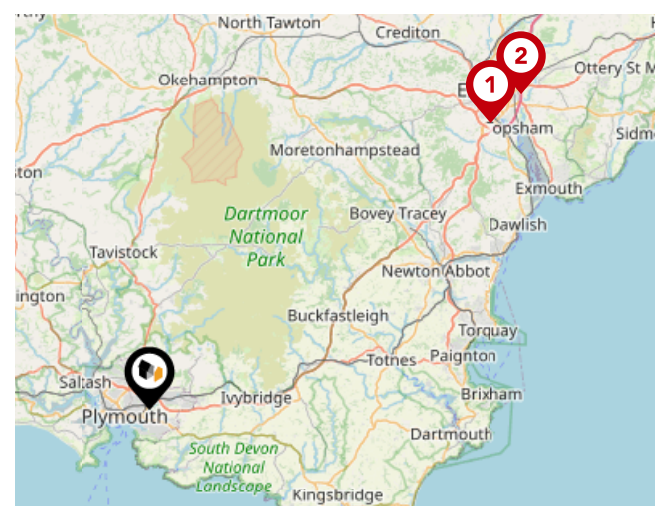

Trunk Roads/Motorways

Pin	Name	Distance
1	M5 J31	33.63 miles
2	M5 J30	36.79 miles

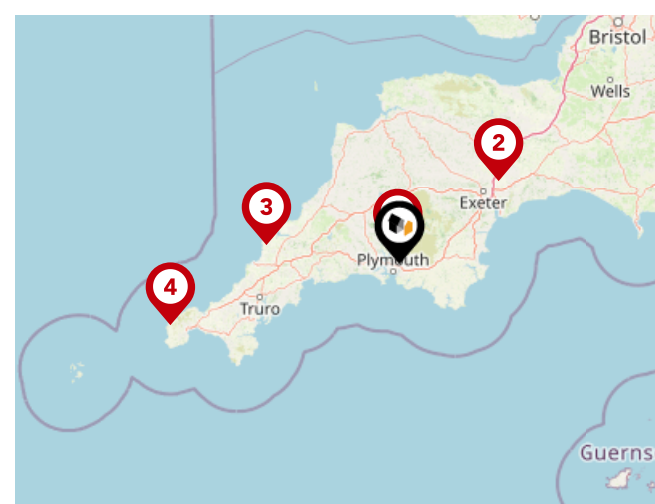

Airports/Helipads

Pin	Name	Distance
1	Glenholt	3.82 miles
2	Exeter Airport	39.21 miles
3	St Mawgan	40.25 miles
4	Joppa	71.7 miles

Area

Transport (Local)



Bus Stops/Stations

Pin	Name	Distance
1	Halecombe Road	0.05 miles
2	Rock Gardens	0.07 miles
3	Pomphlett Superstore	0.08 miles
4	Pomphlett Roundabout	0.16 miles
5	The Ride	0.16 miles

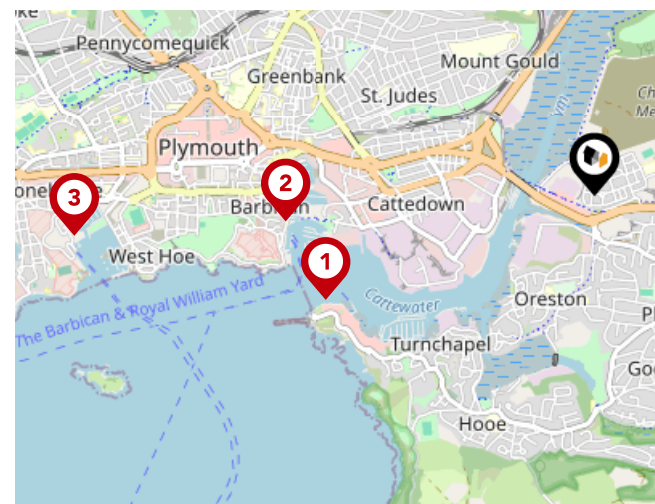

Ferry Terminals

Pin	Name	Distance
1	Plymouth Mount Batten Ferry Landing	1.37 miles
2	Plymouth (Barbican) Landing Stage	1.47 miles
3	Plymouth Ferry Terminal	2.47 miles

Data Quality

We are committed to comprehensive property data being made available upfront to make the home buying and selling process quicker, easier and cheaper. This is why we have partnered with Sprift, the UK's leading supplier of property-specific data.



Contains public sector information licensed under the Open Government License v3.0

The information contained within this report is for general information purposes only.

Sprift Technologies Ltd aggregate this data from a wide variety of sources and while we endeavour to keep the information up to date and correct, we make no representations or warranties of any kind, express or implied, about the completeness, accuracy, reliability, of the information or related graphics contained within this report for any purpose.

Any reliance you place on such information is therefore strictly at your own risk. In no event will we be liable for any loss or damage including without limitation, indirect or consequential loss or damage, or any loss or damage whatsoever arising from loss of data or profits arising out of, or in connection with, the use of this report.

6 Mannamead Road Plymouth Devon PL4
7AA
01752 256000
property@langtownandcountry.com
www.langtownandcountry.com

