



14 Fore Street, St Maurice, Plympton, Plymouth, Devon, PL7 1NA



**Price £250,000**



Mid-terrace period residence within a popular conservation area. The accommodation, complete with gas central heating, comprises 2 double bedrooms, lounge/diner, kitchen, bathroom and a separate w.c. Externally there is a rear courtyard garden and a roof terrace. No chain.

Situated in the popular hamlet of Plympton St. Maurice is this 3-storey mid terrace home. Having undergone an extensive programme of refurbishment the property is being sold with vacant possession and no onward chain.

The property comprises; entrance hall with stairs rising to the first floor and access to the ground floor accommodation. There is a generous size lounge/diner with feature fireplaces, modern fitted kitchen/breakfast room with doors leading onto the enclosed private rear garden and a downstairs cloakroom.

On the first floor there are 2 bedrooms and a modern 3-piece bathroom suite and stairs that rise to the second floor there is another bedroom.

To the rear of the property there is an enclosed private rear garden perfect for entertaining.

Plympton St Maurice is a historic semi-rural village situated on the southern fringe of Plymouth. It is the birthplace of sir Joshua Reynolds and Plympton Castle was one of the last royal strongholds during the civil war. The village remains unspoilt with areas of expansive countryside surrounding it. There is easy access to Plymouth, the A38 and the surrounding South Hams countryside and coastline.



To view this property call Lang Town & Country Estate Agents on **01752 456000**.





GROUND FLOOR  
430 sq.ft. (40.0 sq.m.) approx.

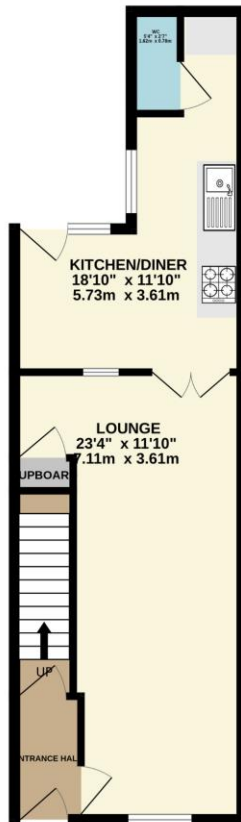

1ST FLOOR  
276 sq.ft. (25.7 sq.m.) approx.

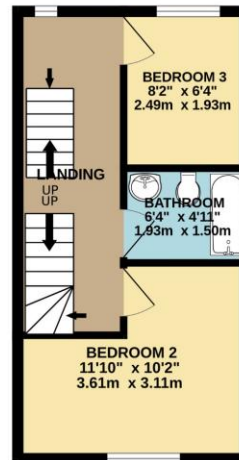

2ND FLOOR  
185 sq.ft. (17.2 sq.m.) approx.

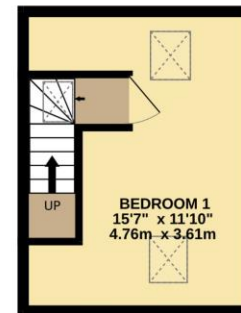

TOTAL FLOOR AREA: 892 sq.ft. (82.8 sq.m.) approx.  
Measurements are approximate. Not to scale. Illustrative purposes only.  
Made with Metropix ©2023



Lang Town & Country  
6 The Broadway  
Plymstock  
Plymouth  
PL9 7AU

Tel: 01752 456000

Email: [plymstock@langtownandcountry.com](mailto:plymstock@langtownandcountry.com)

[www.langtownandcountry.com](http://www.langtownandcountry.com)

Lang Town & Country endeavour to ensure the accuracy of property details produced and displayed, we have not tested any apparatus, equipment, fixtures, fittings or services and so cannot verify that they are connected, in working order or fit for purpose. A buyer must check the availability of any property and make an appointment to view before embarking on any journey to see a property.

