



19 Endsleigh Road, Oreston, Plymouth, Devon, PL9 7LT



Price £310,000

This fabulous three-storey, three-bedroom townhouse offers picturesque views over Oreston Quay. The accommodation is arranged over three floors, providing ample living space suitable for families or individuals seeking a spacious home. The property's elevated position allows for scenic views of Oreston Quay and The Cattewater enhancing its appeal.

On the ground floor there is an entrance porch leading through to the entrance hall. There is the third bedroom that could be used as a study and access to the rear garden and stairs rising to the first floor.

On the first floor there is an open plan living area with a modern fitted kitchen with a range of integrated appliances, spacious living area where you have the fantastic views on offer and a door leading to the balcony. There is also a recently fitted WC with vanity unit wash hand basin and WC.

On the second floor there are two bedrooms and a modern family bathroom. The master bedroom is particularly spacious and enjoys the spectacular views on offer.

To the front of the property there is a double driveway that provides parking for 2 cars and access to the garage, whilst to the rear there is a garden with timber decked seating area and gate leading to the rear access.

Oreston is a former fishing village on the Southern banks of the Cattewater. There are an array of amenities and recreational facilities to suit the public. The picturesque coastal location provides moorings for boating enthusiasts and the use of a free public slipway. The village is served by a corner shop "Quay News" and has a well-regarded public house and restaurant "The Kings Arms". Over recent years the local primary school has gained academy status and has been consistently ranked as one of Plymouth's best primary schools.

Transport links provide access to Plymstock and Plymouth city centre. A short distance from the property is the Broadway shopping centre where there are an array of shops and supermarkets.

Agents Note: Some images are of the local parkland & slipway.

To view this property call Lang Town & Country Estate Agents on **01752 456000**.

www.langtownandcountry.com





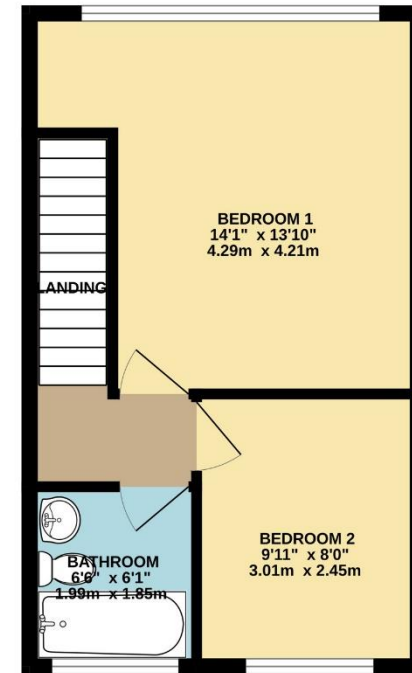
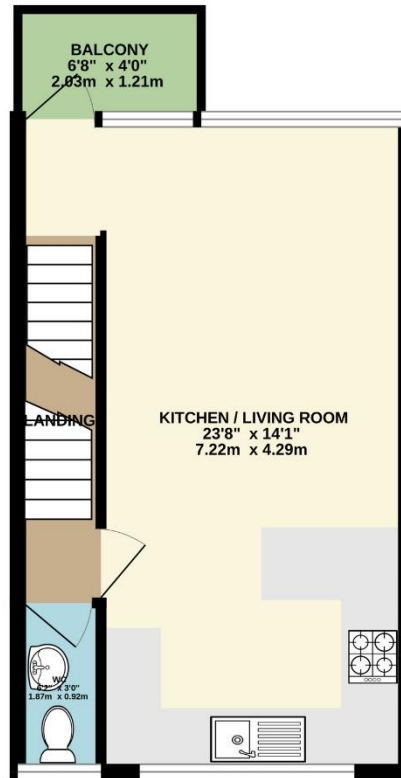
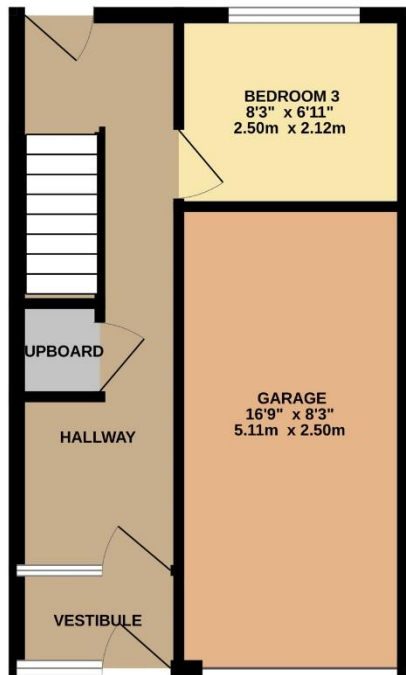

TOTAL FLOOR AREA : 1001 sq.ft. (93.0 sq.m.) approx.
Measurements are approximate. Not to scale. Illustrative purposes only
Made with Metropix ©2024



Lang Town & Country

6 The Broadway

Plymstock

Plymouth

PL9 7AU

Tel: 01752 456000

Email: plymstockoffice@langtownandcountry.com

Lang Town & Country endeavour to ensure the accuracy of property details produced and displayed, we have not tested any apparatus, equipment, fixtures, fittings or services and so cannot verify that they are connected, in working order or fit for purpose. A buyer must check the availability of any property and make an appointment to view before embarking on any journey to see a property.

