



14 Ronsdale Close, Pomphlett, Plymouth, Devon, PL9 7QZ



£240,000



Nestled within a peaceful residential area, this terraced three bedroom house offers a perfect blend of modern comfort and traditional charm. Boasting three bedrooms and a host of desirable features, this property is sure to captivate discerning homebuyers seeking a cosy yet spacious home.

Upon entering you are greeted by a spacious porch leading to a downstairs shower room. There is a family kitchen/diner room, providing a space perfect for family living. There is a good size lounge ideal for relaxation or entertaining guests. The utility room offers convenience and practicality and leads onto the garden. On the first floor there are three bedrooms and a family bathroom. To the front of the property there is driveway parking.

This property is close to an array of local amenities including the Broadway Shopping Centre, Doctor's Surgeries and Dental Surgeries. Recreational facilities can be found close by to include the Mount Batten Water Sports Centre, Staddon Heights Golf Course and the picturesque countryside and coastlines found at the South Hams which offers stunning walks along the Southwest coastal path. Transport links provide access to the vibrant Plymouth City Centre and the South Hams.



To view this property call Lang Town & Country Estate Agents on **01752 456000**.



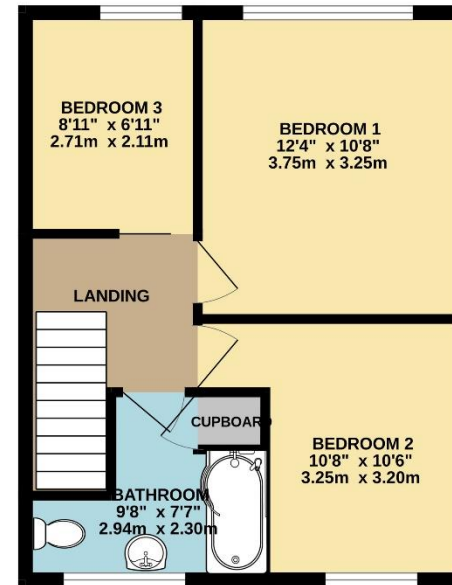
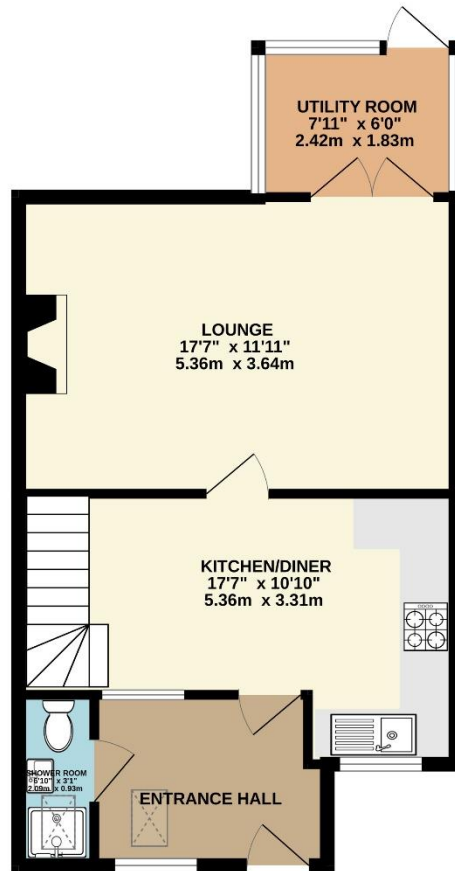

TOTAL FLOOR AREA : 900 sq.ft. (83.7 sq.m.) approx.
Measurements are approximate. Not to scale. Illustrative purposes only
Made with Metropix ©2024



Lang Town & Country
6 The Broadway
Plymstock
Plymouth
PL9 7AU

Tel: 01752 456000

Email: plymstock@langtownandcountry.com

www.langtownandcountry.com

Lang Town & Country endeavour to ensure the accuracy of property details produced and displayed, we have not tested any apparatus, equipment, fixtures, fittings or services and so cannot verify that they are connected, in working order or fit for purpose. A buyer must check the availability of any property and make an appointment to view before embarking on any journey to see a property.

