



Houston Place
ESHER, KT10

CHK
MOUNTFORD
Proud member of the John D Wood & Co. Family

Houston Place

ESHER, KT10



A very well presented four bedroom detached family home within a small development in a private cul-de-sac. Ideally located within walking distance to Esher's mainline station with its fast and frequent service to London (Waterloo).

Four bedrooms
Two bathrooms
Garage and driveway





£4,500.00 pcm (£1,038.46 pw)
 Subject to contract

Local Authority: Elmbridge
 Furnishing: Unfurnished
 Council Tax Band: G
 Availability: August 2024
 Reference: HO8109

Approximate Gross Internal Area:
 2010 sq,ft

Energy Efficiency Rating		
	Current	Potential
Very energy efficient - lower running costs		
(92-100) A		
(81-91) B		
(69-80) C		72
(55-68) D	53	
(39-54) E		
(21-38) F		
(1-20) G		
Not energy efficient - higher running costs		
EU Directive 2002/91/EC		

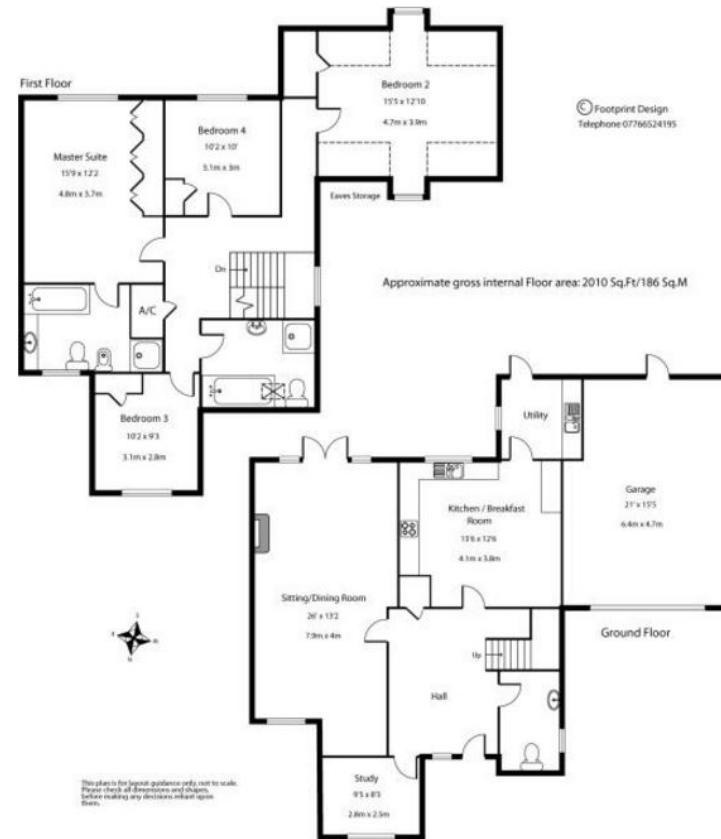

CHK001_5633363_1262081_JDW022

01372 390056
 53 High Street, KT10 9RQ

chkmountford.co.uk

CHK Mountford give notice to anyone reading these particulars that: i) this material is protected by the laws of copyright. The owner of the copyright is John D Wood & Co. This property sheet forms part of our database, and is protected by the database rights and copyrights laws. No unauthorised copying or distribution without permission; ii) the particulars do not constitute part of an offer or contract; iii) the particulars including text, photographs and plans are for the guidance only of prospective purchasers and must not be relied upon as statements of fact; iv) the descriptions provided therein represent the opinion of the author and whilst given in good faith should not be construed as statements of fact; v) nothing in these particulars shall be deemed a statement that the property is in good condition or otherwise nor that any services or facilities are in good working order; vi) all measurements are approximate. April 2017.

CHK
 MOUNTFORD

Proud member of the John D Wood & Co. Family