



Birds Hill Drive  
OXSHOTT, KT22

**CHK**  
MOUNTFORD  
Proud member of the John D Wood & Co. Family

# Birds Hill Drive

OXSHOTT, KT22



Situated within the Exclusive Crown Estate in Oxshott, a beautiful five-bedroom detached family home. Entered via private secure gates via a long 80ft driveway and is surrounded by wonderful lawned mature gardens and has an outdoor heated swimming pool.

**Five bedrooms**  
**Detached Home office/Gym**  
**Exclusive Crown Estate**





£10,000 pcm (£2,307.69 pw)

Subject to contract

Local Authority: Elmbridge

Furnishing: Unfurnished

Council Tax Band: H

Availability: May 2024

Reference: FR8075

Approximate Gross Internal Area:  
5167 sq.ft.

Energy Efficiency Rating		Current	Potential
Very energy efficient - lower running costs			
(92-100) <b>A</b>			
(81-91) <b>B</b>			
(69-80) <b>C</b>			
(55-68) <b>D</b>		64	72
(39-54) <b>E</b>			
(21-38) <b>F</b>			
(1-20) <b>G</b>			
Not energy efficient - higher running costs			
EU Directive 2002/91/EC			

### Birds Hill

Gross internal area (approx.)  
Total = 480 sq.m (5167 sq.ft)  
Main House = 375 sq.m (4037 sq.ft)  
Garage = 52 sq.m (565 sq.ft)  
Pool House & Office Chalet = 52 sq.m (565 sq.ft)

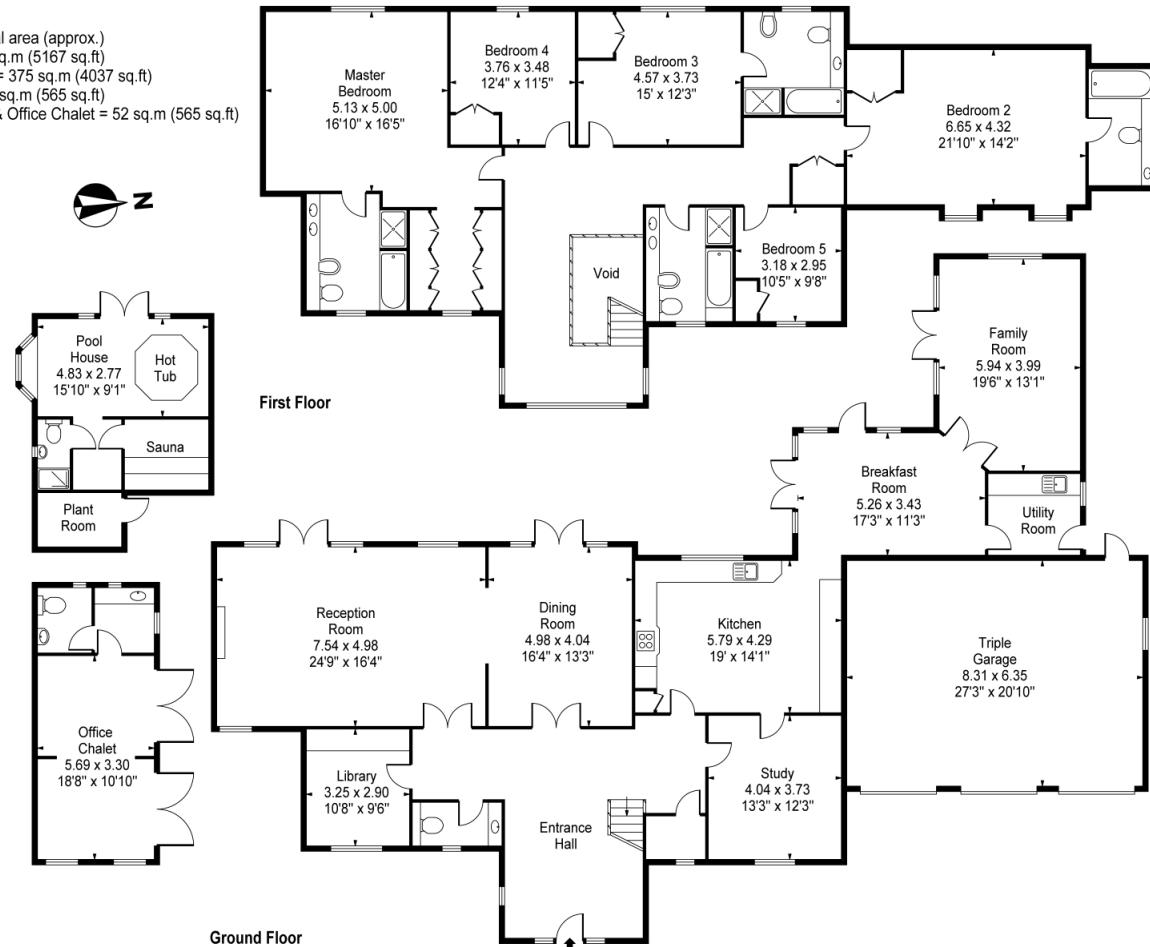

01372 390056  
53 High Street, KT10 9RQ

chkmountford.co.uk

CHK Mountford give notice to anyone reading these particulars that: i) this material is protected by the laws of copyright. The owner of the copyright is John D Wood & Co. This property sheet forms part of our database, and is protected by the database rights and copyrights laws. No unauthorised copying or distribution without permission; ii) the particulars do not constitute part of an offer or contract; iii) the particulars including text, photographs and plans are for the guidance only of prospective purchasers and must not be relied upon as statements of fact; iv) the descriptions provided therein represent the opinion of the author and whilst given in good faith should not be construed as statements of fact; v) nothing in these particulars shall be deemed a statement that the property is in good condition or otherwise nor that any services or facilities are in good working order; vi) all measurements are approximate. April 2017.

**CHK**  
MOUNTFORD

Proud member of the John D Wood & Co. Family