



Woodman Close

Morpeth

- Semi Detached Home
- Five Bedrooms
- Quiet Cul-de-sac
- No Onward Chain
- Enclosed Rear Garden
- Garage and Driveway

Offers In Excess Of £310,000

01670 511 711
morpeth@rmsestateagents.co.uk

ROOK
MATTHEWS
SAYER

www.rookmatthewssayer.co.uk
morpeth@rmsestateagents.co.uk

Woodman Close Morpeth

Are you looking to put your own stamp on your new forever home? We have a fantastic opportunity to purchase this spacious five bedroomed family home, located on Woodman Close. Sitting at the end of a quiet cul-de-sac, this property will be a real hit with families. This area is hugely attractive to house hunters, not only due to being walking distance to the local first school, but Morpeth town centre is a short trip away where you have an array of local bars, restaurants and river walks all on your doorstep.

The property briefly comprises:- Entrance hallway, impressive lounge with floods of natural light due to the large window overlooking the front driveway. The lounge has been fitted with grey carpets and decorated with neutral colours. The kitchen has been fitted with a range of light wood wall and base units, offering an abundance of storage. Integrated appliances include an electric oven, electric hob and microwave. This leads seamlessly through to a separate dining area which is a great space for families with plenty room for your dining table and chairs. You further benefit from a separate utility space which leads out to the rear garden. In addition, there is a downstairs bathroom, fitted with W.C., hand basin and shower.

To the upper floor of the accommodation, you have five good size bedrooms, four doubles and one single, all of which have been carpeted throughout and offer excellent storage. The family bathroom has been fully tiled and includes fitted hand basin, bath tub and shower over bath. The W.C. is located next to the main bathroom.

Externally to the front you have a large grassed garden with a single garage and driveway that can accommodate several cars, making it ideal for a growing family. To the rear of the property, you have an easy to maintain enclosed rear garden.

With no onward chain, we anticipate a vast amount of interest. Please call us now to arrange your viewing.

Lounge: 21.4 x 16.2 Max Points	(6.50m x 4.93m Max Points)
Kitchen: 9.7 x 18.8	(2.92m x 5.69m)
Dining Room: 11.1 x 15.1	(3.38m x 4.59m)
Downstairs Bathroom: 6.6 x 4.2	(1.98m x 1.28m)
Utility Room: 11.7 x 4.2	(3.53m x 1.28m)
Bedroom One: 9.4 x 16.8	(2.84m x 5.08m)
Bedroom Two: 16.6 x 11.5 Max Points	(5.03m x 3.48m Max Points)
Bedroom Three: 11.0 x 13.4	(3.35m x 4.06m)
Bedroom Four: 10.5 x 11.1	(3.18m x 3.38m)
Bedroom Five: 6.8 x 10.5	(2.03m x 3.18m)
Bathroom: 8.0 x 5.5 Max Points	(2.44m x 1.65m Max Points)
W.C.: 2.4 x 5.0	(0.73m x 1.52m)

PRIMARY SERVICES SUPPLY

Electricity: Mains

Water: Mains

Sewerage: Mains

Heating: Mains gas

Broadband: Fibre to Premises

Mobile Signal / Coverage Blackspot: No

Parking: Garage and Driveway

TENURE

Freehold; It is understood that this property is freehold, but should you decide to proceed with the purchase of this property, the Tenure must be verified by your Legal Adviser

EPC Rating: B

Council Tax Band: D

Agents Note: It is our understanding that the property is not registered at the Land Registry which is the case with a significant proportion of land across England and Wales. Your conveyancer will take the necessary steps and advise you accordingly.

M00008270.LB.JD.03/02/2025.V.3

Important Note: Rook Matthews Sayer (RMS) for themselves and for the vendors or lessors of this property, whose agents they are, give notice that these particulars are produced in good faith, are set out as a general guide only and do not constitute part or all of an offer or contract. The measurements indicated are supplied for guidance only and as such must be considered incorrect. Potential buyers are advised to recheck the measurements before committing to any expense. RMS has not tested any apparatus, equipment, fixtures, fittings or services and it is the buyer's interests to check the working condition of any appliances. RMS has not sought to verify the legal title of the property and the buyers must obtain verification from their solicitor. No persons in the employment of RMS has any authority to make or give any representation or warranty whatever in relation to this property.

Money Laundering Regulations – intending purchasers will be asked to produce original identification documentation at a later stage and we would ask for your co-operation in order that there will be no delay in agreeing the sale. We will also use some of your personal data to carry out electronic identity verification. This is not a credit check and will not affect your credit score.

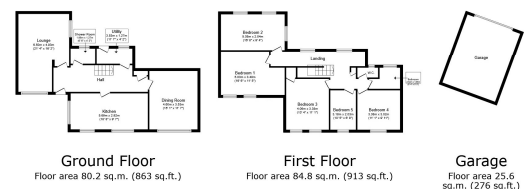

TOTAL: 190.6 sq.m. (2,051 sq.ft.)

This floor plan is for illustrative purposes only. It is not drawn to scale. Any measurements, floor areas (including any total floor area), openings and orientations are approximate. No details are guaranteed. Any errors do not affect the sale process and do not form any part of any agreement. No liability is taken for any errors, omissions or misstatements. A party must rely upon its own inspection(s). Referred to as: PropertyPlan.co.uk

Score	Energy rating	Current	Potential
92+	A		
81-91	B	83 B	83 B
69-80	C		
55-68	D		
39-54	E		
21-38	F		
1-20	G		

16 Branches across the North-East

