



Abbey Court

Hexham

- Retirement Apartment
- One Bedroom
- Secure Entry System
- Overlooking the Gardens
- Spacious Shower
- Central Hexham Location

Offers in the Region of **£90,000**

01434 601616
46 Priestpopple, Hexham, NE46 1PQ

ROOK
MATTHEWS
SAYER

www.rookmatthewssayer.co.uk
hexham@rmsestateagents.co.uk

Abbey Court, Hexham

PROPERTY DESCRIPTION

Retirement apartment on the South side the very popular Abbey Court development in central Hexham, just off the main street, overlooking the gardens.

The apartment is situated at the end of the communal hallway with minimal foot traffic passing the door.

The apartment is entered from the communal hallway into the private central hallway which gives access to the lounge, bedroom and bathroom.

The lounge is a spacious room with large picture window overlooking the well-kempt communal gardens. The afternoon sun floods this room with warm light and creates a pleasant space to watch the day go by. A good size storage cupboard is found off the lounge.

The kitchen is off the lounge and well lit, offering a nice space with plenty of base and wall cupboards as well as fitted oven with hob, sink and drainer unit and space for fridge/freezer beneath the countertops.

From the central hallway, the door to the shower room can be found. This room is fitted with WC, hand wash basin and large shower cubicle, ideal for those who require plenty of space to get washed.

Abbey Court offers plenty of communal facilities to make retired life as easy as possible and ensure that residents have ample opportunity to socialise if they so wish. The communal lounge of the ground floor is the perfect place to have a natter over a coffee or maybe even a game of dominoes.

The development also offers a residents only car park.

The position of Abbey Court is paramount, being just off the main street, residents can wander along into town at their leisure or take advantage of the convenient taxi services offered in Hexham for door-to-door service.

INTERNAL DIMENSIONS

Lounge: 14'4 x 11'8 (4.37m x 3.56m)

Kitchen: 7'4 x 5'11 (2.24m x 1.80m)

Bedroom: 17'8 into robes x 8'5 (5.38m x 2.57m)

Shower Room: 6'8 x 5'11 (2.03m x 1.80m)

PRIMARY SERVICES SUPPLY

Electricity: Mains

Water: Mains

Sewerage: Mains

Heating: Electric

Broadband: Fibre To Cabinet

Mobile Signal / Coverage Blackspot: No

Parking: Communal Car Park

MINING

The property is not known to be on a coalfield and not known to be directly impacted by the effect of other mining activity. The North East region is famous for its rich mining heritage and confirmation should be sought from a conveyancer as to its effect on the property, if any.

ACCESSIBILITY

This property has accessibility adaptations:

- Ramp access to main door
- Lift access to all floors

TENURE

Leasehold. It is understood that this property is leasehold.

Should you decide to proceed with the purchase of this property, the Tenure and associated details and costs must be verified by your Legal Advisor before you expend costs.

Length of Lease: 125 years from July 1988

Ground Rent: TBC

Service Charge: TBC

Any Other Charges/Obligations: TBC

COUNCIL TAX BAND: B

EPC RATING: C

HX00006514.BJ.MR.09.04.2025.V.1.1

Important Note: Rook Matthews Sayer (RMS) for themselves and for the vendors or lessors of this property, whose agents they are, give notice that these particulars are produced in good faith, are set out as a general guide only and do not constitute part or all of an offer or contract. The measurements indicated are supplied for guidance only and as such must be considered incorrect. Potential buyers are advised to recheck the measurements before committing to any expense. RMS has not tested any apparatus, equipment, fixtures, fittings or services and it is the buyer's interests to check the working condition of any appliances. RMS has not sought to verify the legal title of the property and the buyers must obtain verification from their solicitor. No persons in the employment of RMS has any authority to make or give any representation or warranty whatever in relation to this property.

Money Laundering Regulations – intending purchasers will be asked to produce original identification documentation at a later stage and we would ask for your co-operation in order that there will be no delay in agreeing the sale. We will also use some of your personal data to carry out electronic identity verification. This is not a credit check and will not affect your credit score.

16 Branches across the North-East



Abbey Court, Hexham

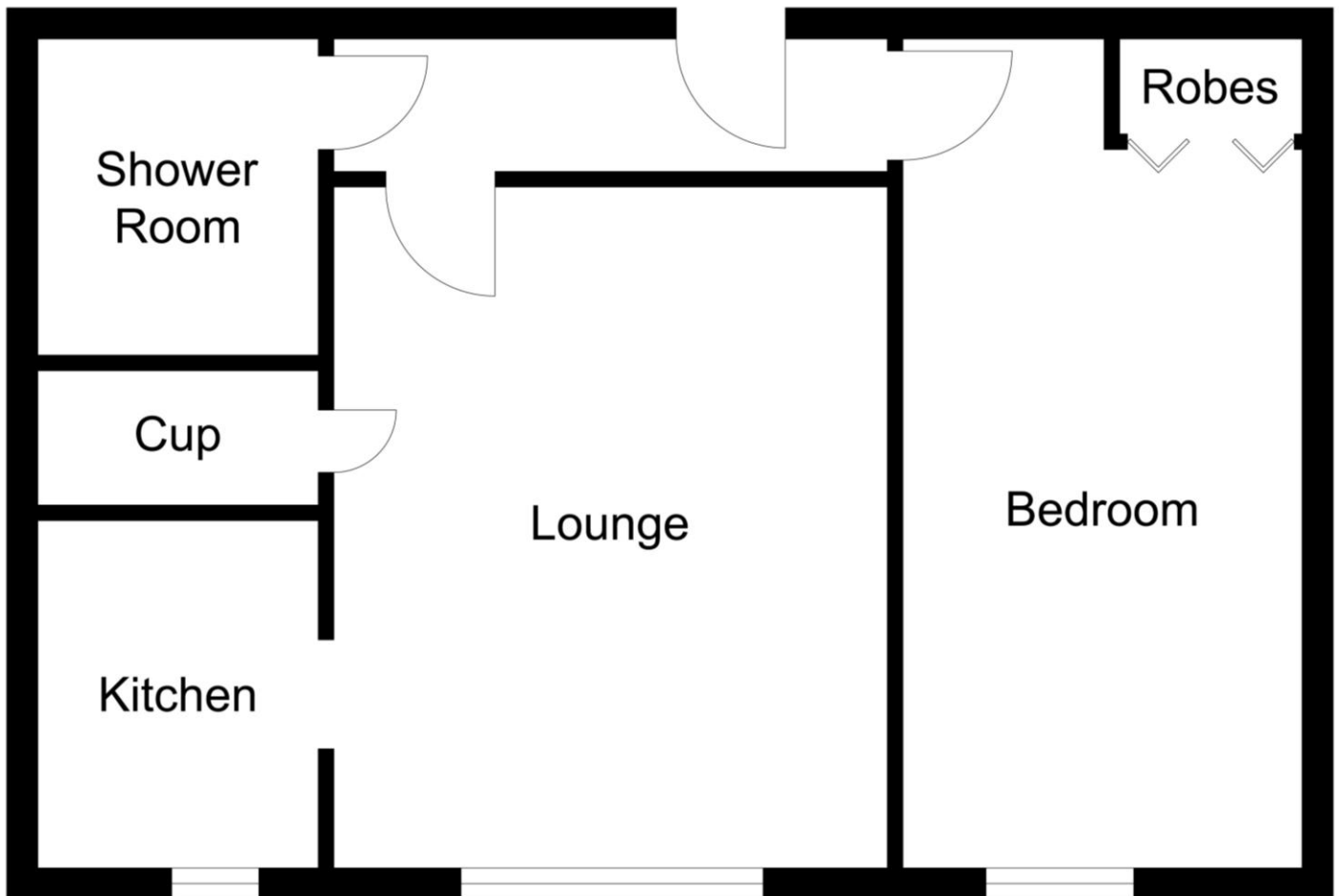

Important Note: Rook Matthews Sayer (RMS) for themselves and for the vendors or lessors of this property, whose agents they are, give notice that these particulars are produced in good faith, are set out as a general guide only and do not constitute part or all of an offer or contract. The measurements indicated are supplied for guidance only and as such must be considered incorrect. Potential buyers are advised to recheck the measurements before committing to any expense. RMS has not tested any apparatus, equipment, fixtures, fittings or services and it is the buyer's interests to check the working condition of any appliances. RMS has not sought to verify the legal title of the property and the buyers must obtain verification from their solicitor. No persons in the employment of RMS has any authority to make or give any representation or warranty whatever in relation to this property.

Money Laundering Regulations – intending purchasers will be asked to produce original identification documentation at a later stage and we would ask for your co-operation in order that there will be no delay in agreeing the sale. We will also use some of your personal data to carry out electronic identity verification. This is not a credit check and will not affect your credit score.

16 Branches across the North-East

