



Mount View Terrace Stocksfield

- Stone Mid Terrace
- Two Double Bedrooms
- Detached Garage
- Stone Outbuilding
- Generous Garden
- In Need of Some Modernisation

Guide Price: **£ 195,000**

01434 601616
46 Priestpopple, Hexham, NE46 1PQ

ROOK
MATTHEWS
SAYER

www.rookmatthewssayer.co.uk
hexham@rmsestateagents.co.uk

Mount View Terrace, Stocksfield

PROPERTY DESCRIPTION

Presented is a proud standing stone built mid terrace two bedroom family home offering high ceilings throughout, character features, beautiful garden, a timber garage and stone outbuilding. The property is in need of some modernisation and priced to sell, so we would advise early inspection to avoid disappointment.

The traditional front door brings you into a convenient entrance vestibule off the main lounge, perfect for cloaks and boots. The lounge is to the front elevation with doors to dining room and staircase to first floor. The dining room benefits from a large understair storage cupboard and gives access to the kitchen at the rear of the property which overlooks the rear yard and stone outbuilding.

The glass door at the back of the lounge leads us to the stairwell, leading up onto spacious landing which gives access to the family bathroom situated at the rear as well as the two double bedrooms, the larger of which offers fitted cupboards and feature fireplace.

Externally, to the front of the property, is a low maintenance hard standing area with centrally planted feature hydrangea. At the rear of the property is a private yard giving access to a stone outbuilding. Across the rear lane is a detached timber garage and gardens beyond with ample space for lawns, flower beds, shrubs, seating areas, vegetable plots and garden shed.

The property is ideally situated for those looking to commute into Newcastle, Hexham or even Carlisle, with walking access to the East-West train line as well as bus route and road links. Being within walking distance of a local shop, first school and sports facilities is an added bonus. Hexham to the West and Prudhoe to the East covers all grocery shopping and healthcare options.

INTERNAL DIMENSIONS

Lounge: (L-shaped) 14'3 max x 14'11 (4.34m x 4.55m)

Dining Room: 10'5 x 9'9 (3.18m x 2.97m)

Kitchen: 9'5 x 7'1 (2.87m x 2.16m)

Bathroom: 9'7 x 7'0 (2.92m x 2.13m)

Bedroom 1: 14'5 x 14'3 (4.39m x 4.34m)

Bedroom 2: 11'0 x 7'1 (3.35m x 2.16m)

PRIMARY SERVICES SUPPLY

Electricity: Mains

Water: Mains

Sewerage: Mains

Heating: Gas

Broadband: Fibre to cabinet

Mobile Signal / Coverage Blackspot: No

Parking: Garage

MINING

The property is not known to be on a coalfield and not known to be directly impacted by the effect of other mining activity. The North East region is famous for its rich mining heritage and confirmation should be sought from a conveyancer as to its effect on the property, if any.

AGENTS NOTE

It is our understanding that the Property is not registered at the Land Registry which is the case with a significant proportion of land across England and Wales. Your Conveyancer will take the necessary steps and advise you accordingly.

TENURE

Freehold – It is understood that this property is freehold, but should you decide to proceed with the purchase of this property, the Tenure must be verified by your Legal Adviser

COUNCIL TAX BAND: C

EPC RATING: TBC

HX00005985.JR.JR.28.6.24.V.4

Important Note: Rook Matthews Sayer (RMS) for themselves and for the vendors or lessors of this property, whose agents they are, give notice that these particulars are produced in good faith, are set out as a general guide only and do not constitute part or all of an offer or contract. The measurements indicated are supplied for guidance only and as such must be considered incorrect. Potential buyers are advised to recheck the measurements before committing to any expense. RMS has not tested any apparatus, equipment, fixtures, fittings or services and it is the buyer's interests to check the working condition of any appliances. RMS has not sought to verify the legal title of the property and the buyers must obtain verification from their solicitor. No persons in the employment of RMS has any authority to make or give any representation or warranty whatever in relation to this property.

Money Laundering Regulations – intending purchasers will be asked to produce original identification documentation at a later stage and we would ask for your co-operation in order that there will be no delay in agreeing the sale. We will also use some of your personal data to carry out electronic identity verification. This is not a credit check and will not affect your credit score.

16 Branches across the North-East



Mount View Terrace, Stocksfield

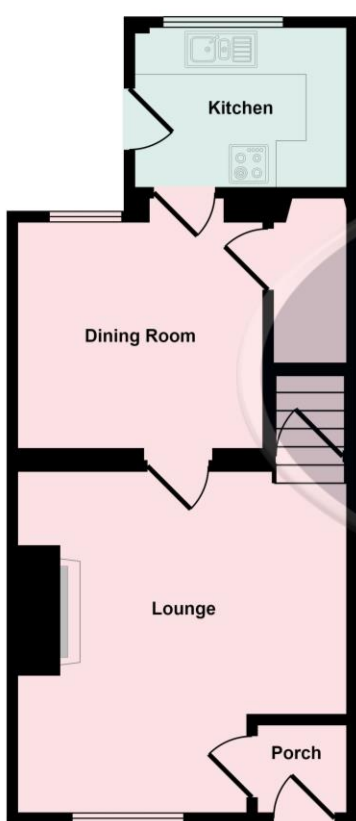

Ground Floor

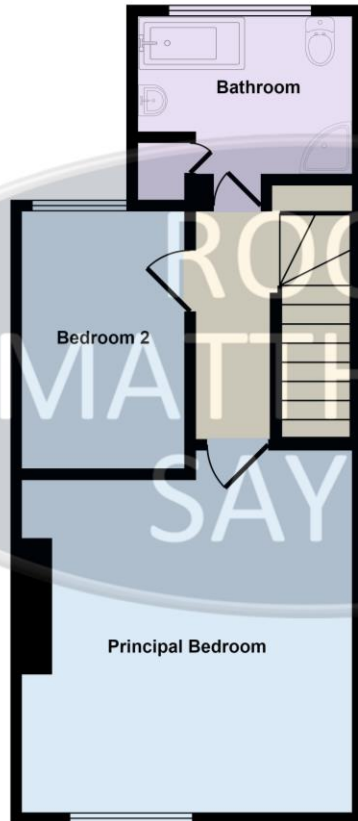

First Floor

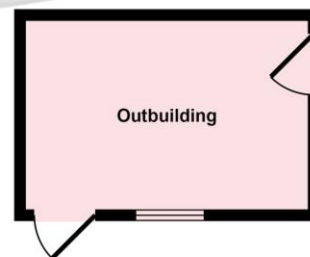

Outbuilding

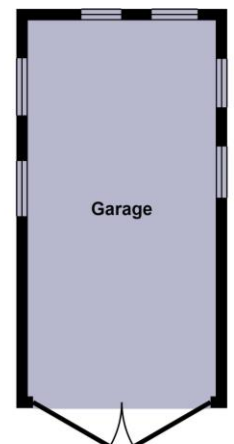

Garage

Important Note: Rook Matthews Sayer (RMS) for themselves and for the vendors or lessors of this property, whose agents they are, give notice that these particulars are produced in good faith, are set out as a general guide only and do not constitute part or all of an offer or contract. The measurements indicated are supplied for guidance only and as such must be considered incorrect. Potential buyers are advised to recheck the measurements before committing to any expense. RMS has not tested any apparatus, equipment, fixtures, fittings or services and it is the buyer's interests to check the working condition of any appliances. RMS has not sought to verify the legal title of the property and the buyers must obtain verification from their solicitor. No persons in the employment of RMS has any authority to make or give any representation or warranty whatever in relation to this property.

Money Laundering Regulations – intending purchasers will be asked to produce original identification documentation at a later stage and we would ask for your co-operation in order that there will be no delay in agreeing the sale. We will also use some of your personal data to carry out electronic identity verification. This is not a credit check and will not affect your credit score.

16 Branches across the North-East

