



The Maltings Rothbury

- Three bedroom end terrace
- Well-presented accommodation
- Downstairs W.C.
- Dining kitchen
- No chain

Guide Price: £ 220,000



01665 510044
3-5 Market Street, Alnwick NE66 1SS

ROOK
MATTHEWS
SAYER

www.rookmatthewssayer.co.uk
alnwick@rmsestateagents.co.uk

14 The Maltings

Rothbury, Morpeth, Northumberland NE65 7TG

Centrally located in the heart of the picturesque market town of Rothbury in Northumberland, this beautifully presented property has been a successful holiday let and main residence, but is now available to buy with no chain. As well as buyers looking for an investment or a bolthole in rural Northumberland, this three bedroom property is sure to appeal to house-hunters in search of a home close to shops and facilities, whilst being able to enjoy having the countryside on the doorstep. Unlike some older terraced properties in Rothbury, this house has its own drive and a private paved courtyard style garden, so you don't have to rely on public space to sit out in the sun or find on-street parking. Being an end link, there is space to the side of the house and a useful area for a storage shed. The land adjacent to the house on the other side of the stone wall boundary is open allotments, and offers a view down towards the river. The lounge at the rear spans the full width of the property and enjoys a sunny southerly aspect with patio doors to the garden, whilst the kitchen at the front has space for a table and chairs and an external door with access to the side of the house. Other features include a downstairs toilet, contemporary shower room, double glazing and gas central heating with radiators. The Maltings is a small development of stone houses and bungalows that offer modern homes that are in keeping with the aesthetics of this delightful rural market town.

HALL

Double glazed entrance door | Radiator | Laminate flooring | Staircase to first floor | Storage cupboard | Doors to kitchen, lounge and W.C.

LOUNGE 17'9 x 11'5 (5.41m x 3.48m)

Double glazed sliding patio door | Double glazed window to rear | Contemporary electric stove | Laminate flooring | Storage cupboard | Coving to ceiling | Radiator

KITCHEN 13'9 x 8'10 min 10'10 max (4.19m x 2.69m min 3.30m max)

Double glazed window to front | Double glazed external door to side | Fitted units | 1½ bowl sink | Space for gas cooker | Space for washing machine | Space for fridge/freezer | Part tiled walls | Laminate flooring | Coving to ceiling | Radiator

DOWNSTAIRS W.C.

Double glazed frosted window to front | Close coupled W.C. | Wash hand basin with cabinet | Tiled splashback | Radiator | Laminate flooring | Coving to ceiling

FIRST FLOOR LANDING

Storage cupboard | Doors to bedrooms and shower room

BEDROOM ONE 17'8 x 8'10 (5.38m x 2.69m)

Two double glazed windows to rear | Radiators | Coving to ceiling

BEDROOM TWO 8'10 x 8'9 (2.69m x 2.67m)

Double glazed window to front | Coving to ceiling | Radiator

BEDROOM THREE 7'8 plus wardrobes x 7'4 (2.33m plus wardrobes x 2.24m)

Double glazed window to side | Fitted wardrobes | Coving to ceiling | Radiator

SHOWER ROOM

Double glazed frosted window to front | Wet walls | Walk-in shower with electric shower and glass screen | Integrated wash hand basin and W.C. | Chrome heated towel rail | Luxury vinyl floor tiles | Extractor fan | Shaver point

EXTERNALLY

Block paved drive to front | Gravelled garden with planting | Side access to rear | Paved rear garden | Fenced and wall boundaries

SERVICES

Mains electricity, gas, water and drainage | Gas central heating

TENURE - FREEHOLD | EPC RATING C | COUNCIL TAX BAND D

AL005608/DM/RJ/21.11.2023/V.1



Important Note: Rook Matthews Sayer (RMS) for themselves and for the vendors or lessors of this property, whose agents they are, give notice that these particulars are produced in good faith, are set out as a general guide only and do not constitute part or all of an offer or contract. The measurements indicated are supplied for guidance only and as such must be considered incorrect. Potential buyers are advised to recheck the measurements before committing to any expense. RMS has not tested any apparatus, equipment, fixtures, fittings or services and it is the buyer's interests to check the working condition of any appliances. RMS has not sought to verify the legal title of the property and the buyers must obtain verification from their solicitor. No persons in the employment of RMS has any authority to make or give any representation or warranty whatever in relation to this property.

Money Laundering Regulations – intending purchasers will be asked to produce original identification documentation at a later stage and we would ask for your co-operation in order that there will be no delay in agreeing the sale. We will also use some of your personal data to carry out electronic identity verification. This is not a credit check and will not affect your credit score.

16 Branches across the North-East



14 The Maltings

Rothbury, Morpeth, Northumberland NE65 7TG

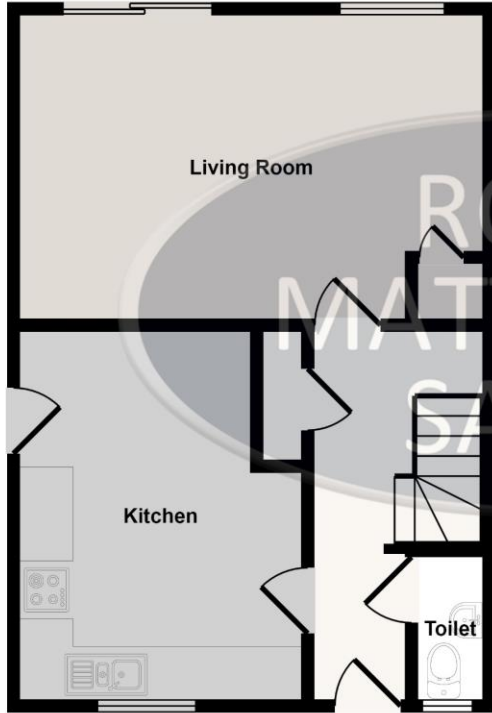

Ground Floor

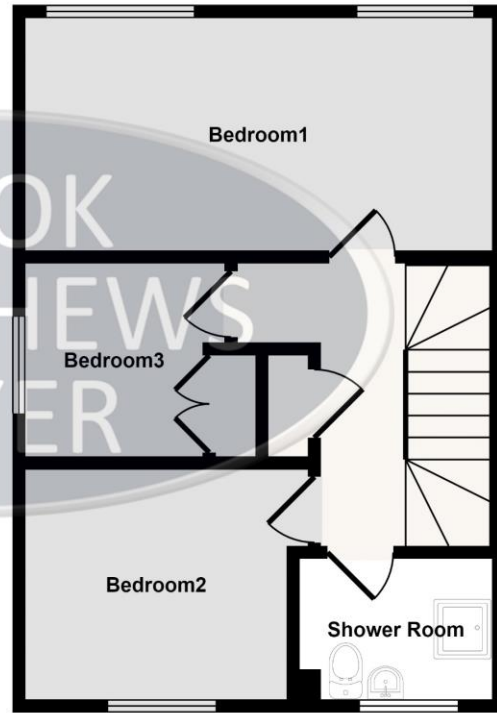

First Floor

This floorplan is only for illustrative purposes and is not to scale. Measurements of rooms, doors, windows, and any items are approximate and no responsibility is taken for any error, omission or mis-statement. Icons of items such as bathroom suites are representations only and may not look like the real items. Made with Made Snappy 360.



Score	Energy rating	Current	Potential
92+	A		
81-91	B		89 B
69-80	C	74 C	
55-68	D		
39-54	E		
21-38	F		
1-20	G		

Important Note: Rook Matthews Sayer (RMS) for themselves and for the vendors or lessors of this property, whose agents they are, give notice that these particulars are produced in good faith, are set out as a general guide only and do not constitute part or all of an offer or contract. The measurements indicated are supplied for guidance only and as such must be considered incorrect. Potential buyers are advised to recheck the measurements before committing to any expense. RMS has not tested any apparatus, equipment, fixtures, fittings or services and it is the buyer's interests to check the working condition of any appliances. RMS has not sought to verify the legal title of the property and the buyers must obtain verification from their solicitor. No persons in the employment of RMS has any authority to make or give any representation or warranty whatever in relation to this property.

Money Laundering Regulations – intending purchasers will be asked to produce original identification documentation at a later stage and we would ask for your co-operation in order that there will be no delay in agreeing the sale. We will also use some of your personal data to carry out electronic identity verification. This is not a credit check and will not affect your credit score.

16 Branches across the North-East

