



46-51
Longfield

Longfield, Harlow, CM18 6LA
£165,000



Longfield, Harlow, CM18 6LA

Offered with no onward chain is this one double bedroom ground floor flat located close to Bush Fair Shops. As you enter there is a large lounge, kitchen with a range of fitted wall and base units, a double bedroom and a bathroom. Outside there is also a communal garden.

Lease Remaining: 120 years. Service Charge: £53 per month. Ground Rent: £10 per year.



GROUND FLOOR
437 sq.ft. (40.6 sq.m.) approx.

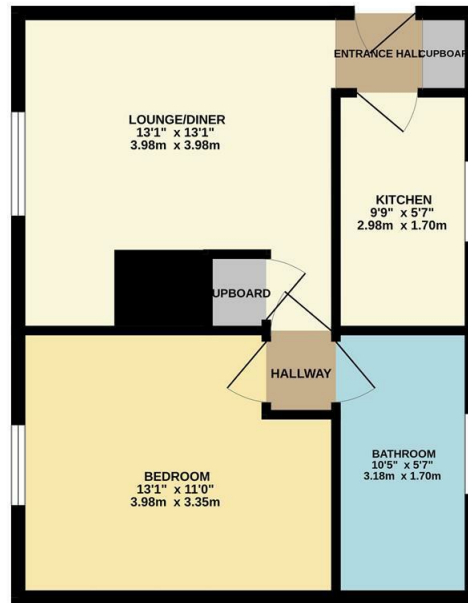

LREYLANDJOHNSON
TOTAL FLOOR AREA: 437 sq.ft. (40.6 sq.m.) approx.
Whilst every attempt has been made to ensure the accuracy of the floorplan contained herein, measurements of doors, windows, rooms and any other details are approximate and no responsibility is taken for any error, omission or mis-statement. This plan is for illustrative purposes only and should be used as such by any prospective purchaser. The services, systems and appliances shown have not been tested and no guarantee as to their operability or efficiency can be given.
Made with Mergen (2024)

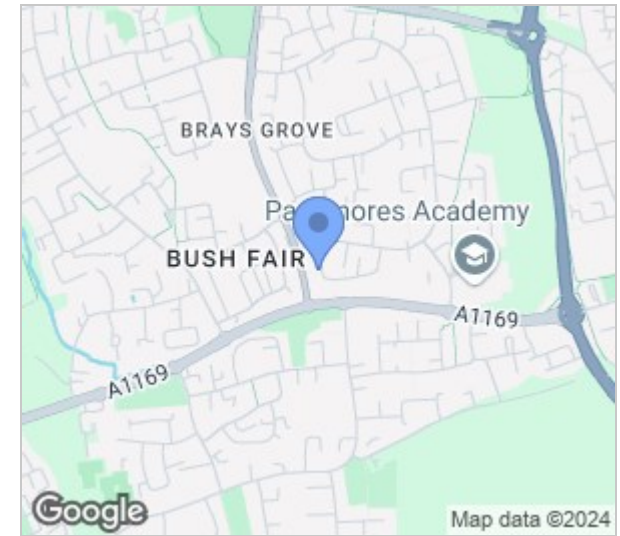

Energy Efficiency Rating		Environmental Impact (CO ₂) Rating	
Current	Potential	Current	Potential
Very energy efficient - lower running costs			
(92 plus) A		Very environmentally friendly - lower CO ₂ emissions	
(81-91) B		(81-91) B	
(69-80) C		(69-80) C	
(55-68) D		(55-68) D	
(39-54) E		(39-54) E	
(21-38) F		(21-38) F	
(1-20) G		(1-20) G	
Not energy efficient - higher running costs		Not environmentally friendly - higher CO ₂ emissions	
England & Wales		England & Wales	
EU Directive 2002/91/EC		EU Directive 2002/91/EC	

These particulars, whilst believed to be accurate are set out as a general outline only for guidance and do not constitute any part of an offer or contract. Intending purchasers should not rely on them as statements of representation of fact, but must satisfy themselves by inspection or otherwise as to their accuracy. No person in this firm's employment has the authority to make or give any representation or warranty in respect of the property.

T. 01279 216216 E. info@rjestateagents.co.uk

1 Acorn Mews, Harlow, Essex, CM18 6NA www.rjestateagents.co.uk