



Halling Hill, Harlow, CM20 3JW  
Offers Over £325,000





# Halling Hill, Harlow, CM20 3JW

A CHAIN-FREE three bedroom terraced house (with potential for off-street parking) in the ever popular Halling Hill. The property benefits from spacious room sizes throughout, a larger than average south-facing garden and is located within walking distance to the town centre, train station and hospital. The ground floor comprises an entrance porch leading to a hallway with a utility/storage room and a fitted kitchen and lounge, both of which offer access to the garden. The first floor offers three generous sized bedrooms, a shower room and separate W/C. This property is offered with no onward chain.

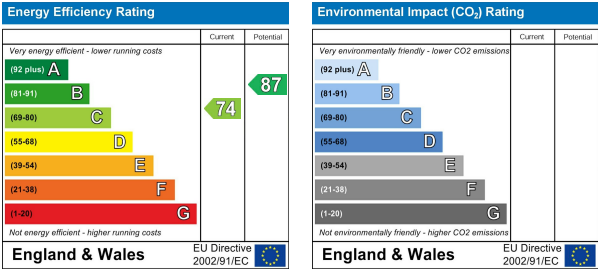
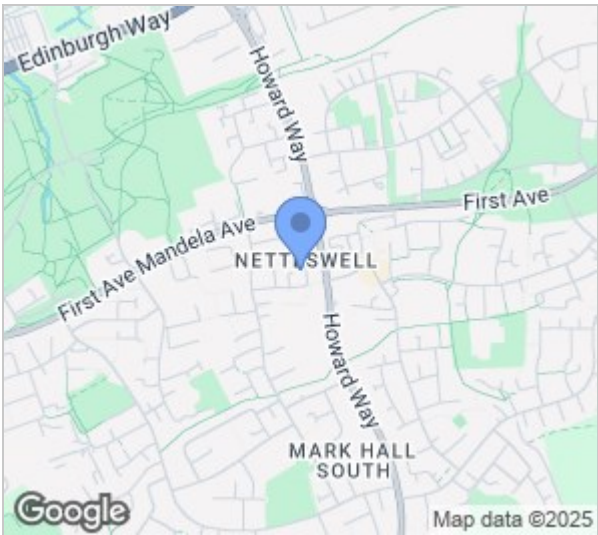
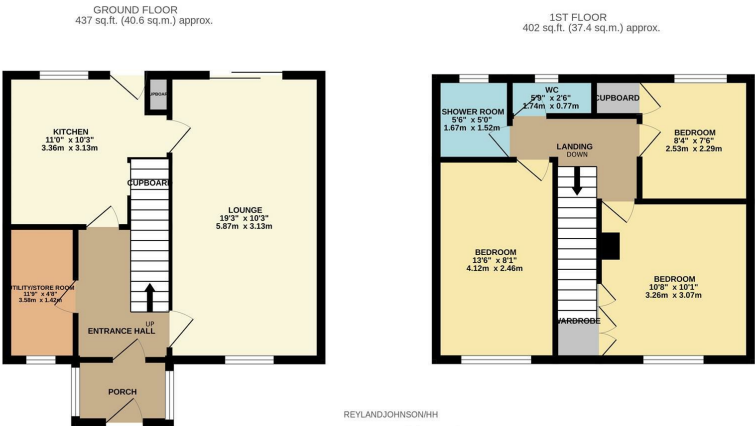

These particulars, whilst believed to be accurate are set out as a general outline only for guidance and do not constitute any part of an offer or contract. Intending purchasers should not rely on them as statements of representation of fact, but must satisfy themselves by inspection or otherwise as to their accuracy. No person in this firms employment has the authority to make or give any representation or warranty in respect of the property.