



Skylark Place, Harlow, CM17 9GU
30% Shared ownership £87,000



Skylark Place, Harlow, CM17 9GU

****30% SHARED OWNERSHIP****

Located in the highly desirable Newhall Development is this well presented two bedroom top floor apartment with allocated parking and a balcony. As you enter there is a large hallway leading to an open plan lounge/diner and kitchen with a range of fitted wall and base units, a balcony, two bedrooms and a beautiful family bathroom with a white three piece suite. Skylark Place is located just off Goldcrest Way, within walking distance of excellent local schools, shops and open fields. Lease Remaining: 114 years. Monthly Rent: £504.21. Service Charge: £191.12.

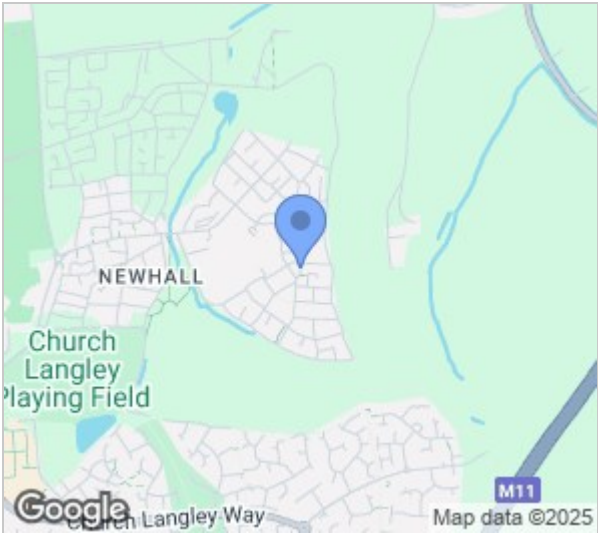
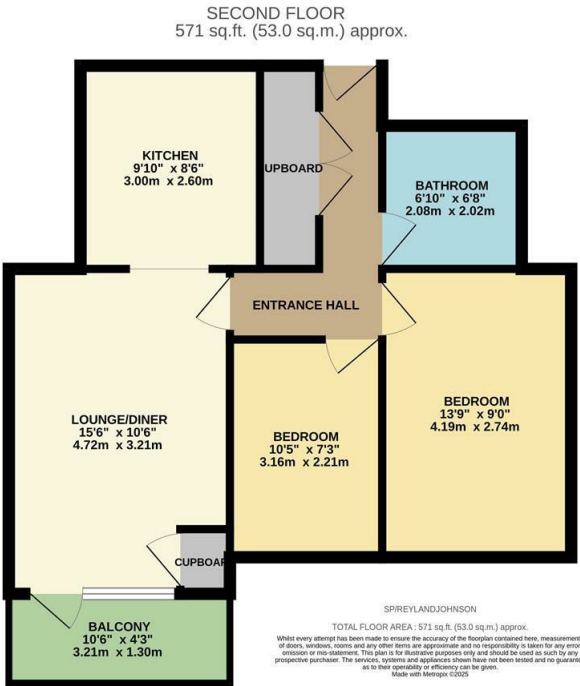

Energy Efficiency Rating			Environmental Impact (CO ₂) Rating		
	Current	Potential		Current	Potential
Very energy efficient - lower running costs			Very environmentally friendly - lower CO ₂ emissions		
(92 plus) A			(92 plus) A		
(81-91) B			(81-91) B		
(69-80) C			(69-80) C		
(55-68) D			(55-68) D		
(39-54) E			(39-54) E		
(21-38) F			(21-38) F		
(1-20) G			(1-20) G		
Not energy efficient - higher running costs			Not environmentally friendly - higher CO ₂ emissions		
England & Wales	EU Directive 2002/91/EC		England & Wales	EU Directive 2002/91/EC	

These particulars, whilst believed to be accurate are set out as a general outline only for guidance and do not constitute any part of an offer or contract. Intending purchasers should not rely on them as statements of representation of fact, but must satisfy themselves by inspection or otherwise as to their accuracy. No person in this firms employment has the authority to make or give any representation or warranty in respect of the property.