



Wedgewood Drive, Church Langley, CM17 9PY  
£1,450 Per Month





# Wedgewood Drive, Church Langley, CM17 9PY

A two bedroom semi detached house with a large corner garden and parking for two cars. The property is immaculately presented and comprises an entrance hall leading to a lounge, dining area, modern kitchen with a range of fitted units and built-in appliances, landing, two double bedrooms and a tiled bathroom. Outside the rear garden is laid to lawn with a decking area and side access. Wedgewood Drive is located off of Lane End and is available EARLY APRIL 2025 on an unfurnished basis.

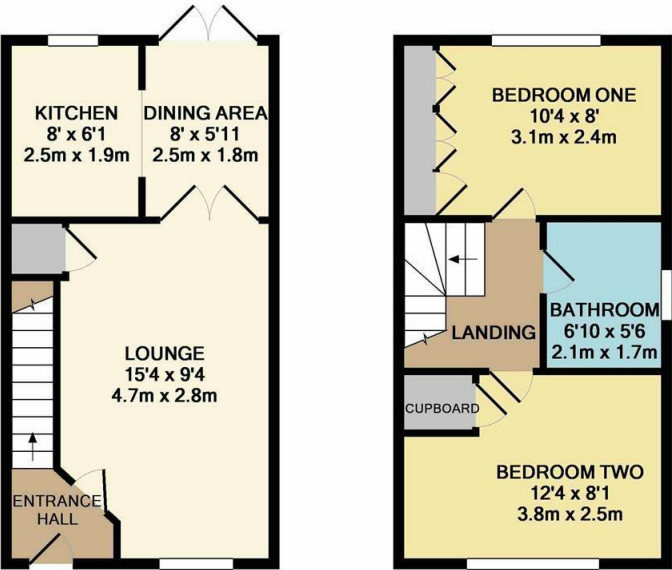

GROUND FLOOR  
APPROX. FLOOR  
AREA 280 SQ.FT.  
(26.0 SQ.M.)

1ST FLOOR  
APPROX. FLOOR  
AREA 280 SQ.FT.  
(26.0 SQ.M.)

297  
TOTAL APPROX. FLOOR AREA 560 SQ.FT. (52.0 SQ.M.)  
Whilst every attempt has been made to ensure the accuracy of the floor plan contained here, measurements of doors, windows, rooms and any other items are approximate and no responsibility is taken for any error, omission, or mis-statement. This plan is for illustrative purposes only and should be used as such by any prospective purchaser. The services, systems and appliances shown have not been tested and no guarantee as to their operability or efficiency can be given  
Made with Metropix ©2015

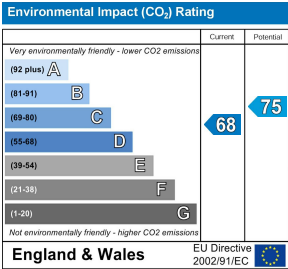
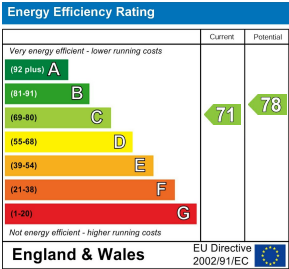
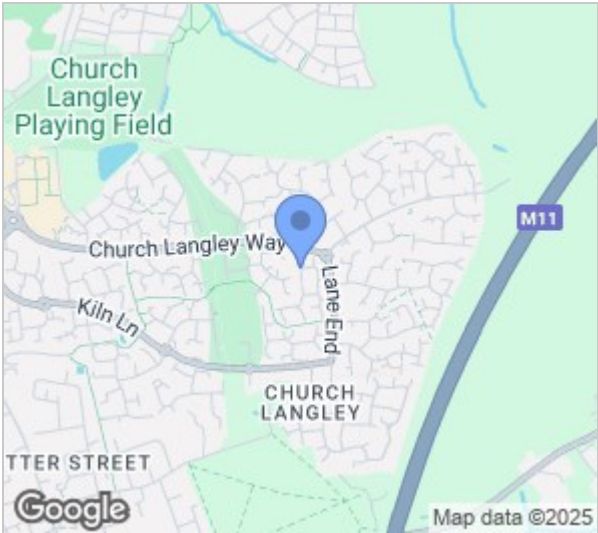

These particulars, whilst believed to be accurate are set out as a general outline only for guidance and do not constitute any part of an offer or contract. Intending purchasers should not rely on them as statements of representation of fact, but must satisfy themselves by inspection or otherwise as to their accuracy. No person in this firms employment has the authority to make or give any representation or warranty in respect of the property.