



Bullfinch Road, Newhall, CM17 9GL
£2,200 Per Month

4 2 1 B

Bullfinch Road, Newhall, CM17 9GL

A well presented four bedroom detached house with garage and driveway. The property comprises an entrance hall with cloakroom/WC, lounge, large kitchen/family room which has a range of fitted wall and base units, the first floor has a family bathroom and four bedrooms with an en-suite shower room and balcony to the main bedroom. Other benefits include a rear garden with patio area. Available NOW on an unfurnished basis.

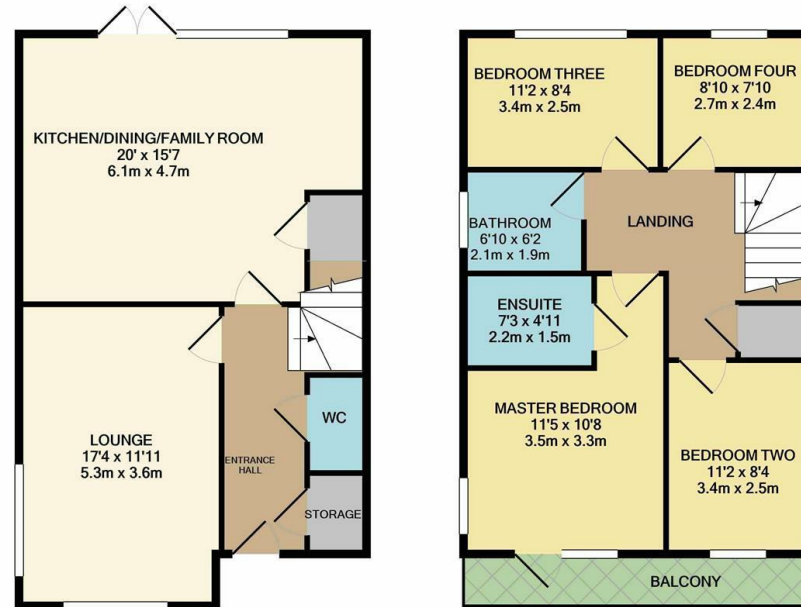

BF/REYLANDJOHNSON
 Whilst every attempt has been made to ensure the accuracy of the floor plan contained here, measurements of doors, windows, rooms and any other items are approximate and no responsibility is taken for any error, omission, or mis-statement. This plan is for illustrative purposes only and should be used as such by any prospective purchaser. The services, systems and appliances shown have not been tested and no guarantee as to their operability or efficiency can be given
 Made with Metropix ©2020



| Energy Efficiency Rating | | Environmental Impact (CO ₂) Rating | |
|--------------------------|-----------|--|-----------|
| Current | Potential | Current | Potential |
| 83 | 92 | 83 | 93 |

England & Wales EU Directive 2002/91/EC

These particulars, whilst believed to be accurate are set out as a general outline only for guidance and do not constitute any part of an offer or contract. Intending purchasers should not rely on them as statements of representation of fact, but must satisfy themselves by inspection or otherwise as to their accuracy. No person in this firm's employment has the authority to make or give any representation or warranty in respect of the property.

T. 01279 216216 E. info@rjestateagents.co.uk

1 Acorn Mews, Harlow, Essex, CM18 6NA www.rjestateagents.co.uk